

**NOTICE!!**

**These documents have been scanned!**

**Do not place un-scanned documents beneath this notice!**

**Do not remove this notice from this file!**

GPO Jacket No. 560-102  
Print Order 61540  
Rise Business Services, LLC  
Job=AZ15 5/16/2019



Box Number= AZ15055



Claim Begin-End: AMC411023-AMC411029

1 Initial Receipt



AZ15055-5

AMC410569-AMC411560

United States Department of the Interior  
Bureau of Land Management  
LANDS/RECREATION & PLANNING  
ONE N CENTRAL AVE  
PHOENIX, AZ 85004 -2203  
Phone: 602-417-9200

Receipt

No: 2437008

<b>Transaction #:</b> 2512663	
<b>Date of Transaction:</b> 09/22/2011	
<b>CUSTOMER:</b>	
<b>SEP 26 2011</b> PAUL KLABACHA 1 LIMESTONE CT LEMONT,IL 60439-2102 US	

LINE #	QTY	DESCRIPTION	REMARKS	UNIT PRICE	TOTAL
1	7.00	LOCATABLE MINERALS / MINING CLAIMS-NEW,UNADJUD, ONE OR MORE AUTH NOS / NEW MINING CLAIM LOCATION FEE \$34 CASES: AMC411023/\$34.00, AMC411024/\$34.00, AMC411025/\$34.00, AMC411026/\$34.00, AMC411027/\$34.00, AMC411028/\$34.00, AMC411029/\$34.00		- n/a -	238.00
2	7.00	LOCATABLE MINERALS / MINING CLAIMS-NEW,UNADJUD, ONE OR MORE AUTH NOS / NEW MINING CLAIM PROCESSING FEE \$15 CASES: AMC411023/\$15.00, AMC411024/\$15.00, AMC411025/\$15.00, AMC411026/\$15.00, AMC411027/\$15.00, AMC411028/\$15.00, AMC411029/\$15.00		- n/a -	105.00
3	7.00	LOCATABLE MINERALS / MINING CLAIMS-NEW,UNADJUD, ONE OR MORE AUTH NOS / NEW MINING CLAIM MAINT FEE \$140 CASES: AMC411023/\$140.00, AMC411024/\$140.00, AMC411025/\$140.00, AMC411026/\$140.00, AMC411027/\$140.00, AMC411028/\$140.00, AMC411029/\$140.00		- n/a -	980.00
<b>TOTAL:</b>					<b>\$1,323.00</b>

PAYMENT INFORMATION			
NOTE: Items will appear on credit card statement as "Bureau of Land Mgmt CO".			
1	AMOUNT:	1323.00	POSTMARKED: N/A
	TYPE:	CREDIT CARD	RECEIVED: 09/22/2011
	NAME:	KLABACHA, PAUL 1 LIMESTONE CT LEMONT IL 60439-2102 US	
	CARD NO:	XXXXXXXXXXXX1003	AUTH CODE: 119683
	NAME ON CARD:	PAUL KLABACHA SILVER STONE LLC	
	EXPIRES:	05/2015	



	SIGNATURE:	
--	------------	--

REMARKS

This receipt was generated by the automated BLM Collections and Billing System and is a paper representation of a portion of the official electronic record contained therein.

**NOTICE!!**

**These documents have been scanned!**

**Do not place un-scanned documents beneath this notice!**

**Do not remove this notice from this file!**

GPO Jacket No. 560-102  
Print Order 61540  
Rise Business Services, LLC  
Job=AZ15 5/16/2019



Box Number= AZ15055



Claim Begin-End: AMC411023-AMC411029

2 Correspondence



AZ15055-5

AMC410569-AMC411560

May 2, 2012

In Reply Refer To:  
3800 (9310) TS  
AMC411023

CERTIFIED MAIL - RETURN RECEIPT REQUESTED No. 7011 2970 0001 8020 6192

NOTICE

PAUL KLABACHA  
1 LIMESTONE CT  
LEMONT, IL 60439-2102

---

AMC411025 - AMC411029  
SILVERSTONE 3 - 7

---

Mining Claim Location Notice(s) – Amendment(s) Required

Pursuant to Title 43 Code of Federal Regulations (CFR) 3832.1, this office received your notices of location for recording mining claims. In accordance with 43 CFR 3832.12, the claims listed above cannot be accepted as filed and must be amended as noted below.

Must file an amendment for AMC411025 – AMC411029 (Silverstone 4 – 7). AMC411025, AMC411026, AMC411028 & AMC411029 must reduce the size of the claims down to 1320' X 600'. You have lode dimensions (600' X 1500'). You can't increase the 600' to 660' because you would be taking in new ground. A typical 20 acre placer claim is 660' X 1320', all placer claims should be described by legal land description unless encumbered by private land or other encumbrance i.e. active unpatented mining claims. AMC411027 must reduce down to 1200' X 660'. In this case the claim is encumbered by a patented mining claim and is therefore ok to have the 1200'. All of the claims listed must have the dimensions in feet on the maps.

You must file an amendment for each claim listed above to correct the defects identified. There is a \$10 BLM processing fee for each amendment. We must receive the amendments within 30 days of your receipt of this notice. If the amendments are not received within the 30 day timeframe the mining claims will be declared null and void.

*Amendment filed 5/21/2012  
Corrected problem.  
TS*



**SENDER: COMPLETE THIS SECTION**

- Complete items 1, 2, and 3. Also complete item 4 if Restricted Delivery is desired.
- Print your name and address on the reverse so that we can return the card to you.
- Attach this card to the back of the mailpiece, or on the front if space permits.

1. Article Addressed to:

PAUL KLABACHA  
1 LIMESTONE CT  
LEMONT, IL 60439-2102  
9310 TS AMC411023

2. Article Number  
(Transfer from service label)

7011 2970 0001 8020 6192

**COMPLETE THIS SECTION ON DELIVERY**

A. Signature

X

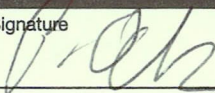

☐ Agent

☒ Addressee

B. Received by (Printed Name)

Klabacha

C. Date of Delivery

5/15

D. Is delivery address different from item 1? ☐ Yes  
If YES, enter delivery address below: ☐ No

3. Service Type

☒ Certified Mail

☐ Express Mail

☐ Registered

☒ Return Receipt for Merchandise

☐ Insured Mail

☐ C.O.D.

4. Restricted Delivery? (Extra Fee)

☐ Yes

UNITED STATES POSTAL SERVICE



First-Class Mail  
Postage & Fees Paid  
USPS  
Permit No. G-10

- Sender: Please print your name, address, and ZIP+4 in this box •

AZ  
933  
AZ  
931

AZ  
931

U.S. DEPARTMENT OF THE INTERIOR  
BUREAU OF LAND MANAGEMENT  
ARIZONA STATE OFFICE  
ONE NORTH CENTRAL AVE. SUITE 800  
PHOENIX, ARIZONA 85004-4427

PHOENIX, ARIZONA

2017 MAY -3 PM 2:12

RECEIVED  
OFFICE

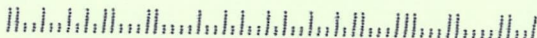

If additional information is required, please contact Tony Smith at 602-417-9355. Please include your AMC serial number(s) on all correspondence.

*/s/ Rebecca Heick*

Rebecca Heick  
Group Administrator  
Lands and Minerals

TSmith:lm:050212



**NOTICE!!**

**These documents have been scanned!**

**Do not place un-scanned documents beneath this notice!**

**Do not remove this notice from this file!**

GPO Jacket No. 560-102  
Print Order 61540  
Rise Business Services, LLC  
Job=AZ15 5/16/2019



Box Number= AZ15055



Claim Begin-End: AMC411023-AMC411029

3 Transfers



AZ15055-5

AMC410569-AMC411560

**NO  
DOCUMENTS  
FOUND**

NO DOCUMENTS FOUND  
NO DOCUMENTS FOUND



**NOTICE!!**

**These documents have been scanned!**

**Do not place un-scanned documents beneath this notice!**

**Do not remove this notice from this file!**

GPO Jacket No. 560-102  
Print Order 61540  
Rise Business Services, LLC  
Job=AZ15 5/16/2019



Box Number= AZ15055



Claim Begin-End: AMC411023-AMC411029

4 Miscellaneous



AZ15055-5

AMC410569-AMC411560



**NO  
DOCUMENTS  
FOUND**

NO DOCUMENTS FOUND  
NO DOCUMENTS FOUND

**NOTICE!!**

**These documents have been scanned!**

**Do not place un-scanned documents beneath this notice!**

**Do not remove this notice from this file!**

GPO Jacket No. 560-102  
Print Order 61540  
Rise Business Services, LLC  
Job=AZ15 5/16/2019



Box Number= AZ15055



Claim Begin-End: AMC411023-AMC411029

5 Annual Filings



AZ15055-5

AMC410569-AMC411560

UNITED STATES  
DEPARTMENT OF THE INTERIOR  
BUREAU OF LAND MANAGEMENT

MAINTENANCE FEE WAIVER CERTIFICATION

SEE INSTRUCTIONS ON PAGE 2

410881  
411023  
FORM APPROVED  
OMB NO. 1004-0114  
Expires: January 31, 2020

1. This small miner waiver is filed for the assessment year beginning on September 1, 2019 and ending on September 1, 2020.
2. The undersigned and all related parties owned ten or fewer mining claims, mill, or tunnel sites located and maintained on Federal lands in the United States of America on September 1, 2017.
3. The undersigned have performed the assessment work required by law for each mining claim listed prior to filing this waiver and understand that by filing this form, the undersigned must file an affidavit of assessment work with the Bureau of Land Management (BLM) by the December 30th following the filing of this waiver.
4. The undersigned understand that if the assessment work obligation has not yet come due under 30 U.S.C. 28 (for those claims in their first assessment year only), a notice of intent to hold reciting this condition must be recorded by the December 30th following the filing of this waiver.
5. The undersigned understand that mill and tunnel sites may also be listed on this waiver and be waived from payment of the maintenance fee, and that a notice of intent to hold for these sites is required to be filed with the BLM by the December 30th following the filing of this waiver.
6. The undersigned understand and acknowledge that pursuant to 43 U.S.C. 1212 and 18 U.S.C. 1001, the filing or recording of a false, fictitious, or fraudulent document with the BLM may result in a fine of up to \$250,000, a prison term not to exceed five years, or both.
7. The mining claims, mill or tunnel sites for which this waiver from payment of the maintenance fees is requested are:

CLAIM OR SITE NAME	BLM RECORDATION SERIAL NUMBER
1. SILVERSTONE	410881
2. SILVERSTONE 1	411023
3. SILVERSTONE 2	411024
4. SILVERSTONE 3	411025
5. SILVERSTONE 4	411026
6. SILVERSTONE 5	411027
7. SILVERSTONE 6	411028
8. SILVERSTONE 7	411029
9.	
10.	

The owner(s) (claimants) of the above mining claims and sites are:

PAUL KLABACHA  
(Owner's Name - Please Print)  
1 LIMESTONE COURT  
(Owner's Mailing Address)

Paul Klabacha  
(Owner's Signature)  
LEMONT IL 60439  
(City) (State) (Zip Code)

OCKINC@ATT.NET EMAIL  
(Owner's Name - Please Print)  
312 316-7224 PHONE  
(Owner's Mailing Address)

(Owner's Signature)  
(City) (State) (Zip Code)

(Owner's Name - Please Print)  
(Owner's Mailing Address)

(Owner's Signature)  
(City) (State) (Zip Code)

(Owner's Name - Please Print)  
(Owner's Mailing Address)

(Owner's Signature)  
(City) (State) (Zip Code)

(Continued on page 2)

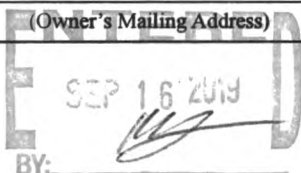

# 4552596

WU [Signature]



(Owner's Name - Please Print)	(Owner's Signature)		
(Owner's Mailing Address)	(City)	(State)	(Zip Code)
(Owner's Name - Please Print)	(Owner's Signature)		
(Owner's Mailing Address)	(City)	(State)	(Zip Code)
(Owner's Name - Please Print)	(Owner's Signature)		
(Owner's Mailing Address)	(City)	(State)	(Zip Code)
(Owner's Name - Please Print)	(Owner's Signature)		
(Owner's Mailing Address)	(City)	(State)	(Zip Code)

18 U.S.C. 1001 and 43 U.S.C. 1212 make it a crime for any person knowingly and willfully to make to any department or agency of the United States any false, fictitious or fraudulent statements or representations as to any matter within its jurisdiction.

#### INSTRUCTIONS

1. This certification is made under the provisions of 43 U.S.C. § 1744 and 30 U.S.C. §28-28k and the regulations thereunder (43 CFR Part 3830).
2. The claimant(s) must fill in the dates in paragraph 1 for the beginning and ending of the assessment year for which this waiver is sought.
3. The claimant(s) must fill in the date in paragraph 2 for the beginning of the assessment year for which this waiver is sought.
4. All claim and site names and BLM serial numbers must be listed for the mining claims, mill sites, and tunnel sites for which the waiver is sought.
5. All owners of the mining claims, mill sites, and tunnel sites and their addresses must be given.
6. This waiver form must be signed by all the claimants or their designated agent, in original form. If an agent is designated, a notarized designation of agent, signed by all of the claimants with proper address given, must be submitted with this waiver.
7. This form must be filed no later than September 1st for the upcoming assessment year in the BLM State Office where the mining claims or sites are recorded, or the waiver cannot be granted by the BLM. (Example: To obtain a waiver for the assessment year 2012, which begins on September 1, 2011, you must qualify for and file for a waiver no later than September 1, 2011, in the proper BLM State Office.)
8. For all mining claims which require assessment work, you must record an affidavit of labor on or before the December 30th immediately following the filing of this waiver. For all other mining claims or sites waived, you must record a notice of intent to hold on or before the December 30th immediately following the filing of this waiver.
9. Mill and tunnel sites may also be listed on this waiver and be waived from payment of the maintenance fee. A notice of intent to hold for these sites is required to be filed by the December 30th following the filing of this waiver.

**FOR OFFICIAL USE ONLY**

UNITED STATES  
DEPARTMENT OF THE INTERIOR  
BUREAU OF LAND MANAGEMENT

FORM APPROVED  
OMB NO.: 1004-0114  
Expires: October 31, 2016

AFFIDAVIT OF ANNUAL ASSESSMENT WORK

410881

411023

WHEN RECORDED, MAIL DOCUMENT TO:

NAME: PAUL KLABAKHA

ADDRESS: 1 LIMESTONE COURT

CITY, STATE, ZIP: LEMONT, IL. 60439

FOR COUNTY RECORDER'S USE

No. of Claims 8

x \$10/claim

Total due BLM \$ 80.00

TO ALL WHOM IT MAY CONCERN:

1. The undersigned certifies that at least \$100 per claim was expended for development, labor and improvements, or equivalent value added, as the annual assessment work for the assessment year ending September 1, 2018 for the following contiguous unpatented mining claim(s), located in the County of YAVAPAI, in the State of ARIZONA.

BLM Serial No.	Name of Claim	Tp	Rg	Sec	Mer	County Recordation* Book and Page No.	Date
410881	SILVERSTONE	11N	1W	2		B4882 P905	2011
411023	SILVERSTONE 1	11N	1W	2		B4882 P906	2011
411024	SILVERSTONE 2	11N	1W	2		B4882 P907	2011
411025	SILVERSTONE 3	11N	1W	2		B4882 P908	2011
411026	SILVERSTONE 4	11N	1W	2		B4882 P909	2011
411027	SILVERSTONE 5	11N	1W	2		B4882 P910	2011
411028	SILVERSTONE 6	11N	1W	2		B4882 P911	2011
411029	SILVERSTONE 7	11N	1W	2		B4882 P912	2011
		11N	1W	2			

(Continued on page 2)

#4242908  
ENTERED  
AUG 28 2018  
BY: RAM

2. Type of labor and improvements (specify what was done and give the total value for that labor and improvement to show at least \$100 for each claim). If a geological, geochemical, or geophysical survey was performed, as per 30 U.S.C. 28-1, reference the title of the report of survey, give cost and date of the survey and report, and indicate it was filed with the County Recorder:

Description of Work Performed	Value of Work Performed	Date Work Was Performed
SERIES ROAD WORK AFTER FIRES.	1,000	6-20-2018
GRADING BRUSH CUTTING		
PANNING AND DETECTING		

3. Name and mailing address of each person who performed the labor and improvements:

Name (please print)

Current Mailing Address (please print)

PAUL KLABACNA

1 LIMESTONE CT.  
LEMON, IL. 60439

4. Name and mailing address of each person who holds and claims the subject mining claim(s) for the valuable minerals contained therein. Be sure to indicate if there is a change of address:

Name (please print)

Current Mailing Address (please print)

PAUL KLABACNA

1 LIMESTONE COURT  
LEMON, IL. 60439

RECEIVED  
BLM ARIZONA STATE OFFICE  
2018 AUG 21 P 1:39  
PHOENIX, ARIZONA

5. The undersigned testifies that on the date of 6/15, 2018, all monuments required by law were erected upon the subject claim(s), and all notices required by law were posted on the subject claim(s) or copies thereof were in place, and at said date, each corner monument bore or contained



markings sufficient to appropriately designate the corner of the claim to which it pertains and the name of the claim(s).

I hereby certify under penalty of perjury under the laws of the State of ARIZONA that the foregoing statements are true and correct:

Paul Klabucha Date: 8-15-2018  
(Signature of person responsible for above statement)

Title 18 U.S.C. 1001 and 43 U.S.C. 1212 make it a crime for any person knowingly and willfully to make to any department or agency of the United States any false, fictitious or fraudulent statements or representations as to any matter within its jurisdiction.

### Notary Block

SUBSCRIBED AND SWORN TO before me, this 15th day of August 2018

By: Paul T KLABUCHA  
(Signature of Affiant)

Title: Claudia C Rocio Ariz.

My Commission Expires: 01/30/2022



### INSTRUCTIONS

1. This is an optional form that may be used to satisfy the requirements for the Bureau of Land Management (BLM) under the provisions of 43 U.S.C. §1744 and 30 U.S.C. §28-28d and the regulations thereunder (43 CFR part 3835). Since local and State laws may vary, you should contact your local and State agencies where the claims are located to ensure all applicable laws and requirements are satisfied.
2. The claimant(s) must fill in the date in paragraph 1 for the applicable assessment year and the county and state where the claims are located.
3. All claim names, BLM serial numbers, legal descriptions, and original county recording information must be listed for the claims pertaining to this assessment notice.
4. The claimant(s) must complete paragraph 2 listing all labor or improvements which was performed on or did benefit the subject mining claims. The value and date of the labor or improvements must also be listed. The total amount of labor or improvements can be listed, but the total expenditure must equal at least \$100 for each claim.
5. The names and current mailing addresses of the person(s) performing the labor shall be listed in paragraph 3.
6. The name and current mailing address of each owner (claimant) of the claims shall be listed in paragraph 4. The mailing address shall be the owner's address and not the address of an agent or anyone representing the claimant. Be sure to note if there has been a change of address.
7. Paragraph 5 shall be completed to show the date it was verified that all monuments required by law were properly erected, all notices were posted, and that corners were appropriately designated for all claims listed.
8. An exact legible reproduction or duplicate (other than microfilm or other electronic media) of this affidavit or another type of affidavit of assessment work that you file or will file in the county where each claim is located, must be filed with the BLM on or before December 30 of the calendar year in which the assessment year ends. For mill or tunnel sites, a separate notice of intent to hold must be filed with the BLM on or before December 30. Requirements for filing a notice of intent to hold can be found at 43 CFR 3835.33.
9. A processing fee of \$10 for each claim listed must be remitted to the BLM along with this or any other affidavit of assessment work.

**CLAYBACK  
DEVELOPMENT, LLC**

1 LIMESTONE CT • LEMONT, IL 60439

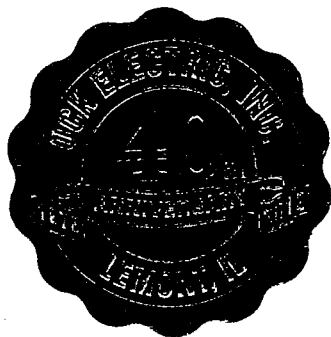

BLM

ONE NORTH CENTRAL  
PHOENIX, AZ.

85004-4427

PHOENIX, ARIZONA

2018 AUG 21 P 1:39

RECEIVED  
BLM ARIZONA OFFICE

15 SEP 2018 PM 3:2

15 SEP 2018 PM 3:2

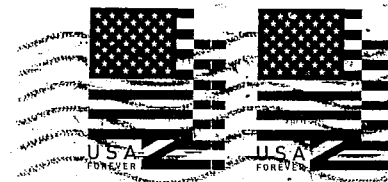

85004-442705  
MINING CLAIMS RENEWAL

**United States Department of the Interior**  
**Bureau of Land Management**  
DIV OF LANDS, MINRLS & ENERGY  
ONE N CENTRAL AVE  
PHOENIX, AZ 85004 -4427  
Phone: 602-417-9200

Receipt

No: 4242908

<b>Transaction #:</b> 4358339	
<b>Date of Transaction:</b> 08/23/2018	
<b>CUSTOMER:</b>	
	PAUL KLABACHA 1 LIMESTONE CT LEMONT,IL 60439-2102 US

LINE #	QTY	DESCRIPTION	REMARKS	UNIT PRICE	TOTAL
1	1.00	LOCATABLE MINERALS / MINING CLAIMS- NOT NEW-UNADJUD,ONE AUTH NO. ONLY / MINING CLAIM MONEY RECEIVED CASES: AMC410881/\$80.00	POL 2018/8 WAV	- n/a -	80.00
<b>TOTAL:</b>					<b>\$80.00</b>

PAYMENT INFORMATION				
1	AMOUNT:	80.00	POSTMARKED:	N/A
	TYPE:	CHECK	RECEIVED:	08/21/2018
	CHECK NO:	4025		
	NAME:	CLAYBACK DEVELOPMENT 1 LIMESTONE CT LEMONT IL 60439-2102 US		

REMARKS
WAIVER HAS EXPIRED/PLEASE FILL OUT A CURRENT ONE AND RETURN ASAP

This receipt was generated by the automated BLM Collections and Billing System and is a paper representation of a portion of the official electronic record contained therein.



UNITED STATES  
DEPARTMENT OF THE INTERIOR  
BUREAU OF LAND MANAGEMENT  
MAINTENANCE FEE WAIVER CERTIFICATION

SEE INSTRUCTIONS ON PAGE 2

FORM APPROVED  
OMB NO. 1004-0114  
Expires: January 31, 2020

1. This small miner waiver is filed for the assessment year beginning on September 1, 2018 and ending on September 1, 2019.
2. The undersigned and all related parties owned ten or fewer mining claims, mill, or tunnel sites located and maintained on Federal lands in the United States of America on September 1, 2011.
3. The undersigned have performed the assessment work required by law for each mining claim listed prior to filing this waiver and understand that by filing this form, the undersigned must file an affidavit of assessment work with the Bureau of Land Management (BLM) by the December 30th following the filing of this waiver.
4. The undersigned understand that if the assessment work obligation has not yet come due under 30 U.S.C. 28 (for those claims in their first assessment year only), a notice of intent to hold reciting this condition must be recorded by the December 30th following the filing of this waiver.
5. The undersigned understand that mill and tunnel sites may also be listed on this waiver and be waived from payment of the maintenance fee, and that a notice of intent to hold for these sites is required to be filed with the BLM by the December 30th following the filing of this waiver.
6. The undersigned understand and acknowledge that pursuant to 43 U.S.C. 1212 and 18 U.S.C. 1001, the filing or recording of a false, fictitious, or fraudulent document with the BLM may result in a fine of up to \$250,000, a prison term not to exceed five years, or both.
7. The mining claims, mill or tunnel sites for which this waiver from payment of the maintenance fees is requested are:

CLAIM OR SITE NAME	BLM RECORDATION SERIAL NUMBER
1. SILVERSTONE	410881
2. SILVERSTONE 1	411023
3. SILVERSTONE 2	411024
4. SILVERSTONE 3	411025
5. SILVERSTONE 4	411026
6. SILVERSTONE 5	411027
7. SILVERSTONE 6	411028
8. SILVERSTONE 7	411029
9.	
10.	

The owner(s) (claimants) of the above mining claims and sites are:

PAUL KLABACHA

(Owner's Name - Please Print)

1 LIMESTONE COURT

(Owner's Mailing Address)

Paul Klabacha

(Owner's Signature)

LEWISTON

(City)

IL

(State)

60439

(Zip Code)

OCK INC @ ATT.NET (EMAIL)

(Owner's Name - Please Print)

312 316-7224 (PHONE)

(Owner's Mailing Address)

(Owner's Signature)

(City)

(State)

(Zip Code)

(Owner's Name - Please Print)

(Owner's Signature)

(Owner's Mailing Address)

(City)

(State)

(Zip Code)

(Owner's Name - Please Print)

(Owner's Signature)

(Owner's Mailing Address)

(City)

(State)

(Zip Code)

(Continued on page 2)

ENTERED  
SEP 14 2018  
BY: BBS

RECEIVED  
BLM AZ STATE OFFICE  
2018 SEP -6 P 2:09  
PHOENIX, ARIZONA

410881  
411023

39

(Owner's Name - Please Print)	(Owner's Signature)		
(Owner's Mailing Address)	(City)	(State)	(Zip Code)
(Owner's Name - Please Print)	(Owner's Signature)		
(Owner's Mailing Address)	(City)	(State)	(Zip Code)
(Owner's Name - Please Print)	(Owner's Signature)		
(Owner's Mailing Address)	(City)	(State)	(Zip Code)
(Owner's Name - Please Print)	(Owner's Signature)		
(Owner's Mailing Address)	(City)	(State)	(Zip Code)

18 U.S.C. 1001 and 43 U.S.C. 1212 make it a crime for any person knowingly and willfully to make to any department or agency of the United States any false, fictitious or fraudulent statements or representations as to any matter within its jurisdiction.

#### INSTRUCTIONS

1. This certification is made under the provisions of 43 U.S.C. § 1744 and 30 U.S.C. § 28-28k and the regulations thereunder (43 CFR Part 3830)
2. The claimant(s) must fill in the dates in paragraph 1 for the beginning and ending of the assessment year for which this waiver is sought.
3. The claimant(s) must fill in the date in paragraph 2 for the beginning of the assessment year for which this waiver is sought.
4. All claim and site names and BLM serial numbers must be listed for the mining claims, mill sites, and tunnel sites for which the waiver is sought.
5. All owners of the mining claims, mill sites, and tunnel sites and their addresses must be given.
6. This waiver form must be signed by all the claimants or their designated agent, in original form. If an agent is designated, a notarized designation of agent, signed by all of the claimants with proper address given, must be submitted with this waiver.
7. This form must be filed no later than September 1st for the upcoming assessment year in the BLM State Office where the mining claims or sites are recorded, or the waiver cannot be granted by the BLM. (Example: To obtain a waiver for the assessment year 2012, which begins on September 1, 2011, you must qualify for and file for a waiver no later than September 1, 2011, in the proper BLM State Office.)
8. For all mining claims which require assessment work, you must record an affidavit of labor on or before the December 30th immediately following the filing of this waiver. For all other mining claims or sites waived, you must record a notice of intent to hold on or before the December 30th immediately following the filing of this waiver.
9. Mill and tunnel sites may also be listed on this waiver and be waived from payment of the maintenance fee. A notice of intent to hold for these sites is required to be filed by the December 30th following the filing of this waiver.

FOR OFFICIAL USE ONLY

CLAYBACK  
DEVELOPMENT, LLC

1 LIMESTONE CT • LEMONT, IL 60439



BLM  
ONE NORTH CENTRAL AVE.  
SUITE 800  
PHOENIX, AZ. 85004-4427

ATTN: SUZIE CRUZE

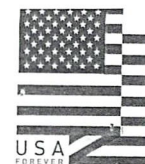

RECEIVED  
BLM AZ STATE OFFICE  
2018 SEP -6 P 2:09  
PHOENIX, ARIZONA



**PRIORITY®**  
**★ MAIL ★**

**FLAT RATE ENVELOPE**  
ONE RATE ★ ANY WEIGHT\*

APPLY PRIORITY MAIL POSTAGE HERE

U.S. POSTAGE PAID  
PM 2 DAY  
LEWISTON, IL  
SEP 04, 18  
AMOUNT  
**\$6.20**  
R2304H109239-07

RECEIVED  
BLM AZ STATE OFFICE

2018 SEP -6 P 2:09

PHOENIX, ARIZONA

EXPECTED DELIVERY DAY: 09/06/2018

\* For International shipments, the maximum wt

**USPS TRACKING NUMBER**



EP14H July 2013 Outer Dimension: 10 x 5

UNITED STATES  
DEPARTMENT OF THE INTERIOR  
BUREAU OF LAND MANAGEMENT

MAINTENANCE FEE WAIVER CERTIFICATION

SEE INSTRUCTIONS ON PAGE 2

410881  
411023  
FORM APPROVED  
OMB NO. 1004-0114  
Expires: October 31, 2016

1. This small miner waiver is filed for the assessment year beginning on September 1, 2018 and ending on September 1, 2019.
2. The undersigned and all related parties owned ten or fewer mining claims, mill, or tunnel sites located and maintained on Federal lands in the United States of America on September 1, 2011.
3. The undersigned have performed the assessment work required by law for each mining claim listed prior to filing this waiver and understand that by filing this form, the undersigned must file an affidavit of assessment work with the Bureau of Land Management (BLM) by the December 30th following the filing of this waiver.
4. The undersigned understand that if the assessment work obligation has not yet come due under 30 U.S.C. 28 (for those claims in their first assessment year only), a notice of intent to hold reciting this condition must be recorded by the December 30th following the filing of this waiver.
5. The undersigned understand that mill and tunnel sites may also be listed on this waiver and be waived from payment of the maintenance fee, and that a notice of intent to hold for these sites is required to be filed with the BLM by the December 30th following the filing of this waiver.
6. The undersigned understand and acknowledge that pursuant to 43 U.S.C. 1212 and 18 U.S.C. 1001, the filing or recording of a false, fictitious, or fraudulent document with the BLM may result in a fine of up to \$250,000, a prison term not to exceed five years, or both.
7. The mining claims, mill or tunnel sites for which this waiver from payment of the maintenance fees is requested are:

CLAIM OR SITE NAME	BLM RECORDATION SERIAL NUMBER
1. SILVERSTONE	410881 (913)
2. SILVERSTONE 1	411023
3. SILVERSTONE 2	411024
4. SILVERSTONE 3	411025
5. SILVERSTONE 4	411026
6. SILVERSTONE 5	411027
7. SILVERSTONE 6	411028
8. SILVERSTONE 7	411029
9.	
10.	

The owner(s) (claimants) of the above mining claims and sites are:

PAUL KLABACIK

(Owner's Name - Please Print)

1 LIMESTONE CT.

(Owner's Mailing Address)

Paul Klabach

(Owner's Signature)

LEWYNT

(City)

IL

(State)

60439

(Zip Code)

OCKINC@ATT.NET EMAIL

(Owner's Name - Please Print)

312 316-7224 PHONE

(Owner's Mailing Address)

(Owner's Signature)

(City)

(State)

(Zip Code)

(Owner's Name - Please Print)

(Owner's Mailing Address)

(City)

(State)

(Zip Code)

(Owner's Name - Please Print)

(Owner's Mailing Address)

(City)

(State)

(Zip Code)

(Continued on page 2)

#4242908

RECEIVED  
BLM AZ STATE OFFICE  
2018 AUG 21 PM 1:39  
PHOENIX, ARIZONA

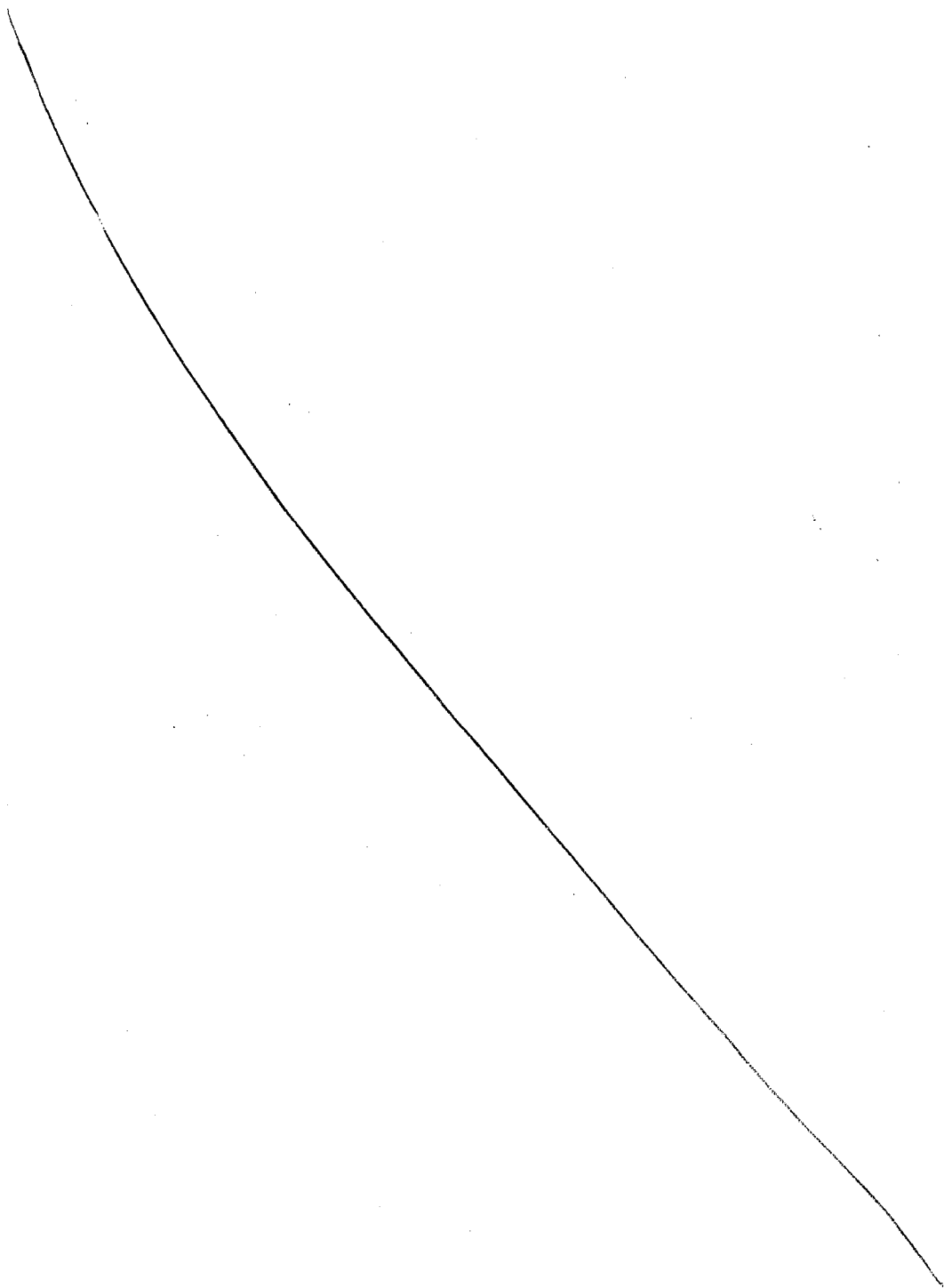



UNITED STATES  
DEPARTMENT OF THE INTERIOR  
BUREAU OF LAND MANAGEMENT  
**MAINTENANCE FEE WAIVER CERTIFICATION**

Amc410881  
411023

FORM APPROVED  
OMB NO. 1004-0114  
Expires: October 31, 2016

SEE INSTRUCTIONS ON PAGE 2

1. This small miner waiver is filed for the assessment year beginning on September 1, 2017 and ending on September 1, 2018.
2. The undersigned and all related parties owned ten or fewer mining claims, mill, or tunnel sites located and maintained on Federal lands in the United States of America on September 1, 2017.
3. The undersigned have performed the assessment work required by law for each mining claim listed prior to filing this waiver and understand that by filing this form, the undersigned must file an affidavit of assessment work with the Bureau of Land Management (BLM) by the December 30th following the filing of this waiver.
4. The undersigned understand that if the assessment work obligation has not yet come due under 30 U.S.C. 28 (for those claims in their first assessment year only), a notice of intent to hold reciting this condition must be recorded by the December 30th following the filing of this waiver.
5. The undersigned understand that mill and tunnel sites may also be listed on this waiver and be waived from payment of the maintenance fee, and that a notice of intent to hold for these sites is required to be filed with the BLM by the December 30th following the filing of this waiver.
6. The undersigned understand and acknowledge that pursuant to 43 U.S.C. 1212 and 18 U.S.C. 1001, the filing or recording of a false, fictitious, or fraudulent document with the BLM may result in a fine of up to \$250,000, a prison term not to exceed five years, or both.
7. The mining claims, mill or tunnel sites for which this waiver from payment of the maintenance fees is requested are:

CLAIM OR SITE NAME	BLM RECORDATION SERIAL NUMBER
1. <u>SILVERSTONE</u>	<u>410881</u>
2. <u>SILVERSTONE 1</u>	<u>411023</u>
3. <u>SILVERSTONE 2</u>	<u>411024</u>
4. <u>SILVERSTONE 3</u>	<u>411025</u>
5. <u>SILVERSTONE 4</u>	<u>411026</u>
6. <u>SILVERSTONE 5</u>	<u>411027</u>
7. <u>SILVERSTONE 6</u>	<u>411028</u>
8. <u>SILVERSTONE 7</u>	<u>411029</u>
9.	
10.	

RECEIVED  
BLM AZ STATE OFFICE  
2017 SEP - 1 P 3:07  
TUCSON, ARIZONA

The owner(s) (claimants) of the above mining claims and sites are:

PAUL KLABACHA

(Owner's Name - Please Print)

Paul Klabacha

(Owner's Signature)

1 LIMESTONE COURT

(Owner's Mailing Address)

LEMON

(City)

IL

(State)

60439

(Zip Code)

OCKINC @ ATT.NET

(Owner's Name - Please Print)

(EMAIL)

(Owner's Signature)

312 316-7224

(Owner's Mailing Address)

(CELLPHONE)

(City)

(State)

(Zip Code)

(Owner's Name - Please Print)

(Owner's Signature)

(Owner's Mailing Address)

(City)

(State)

(Zip Code)

(Owner's Name - Please Print)

(Owner's Signature)

(Owner's Mailing Address)

(City)

(State)

(Zip Code)

#3971331

UNITED STATES  
DEPARTMENT OF THE INTERIOR  
BUREAU OF LAND MANAGEMENT

FORM APPROVED  
OMB NO.: 1004-0114  
Expires: October 31, 2016

**AFFIDAVIT OF ANNUAL ASSESSMENT WORK**

WHEN RECORDED, MAIL DOCUMENT TO:

NAME: PAUL KLABACHA

ADDRESS: 1 LIMESTONE COURT

CITY, STATE, ZIP: LEMONT, IL. 60439

Amc 410881

Amc 411023

FOR COUNTY RECORDER'S USE

No. of Claims 8

x \$10/claim

Total due BLM \$ 80.00

TO ALL WHOM IT MAY CONCERN:

1. The undersigned certifies that at least \$100 per claim was expended for development, labor and improvements, or equivalent value added, as the annual assessment work for the assessment year ending September 1, 2017 for the following contiguous unpatented mining claim(s), located in the County of YAVAPAI, in the State of ARIZONA.

BLM Serial No.	Name of Claim	Tp	Rg	Sec	Mer	County Recordation Book and Page No.	Date
410881	SILVERSTONE	11N	1W	2		B4882 P905	2011
411023	SILVERSTONE 1	11N	1W	2		B4882 P906	2011
411024	SILVERSTONE 2	11N	1W	2		B4882 P907	2011
411025	SILVERSTONE 3	11N	1W	2		B4882 P908	2011
411026	SILVERSTONE 4	11N	1W	2		B4882 P909	2011
411027	SILVERSTONE 5	11N	1W	2		B4882 P910	2011
411028	SILVERSTONE 6	11N	1W	2		B4882 P911	2011
411029	SILVERSTONE 7	11N	1W	2		B4882 P912	2011

(Continued on page 2)

AT 9/15/17

PHOENIX, ARIZONA

SEP 11 P 3:07

RECEIVED  
BLM AZ STATE OFFICE



2. Type of labor and improvements (specify what was done and give the total value for that labor and improvement to show at least \$100 for each claim). If a geological, geochemical, or geophysical survey was performed, as per 30 U.S.C. 28-1, reference the title of the report of survey, give cost and date of the survey and report, and indicate it was filed with the County Recorder:

Description of Work Performed	Value of Work Performed	Date Work Was Performed
ROAD / TRAIL IMPROVEMENTS	\$ 11000.00	6-15-2017
GRADING		
BRUSH CUTTING		
PANNING AND DETECTING		

3. Name and mailing address of each person who performed the labor and improvements:

Name (please print)

Current Mailing Address (please print)

PAUL KLABAENA

1 LIMESTONE CT.  
LEMONT, IL. 60439

4. Name and mailing address of each person who holds and claims the subject mining claim(s) for the valuable minerals contained therein. Be sure to indicate if there is a change of address:

Name (please print)

Current Mailing Address (please print)

PAUL KLABAENA

1 LIMESTONE COURT  
LEMONT, IL. 60439  
OCKINC@ATT.NET  
312 316-7224

5. The undersigned testifies that on the date of 6-15 2017, all monuments required by law were erected upon the subject claim(s), and all notices required by law were posted on the subject claim(s) or copies thereof were in place, and at said date, each corner monument bore or contained

RECEIVED  
BIRMINGHAM OFFICE  
2017 SEP 27 PM 3:07  
PHOENIX, ARIZONA



markings sufficient to appropriately designate the corner of the claim to which it pertains and the name of the claim(s).

I hereby certify under penalty of perjury under the laws of the State of ARIZONA that the foregoing statements are true and correct:

Paul Klabacha  
(Signature of person responsible for above statement)

Date: 8-27-2017

Title 18 U.S.C. 1001 and 43 U.S.C. 1212 make it a crime for any person knowingly and willfully to make to any department or agency of the United States any false, fictitious or fraudulent statements or representations as to any matter within its jurisdiction.

### Notary Block

SUBSCRIBED AND SWORN TO before me, this 29 day of August 2017

By: Paul Klabacha  
(Signature of Affiant)

Title: \_\_\_\_\_

My Commission Expires: 01/30/2019

[Signature]



### INSTRUCTIONS

1. This is an optional form that may be used to satisfy the requirements for the Bureau of Land Management (BLM) under the provisions of 43 U.S.C. §1744 and 30 U.S.C. §28-28d and the regulations thereunder (43 CFR part 3835). Since local and State laws may vary, you should contact your local and State agencies where the claims are located to ensure all applicable laws and requirements are satisfied.
2. The claimant(s) must fill in the date in paragraph 1 for the applicable assessment year and the county and state where the claims are located.
3. All claim names, BLM serial numbers, legal descriptions, and original county recording information must be listed for the claims pertaining to this assessment notice.
4. The claimant(s) must complete paragraph 2 listing all labor or improvements which was performed on or did benefit the subject mining claims. The value and date of the labor or improvements must also be listed. The total amount of labor or improvements can be listed, but the total expenditure must equal at least \$100 for each claim.
5. The names and current mailing addresses of the person(s) performing the labor shall be listed in paragraph 3.
6. The name and current mailing address of each owner (claimant) of the claims shall be listed in paragraph 4. The mailing address shall be the owner's address and not the address of an agent or anyone representing the claimant. Be sure to note if there has been a change of address.
7. Paragraph 5 shall be completed to show the date it was verified that all monuments required by law were properly erected, all notices were posted, and that corners were appropriately designated for all claims listed.
8. An exact legible reproduction or duplicate (other than microfilm or other electronic media) of this affidavit or another type of affidavit of assessment work that you file or will file in the county where each claim is located, must be filed with the BLM on or before December 30 of the calendar year in which the assessment year ends. For mill or tunnel sites, a separate notice of intent to hold must be filed with the BLM on or before December 30. Requirements for filing a notice of intent to hold can be found at 43 CFR 3835.33.
9. A processing fee of \$10 for each claim listed must be remitted to the BLM along with this or any other affidavit of assessment work.

# CLAYBACK DEVELOPMENT, LLC

1 LIMESTONE CT • LEMONT, IL 60439

RECEIVED  
LEMONT, IL  
2017 SEP -1 P 3:07  
PHOENIX, ARIZONA

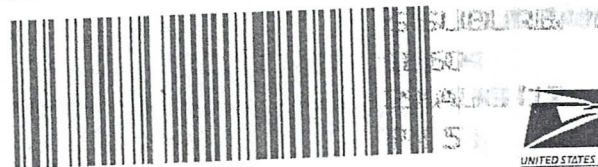

7017 1070 0000 8224 2539



1000



85004

U.S. POSTAGE  
PAID  
LEMONT, IL  
60439  
AUG 29, 17  
AMOUNT

**\$6.80**

R2305K138989-09

BLM  
ONE NORTH CENTRAL AVE.  
SUITE #800  
PHOENIX, AZ 85004-4427

85004-442700  
ATTN: SUITE 800

CLAIMS DRAWN



**United States Department of the Interior**  
**Bureau of Land Management**  
DIV OF LANDS, MINRLS & ENERGY  
ONE N CENTRAL AVE  
PHOENIX, AZ 85004 -4427  
Phone: 602-417-9200

Receipt

No: 3971331

<b>Transaction #:</b> 4081265	
<b>Date of Transaction:</b> 09/05/2017	
<b>CUSTOMER:</b>	
	PAUL KLABACHA 1 LIMESTONE CT LEMONT,IL 60439-2102 US

LINE #	QTY	DESCRIPTION	REMARKS	UNIT PRICE	TOTAL
1	1.00	LOCATABLE MINERALS / MINING CLAIMS- NOT NEW-UNADJUD,ONE AUTH NO. ONLY / MINING CLAIM MONEY RECEIVED CASES: AMC410881/\$80.00	POL 2017/8 WAV	- n/a -	80.00
<b>TOTAL:</b>					<b>\$80.00</b>

PAYMENT INFORMATION				
1	AMOUNT:	80.00	POSTMARKED:	08/29/2017
	TYPE:	CHECK	RECEIVED:	09/01/2017
	CHECK NO:	3925		
	NAME:	CLAYBACK DEVELOPMENT 1 LIMESTONE CT LEMONT IL 60439-2102 US		

REMARKS

This receipt was generated by the automated BLM Collections and Billing System and is a paper representation of a portion of the official electronic record contained therein.



UNITED STATES  
DEPARTMENT OF THE INTERIOR  
BUREAU OF LAND MANAGEMENT

1523

MAINTENANCE FEE WAIVER CERTIFICATION

FORM APPROVED

OMB NO. 1004-0114

Expires: October 31, 2016

SEE INSTRUCTIONS ON PAGE 2

410881 411023

1. This small miner waiver is filed for the assessment year beginning on September 1, 2015 and ending on September 1, 2017.
2. The undersigned and all related parties owned ten or fewer mining claims, mill, or tunnel sites located and maintained on Federal lands in the United States of America on September 1, 2011.
3. The undersigned have performed the assessment work required by law for each mining claim listed prior to filing this waiver and understand that by filing this form, the undersigned must file an affidavit of assessment work with the Bureau of Land Management (BLM) by the December 30th following the filing of this waiver.
4. The undersigned understand that if the assessment work obligation has not yet come due under 30 U.S.C. 28 (for those claims in their first assessment year only), a notice of intent to hold reciting this condition must be recorded by the December 30th following the filing of this waiver.
5. The undersigned understand that mill and tunnel sites may also be listed on this waiver and be waived from payment of the maintenance fee, and that a notice of intent to hold for these sites is required to be filed with the BLM by the December 30th following the filing of this waiver.
6. The undersigned understand and acknowledge that pursuant to 43 U.S.C. 1212 and 18 U.S.C. 1001, the filing or recording of a false, fictitious, or fraudulent document with the BLM may result in a fine of up to \$250,000, a prison term not to exceed five years, or both.
7. The mining claims, mill or tunnel sites for which this waiver from payment of the maintenance fees is requested are:

CLAIM OR SITE NAME	BLM RECORDATION SERIAL NUMBER
1. SILVERSTONE	410881
2. SILVERSTONE 1	411023
3. SILVERSTONE 2	411024
4. SILVERSTONE 3	411025
5. SILVERSTONE 4	411026
6. SILVERSTONE 5	411027
7. SILVERSTONE 6	411028
8. SILVERSTONE 7	411029
9.	
10.	

The owner(s) (claimants) of the above mining claims and sites are:

PAUL KLABACHA

(Owner's Name - Please Print)

1 LIMESTONE COURT

(Owner's Mailing Address)

OCKINC@ATT.NET

(Owner's Name - Please Print)

312 316-7224

(Owner's Mailing Address)

(Owner's Name - Please Print)

(Owner's Mailing Address)

(Owner's Name - Please Print)

(Owner's Mailing Address)

Paul Klabacha

(Owner's Signature)

LEMONT

(City)

IL

(State)

60439

(Zip Code)

(Owner's Signature)

(City)

(State)

(Zip Code)

(Owner's Signature)

(City)

(State)

(Zip Code)

(Owner's Signature)

(City)

(State)

(Zip Code)

(Continued on page 2)

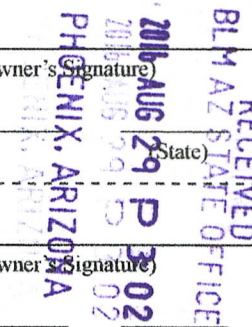
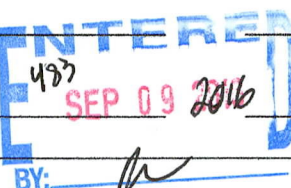

[Signature]

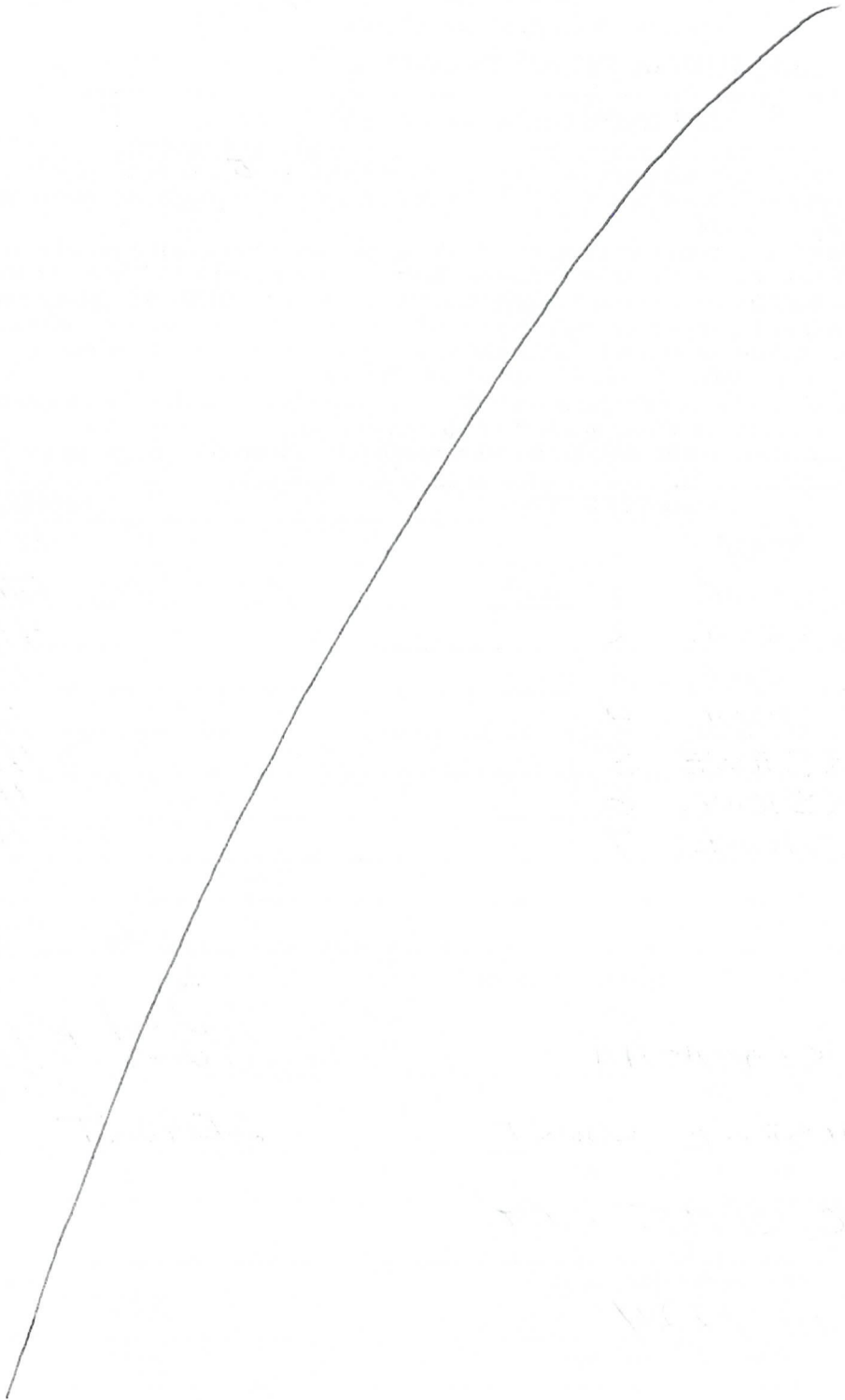

PHOENIX, ARIZONA

NOV 24 1965 3:05

RECEIVED



UNITED STATES  
DEPARTMENT OF THE INTERIOR  
BUREAU OF LAND MANAGEMENT

OMB NO.: 1004-0114  
Expires: October 31, 2016

**AFFIDAVIT OF ANNUAL ASSESSMENT WORK**

410881 411023

WHEN RECORDED, MAIL DOCUMENT TO:

NAME: PAUL KLABACHA

ADDRESS: 1 LIMESTONE COURT

CITY, STATE, ZIP: LEMONT, IL 60439

FOR COUNTY RECORDER'S USE

No. of Claims 8  
x \$10/claim  
Total due BLM \$ 80.00

TO ALL WHOM IT MAY CONCERN:

1. The undersigned certifies that at least \$100 per claim was expended for development, labor and improvements, or equivalent value added, as the annual assessment work for the assessment year ending September 1, 2016 for the following contiguous unpatented mining claim(s), located in the County of YAVAPAI, in the State of ARIZONA.

BLM Serial No.	Name of Claim	Tp	Rg	Sec	Mer	County Recordation Book and Page No.	Date
410881	SILVERSTONE	11N	1W	2		B 4882 P 905	2011
411023	SILVERSTONE 1	11N	1W	2		B 4882 P 906	2011
411024	SILVERSTONE 2	11N	1W	2		B 4882 P 907	2011
411025	SILVERSTONE 3	11N	1W	2		B 4882 P 908	2011
411026	SILVERSTONE 4	11N	1W	2		B 4882 P 909	2011
411027	SILVERSTONE 5	11N	1W	2		B 4882 P 910	2011
411028	SILVERSTONE 6	11N	1W	2		B 4882 P 911	2011
411029	SILVERSTONE 7	11N	1W	2		B 4882 P 912	2011
						PHOENIX, ARIZONA	
						2016 AUG 29 P 3-02	

RECEIVED  
BLM AZ STATE OFFICE

(Continued on page 2)

RECEIPT # 3646909



2. Type of labor and improvements (specify what was done and give the total value for that labor and improvement to show at least \$100 for each claim). If a geological, geochemical, or geophysical survey was performed, as per 30 U.S.C. 28-1, reference the title of the report of survey, give cost and date of the survey and report, and indicate it was filed with the County Recorder:

Description of Work Performed	Value of Work Performed	Date Work Was Performed
ROAD IMPROVEMENTS	1,000.00	6-15-2016
GRADING		
CONCRETING WASHOUTS		
BRUSH CUTTING		
PANNING AND DETECTING		

3. Name and mailing address of each person who performed the labor and improvements:

Name (please print)

Current Mailing Address (please print)

PAUL KLABACHA

1 LIMESTONE COURT  
LEMONT, IL. 60439

4. Name and mailing address of each person who holds and claims the subject mining claim(s) for the valuable minerals contained therein. Be sure to indicate if there is a change of address:

Name (please print)

Current Mailing Address (please print)

PAUL KLABACHA

1 LIMESTONE COURT  
LEMONT, IL. 60439  
OCK INC @ ATT.NET  
312 316-7224  
RECEIVED  
BLM AZ STATE OFFICE  
JUN 29 10 30 AM '16  
PHOENIX ARIZONA

5. The undersigned testifies that on the date of 6-15, 2016, all monuments required by law were erected upon the subject claim(s), and all notices required by law were posted on the subject claim(s) or copies thereof were in place, and at said date, each corner monument bore or contained

markings sufficient to appropriately designate the corner of the claim to which it pertains and the name of the claim(s).

I hereby certify under penalty of perjury under the laws of the State of ARIZONA that the foregoing statements are true and correct:

Paul Klebush

(Signature of person responsible for above statement)

Date: 8-24-2016

Title 18 U.S.C. 1001 and 43 U.S.C. 1212 make it a crime for any person knowingly and willfully to make to any department or agency of the United States any false, fictitious or fraudulent statements or representations as to any matter within its jurisdiction.

### Notary Block

SUBSCRIBED AND SWORN TO before me, this 25<sup>th</sup> day of August 2016

By: [Signature]  
(Signature of Affiant)

Title: Notary

My Commission Expires: 01/30/2019



### INSTRUCTIONS

1. This is an optional form that may be used to satisfy the requirements for the Bureau of Land Management (BLM) under the provisions of 43 U.S.C. §1744 and 30 U.S.C. §28-28d and the regulations thereunder (43 CFR part 3835). Since local and State laws may vary, you should contact your local and State agencies where the claims are located to ensure all applicable laws and requirements are satisfied.
2. The claimant(s) must fill in the date in paragraph 1 for the applicable assessment year and the county and state where the claims are located.
3. All claim names, BLM serial numbers, legal descriptions, and original county recording information must be listed for the claims pertaining to this assessment notice.
4. The claimant(s) must complete paragraph 2 listing all labor or improvements which was performed on or did benefit the subject mining claims. The value and date of the labor or improvements must also be listed. The total amount of labor or improvements can be listed, but the total expenditure must equal at least \$100 for each claim.
5. The names and current mailing addresses of the person(s) performing the labor shall be listed in paragraph 3.
6. The name and current mailing address of each owner (claimant) of the claims shall be listed in paragraph 4. The mailing address shall be the owner's address and not the address of an agent or anyone representing the claimant. Be sure to note if there has been a change of address.
7. Paragraph 5 shall be completed to show the date it was verified that all monuments required by law were properly erected, all notices were posted, and that corners were appropriately designated for all claims listed.
8. An exact legible reproduction or duplicate (other than microfilm or other electronic media) of this affidavit or another type of affidavit of assessment work that you file or will file in the county where each claim is located, must be filed with the BLM on or before December 30 of the calendar year in which the assessment year ends. For mill or tunnel sites, a separate notice of intent to hold must be filed with the BLM on or before December 30. Requirements for filing a notice of intent to hold can be found at 43 CFR 3835.33.
9. A processing fee of \$10 for each claim listed must be remitted to the BLM along with this or any other affidavit of assessment work.

PHOENIX, ARIZONA

United States Department of the Interior  
Bureau of Land Management  
DIV OF LANDS, MINRLS & ENERGY  
ONE N CENTRAL AVE  
PHOENIX, AZ 85004 -4427  
Phone: 602-417-9200

Receipt

No: 3646909

Transaction #: 3750894  
Date of Transaction: 08/30/2016

CUSTOMER:

PAUL KLABACHA  
1 LIMESTONE CT  
LEMONT, IL 60439-2102 US

LINE #	QTY	DESCRIPTION	REMARKS	UNIT PRICE	TOTAL
1	1.00	LOCATABLE MINERALS / MINING CLAIMS-NOT NEW-UNADJUD, ONE AUTH NO. ONLY / MINING CLAIM MONEY RECEIVED CASES: AMC410881/\$80.00	WAIVER 2017 - 8 / POL 2016 - 8	- n/a -	80.00
TOTAL:					\$80.00

PAYMENT INFORMATION

1	AMOUNT:	80.00	POSTMARKED:	08/25/2016
	TYPE:	CHECK	RECEIVED:	08/29/2016
	CHECK NO:	1791		
	NAME:	KLABACHA, PAUL 1 LIMESTONE CT LEMONT IL 60439-2102 US		

REMARKS

This receipt was generated by the automated BLM Collections and Billing System and is a paper representation of a portion of the official electronic record contained therein.

ENTERED  
SEP - 1 2016  
BY: 



**CLAYBACK  
DEVELOPMENT, LLC**

1 LIMESTONE CT • LEMONT, IL 60439

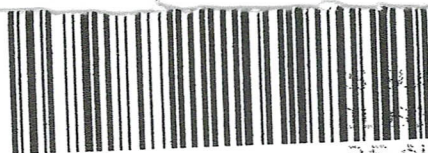

7016 0910 0000 5232 2417



1000

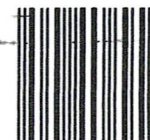

85004

U.S. POSTAGE  
PAID  
LEMONT, IL  
60439  
AUG 25, 16  
AMOUNT

**\$3.98**

R2304H109239-22

BUREAU OF LAND MGMT.  
1 NORTH CENTRAL AVE.  
SUITE 800  
PHOENIX, AZ. 85004-4427

RECEIVED  
BLM AZ STATE OFFICE

2016 AUG 29 P 3:01

PHOENIX, ARIZONA

ATTN: SUZI CRUZ

MINING CLAIMS

85004-442700

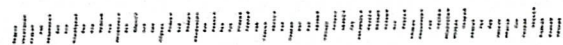

UNITED STATES  
DEPARTMENT OF THE INTERIOR  
BUREAU OF LAND MANAGEMENT

MAINTENANCE FEE WAIVER CERTIFICATION

469

AA

410881  
411023

FORM APPROVED  
OMB NO. 1004-0114  
Expires: October 31, 2016

SEE INSTRUCTIONS ON PAGE 2

1. This small miner waiver is filed for the assessment year beginning on September 1, 2015 and ending on September 1, 2016.
2. The undersigned and all related parties owned ten or fewer mining claims, mill, or tunnel sites located and maintained on Federal lands in the United States of America on September 1, 2014. 2015 P.K.
3. The undersigned have performed the assessment work required by law for each mining claim listed prior to filing this waiver and understand that by filing this form, the undersigned must file an affidavit of assessment work with the Bureau of Land Management (BLM) by the December 30th following the filing of this waiver.
4. The undersigned understand that if the assessment work obligation has not yet come due under 30 U.S.C. 28 (for those claims in their first assessment year only), a notice of intent to hold reciting this condition must be recorded by the December 30th following the filing of this waiver.
5. The undersigned understand that mill and tunnel sites may also be listed on this waiver and be waived from payment of the maintenance fee, and that a notice of intent to hold for these sites is required to be filed with the BLM by the December 30th following the filing of this waiver.
6. The undersigned understand and acknowledge that pursuant to 43 U.S.C. 1212 and 18 U.S.C. 1001, the filing or recording of a false, fictitious, or fraudulent document with the BLM may result in a fine of up to \$250,000, a prison term not to exceed five years, or both.
7. The mining claims, mill or tunnel sites for which this waiver from payment of the maintenance fees is requested are:

CLAIM OR SITE NAME	BLM RECORDATION SERIAL NUMBER
1. SILVERSTONE	410881 ✓
2. SILVERSTONE 1	411023
3. SILVERSTONE 2	411024
4. SILVERSTONE 3	411025
5. SILVERSTONE 4	411026
6. SILVERSTONE 5	411027
7. SILVERSTONE 6	411028
8. SILVERSTONE 7	411029
9.	
10.	

The owner(s) (claimants) of the above mining claims and sites are:

PAUL KLABACHA

(Owner's Name - Please Print)

1 LIMESTONE COURT

(Owner's Mailing Address)

Paul Klabacha

(Owner's Signature)

LEMONT

(City)

IL

(State)

60439

(Zip Code)

(Owner's Name - Please Print)

(Owner's Mailing Address)

(Owner's Signature)

(City)

(State)

(Zip Code)

(Owner's Name - Please Print)

(Owner's Mailing Address)

(Owner's Signature)

(City)

(State)

(Zip Code)

(Owner's Name - Please Print)

(Owner's Mailing Address)

(Owner's Signature)

(City)

(State)

(Zip Code)

(Continued on page 2)

ENTERED  
SEP 10 2015  
BY: [Signature]

RECEIVED  
BLM PHOENIX, ARIZONA  
2015 AUG 26 PM 3:20

NWV  
9/9/2015

(Owner's Name - Please Print)

(Owner's Signature)

(Owner's Mailing Address)

(City)

(State)

(Zip Code)

(Owner's Name - Please Print)

(Owner's Signature)

(Owner's Mailing Address)

(City)

(State)

(Zip Code)

(Owner's Name - Please Print)

(Owner's Signature)

(Owner's Mailing Address)

(City)

(State)

(Zip Code)

(Owner's Name - Please Print)

(Owner's Signature)

(Owner's Mailing Address)

(City)

(State)

(Zip Code)

18 U.S.C. 1001 and 43 U.S.C. 1212 make it a crime for any person knowingly and willfully to make to any department or agency of the United States any false, fictitious or fraudulent statements or representations as to any matter within its jurisdiction.

#### INSTRUCTIONS

1. This certification is made under the provisions of 43 U.S.C. § 1744 and 30 U.S.C. §28-28k and the regulations thereunder (43 CFR Part 3830).
2. The claimant(s) must fill in the dates in paragraph 1 for the beginning and ending of the assessment year for which this waiver is sought.
3. The claimant(s) must fill in the date in paragraph 2 for the beginning of the assessment year for which this waiver is sought.
4. All claim and site names and BLM serial numbers must be listed for the mining claims, mill sites, and tunnel sites for which the waiver is sought.
5. All owners of the mining claims, mill sites, and tunnel sites and their addresses must be given.
6. This waiver form must be signed by all the claimants or their designated agent, in original form. If an agent is designated, a notarized designation of agent, signed by all of the claimants with proper address given, must be submitted with this waiver.
7. This form must be filed no later than September 1st for the upcoming assessment year in the BLM State Office where the mining claims or sites are recorded, or the waiver cannot be granted by the BLM. (Example: To obtain a waiver for the assessment year 2012, which begins on September 1, 2011, you must qualify for and file for a waiver no later than September 1, 2011, in the proper BLM State Office.)
8. For all mining claims which require assessment work, you must record an affidavit of labor on or before the December 30th immediately following the filing of this waiver. For all other mining claims or sites waived, you must record a notice of intent to hold on or before the December 30th immediately following the filing of this waiver.
9. Mill and tunnel sites may also be listed on this waiver and be waived from payment of the maintenance fee. A notice of intent to hold for these sites is required to be filed by the December 30th following the filing of this waiver.

RECEIVED  
BLM STATE OFFICE  
2011 AUG 26 P 3:20  
PHOENIX, ARIZONA

FOR OFFICIAL USE ONLY



**AFFIDAVIT OF ANNUAL ASSESSMENT WORK**

WHEN RECORDED, MAIL DOCUMENT TO:

NAME: PAUL KLABACHA

ADDRESS: 1 LIMESTONE COURT

CITY, STATE, ZIP: LEMONT, IL. 60439

FOR COUNTY RECORDER'S USE

No. of Claims 8  
x \$10/claim  
Total due BLM \$ 80.00

TO ALL WHOM IT MAY CONCERN:

1. The undersigned certifies that at least \$100 per claim was expended for development, labor and improvements, or equivalent value added, as the annual assessment work for the assessment year ending September 1, 2015 for the following contiguous unpatented mining claim(s), located in the County of YAVAPAI, in the State of ARIZONA.

BLM Serial No.	Name of Claim	Tp	Rg	Sec	Mer	County Recordation Book and Page No.	Date
		Example: 13N 5E 14 MDM					
410881	SILVERSTONE	11N	1W	2		B 4882 P 905	2011
411023	SILVERSTONE 1	11N	1W	2		B 4882 P 906	2011
411024	SILVERSTONE 2	11N	1W	2		B 4882 P 907	2011
411025	SILVERSTONE 3	11N	1W	2		B 4882 P 908	2011
411026	SILVERSTONE 4	11N	1W	2		B 4882 P 909	2011
411027	SILVERSTONE 5	11N	1W	2		B 4882 P 910	2011
411028	SILVERSTONE 6	11N	1W	2		B 4882 P 911	2011
411029	SILVERSTONE 7	11N	1W	2		B 4882 P 912	2011

(Continued on page 2)

ENTERED  
AUG 31 2015  
BY: je

SCRIPT # 3378740

2. Type of labor and improvements (specify what was done and give the total value for that labor and improvement to show at least \$100 for each claim). If a geological, geochemical, or geophysical survey was performed, as per 30 U.S.C. 28-1, reference the title of the report of survey, give cost and date of the survey and report, and indicate it was filed with the County Recorder:

Description of Work Performed	Value of Work Performed	Date Work Was Performed
ROAD WORK IMPROVEMENTS	1,000.00	5-25-15

3. Name and mailing address of each person who performed the labor and improvements:

Name (please print)

Current Mailing Address (please print)

PAUL KLABACHA

1 LIMESTONE COURT  
LEMONT, IL. 60439

4. Name and mailing address of each person who holds and claims the subject mining claim(s) for the valuable minerals contained therein. Be sure to indicate if there is a change of address:

Name (please print)

Current Mailing Address (please print)

PAUL KLABACHA

1 LIMESTONE COURT  
LEMONT, IL 60439

RECEIVED  
JUN 26 P 3:20  
PHOENIX, ARIZONA

5. The undersigned testifies that on the date of 5-25, 2015, all monuments required by law were erected upon the subject claim(s), and all notices required by law were posted on the subject claim(s) or copies thereof were in place, and at said date, each corner monument bore or contained

markings sufficient to appropriately designate the corner of the claim to which it pertains and the name of the claim(s).

I hereby certify under penalty of perjury under the laws of the State of ARIZONA that the foregoing statements are true and correct:

Paul Klabocha  
(Signature of person responsible for above statement)

Date: 8-18-2015

Title 18 U.S.C. 1001 and 43 U.S.C. 1212 make it a crime for any person knowingly and willfully to make to any department or agency of the United States any false, fictitious or fraudulent statements or representations as to any matter within its jurisdiction.

### Notary Block

**SUBSCRIBED AND SWORN TO** before me, this 21 day of August 20 15

By: [Signature]  
(Signature of Affiant)

Title: \_\_\_\_\_

My Commission Expires: June 30, 2017

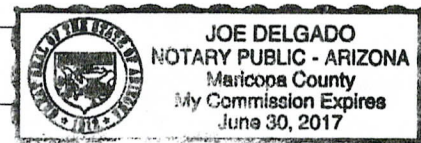

### INSTRUCTIONS

1. This is an optional form that may be used to satisfy the requirements for the Bureau of Land Management (BLM) under the provisions of 43 U.S.C. §1744 and 30 U.S.C. §28-28d and the regulations thereunder (43 CFR part 3835). Since local and State laws may vary, you should contact your local and State agencies where the claims are located to ensure all applicable laws and requirements are satisfied.
2. The claimant(s) must fill in the date in paragraph 1 for the applicable assessment year and the county and state where the claims are located.
3. All claim names, BLM serial numbers, legal descriptions, and original county recording information must be listed for the claims pertaining to this assessment notice.
4. The claimant(s) must complete paragraph 2 listing all labor or improvements which was performed on or did benefit the subject mining claims. The value and date of the labor or improvements must also be listed. The total amount of labor or improvements can be listed, but the total expenditure must equal at least \$100 for each claim.
5. The names and current mailing addresses of the person(s) performing the labor shall be listed in paragraph 3.
6. The name and current mailing address of each owner (claimant) of the claims shall be listed in paragraph 4. The mailing address shall be the owner's address and not the address of an agent or anyone representing the claimant. Be sure to note if there has been a change of address.
7. Paragraph 5 shall be completed to show the date it was verified that all monuments required by law were properly erected, all notices were posted, and that corners were appropriately designated for all claims listed.
8. An exact legible reproduction or duplicate (other than microfilm or other electronic media) of this affidavit or another type of affidavit of assessment work that you file or will file in the county where each claim is located, must be filed with the BLM on or before December 30 of the calendar year in which the assessment year ends. For mill or tunnel sites, a separate notice of intent to hold must be filed with the BLM on or before December 30. Requirements for filing a notice of intent to hold can be found at 43 CFR 3835.33.
9. A processing fee of \$10 for each claim listed must be remitted to the BLM along with this or any other affidavit of assessment work.

RECEIVED  
JUL 20 2015  
BLM  
MARICOPA COUNTY  
ARIZONA



## NOTICES

**THE PRIVACY ACT** and 43 CFR 2.48(d) require that you be furnished with the following information in connection with the information requested by this form.

**AUTHORITY:** 30 U.S.C. §28-28d and 43 CFR part 3835 permit collection of the information requested by this form.

**PRINCIPAL PURPOSE:** The BLM will use the information you provide to document compliance with 43 U.S.C. 1744 and that assessment work has been completed in accordance with 30 U.S.C. § 28-28d and 43 CFR part 3835 in lieu of paying the maintenance fee for the mining claims listed on this form.

**ROUTINE USES:** The BLM will only disclose this information in accordance with the provisions at 43 CFR 2.56(b) and (c).

**EFFECT OF NOT PROVIDING INFORMATION:** Disclosure of the requested information is required by 30 U.S.C. § 28-28d and 43 CFR part 3835 for claimants qualified to perform assessment work in lieu of paying the maintenance fee. Failure to submit all the requested information or to complete this form will delay the BLM's processing of the form and may preclude the BLM's acceptance of the assessment work information, which may result in forfeiture of the mining claim(s) by the claimant.

**THE PAPERWORK REDUCTION ACT** requires us to inform you that:

Use of this form is optional. You must perform assessment if a waiver to pay the maintenance fee has been requested. This form is provided to help you attest that annual assessment work has been completed in lieu of paying the maintenance fee for your claim(s). Submission of the requested information is necessary to obtain or retain a benefit.

You do not have to respond to this or any other Federal agency-sponsored information collection unless it displays a valid OMB control number.

**BURDEN HOURS STATEMENT:** The estimated public reporting burden for this form is 30 minutes per response, including the time for reviewing instructions, gathering and maintaining data, and completing and reviewing the form. You may submit comments regarding the burden estimate or any other aspect of this form to: U.S. Department of the Interior, Bureau of Land Management (1004-0114), Bureau Information Collection Clearance Officer (WO-630), 1849 C Street, N.W., Room 2134LM, Washington, D.C. 20240.

RECEIVED  
BLM  
2015 AUG 26 P 3:20  
PHOENIX, ARIZONA

CLAYBACK  
DEVELOPMENT, LLC

RECEIVED  
P.O. Box 21 • Lemont, IL 60439  
1 LIMESTONE CT.

2015 AUG 26 P 3:05

PHOENIX, ARIZONA

BLM

ONE NORTH CENTRAL AVE.

PHOENIX, ARIZONA

85004

PHOENIX AZ 852

24 AUG 2015 PM 6 L



85004442700

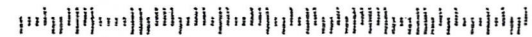

**United States Department of the Interior**  
**Bureau of Land Management**  
 LANDS/RECREATION & PLANNING  
 ONE N CENTRAL AVE  
 PHOENIX, AZ 85004 -2203  
 Phone: 602-417-9200

Receipt

No: 3378740

<b>Transaction #:</b> 3476992	
<b>Date of Transaction:</b> 08/27/2015	
<b>CUSTOMER:</b>	
	PAUL KLABACHA 1 LIMESTONE CT LEMONT,IL 60439-2102 US

LINE #	QTY	DESCRIPTION	REMARKS	UNIT PRICE	TOTAL
1	1.00	LOCATABLE MINERALS / MINING CLAIMS-NOT NEW-UNADJUD,ONE AUTH NO. ONLY / MINING CLAIM MONEY RECEIVED CASES: AMC410881/\$80.00	WAIVER - 8 2016 / POL - 8 2015	- n/a -	80.00
<b>TOTAL:</b>					<b>\$80.00</b>

PAYMENT INFORMATION			
NOTE: Items will appear on credit card statement as "Bureau of Land Mgmt CO".			
1	AMOUNT:	80.00	POSTMARKED: N/A
	TYPE:	CREDIT CARD	RECEIVED: 08/26/2015
	NAME:	KLABACHA, PAUL 1 LIMESTONE CT LEMONT IL 60439-2102 US	
	CARD NO:	XXXXXXXXXXXX1003	AUTH CODE: 127189
	NAME ON CARD:	PAUL KLABACHA	
	EXPIRES:	05/2020	
	SIGNATURE:		

REMARKS

This receipt was generated by the automated BLM Collections and Billing System and is a paper representation of a portion of the official electronic record contained therein.

**ENTERED**  
 AUG 31 2015  
 BY: *ur*

8/27/2015



UNITED STATES **1332**  
DEPARTMENT OF THE INTERIOR  
BUREAU OF LAND MANAGEMENT

**MAINTENANCE FEE WAIVER CERTIFICATION**

SEE INSTRUCTIONS ON PAGE 2

AMC 410881  
411023

FORM APPROVED  
OMB NO. 1004-0114  
Expires: October 31, 2016

1. This small miner waiver is filed for the assessment year beginning on September 1, 2014 and ending on September 1, 2015.
2. The undersigned and all related parties owned ten or fewer mining claims, mill, or tunnel sites located and maintained on Federal lands in the United States of America on September 1, 2011.
3. The undersigned have performed the assessment work required by law for each mining claim listed prior to filing this waiver and understand that by filing this form, the undersigned must file an affidavit of assessment work with the Bureau of Land Management (BLM) by the December 30th following the filing of this waiver.
4. The undersigned understand that if the assessment work obligation has not yet come due under 30 U.S.C. 28 (for those claims in their first assessment year only), a notice of intent to hold reciting this condition must be recorded by the December 30th following the filing of this waiver.
5. The undersigned understand that mill and tunnel sites may also be listed on this waiver and be waived from payment of the maintenance fee, and that a notice of intent to hold for these sites is required to be filed with the BLM by the December 30th following the filing of this waiver.
6. The undersigned understand and acknowledge that pursuant to 43 U.S.C. 1212 and 18 U.S.C. 1001, the filing or recording of a false, fictitious, or fraudulent document with the BLM may result in a fine of up to \$250,000, a prison term not to exceed five years, or both.
7. The mining claims, mill or tunnel sites for which this waiver from payment of the maintenance fees is requested are:

CLAIM OR SITE NAME	BLM RECORDATION SERIAL NUMBER
1. <u>SILVERSTONE</u>	✓ <u>410881</u>
2. <u>SILVERSTONE 1</u>	<u>411023</u>
3. <u>SILVERSTONE 2</u>	<u>411024</u>
4. <u>SILVERSTONE 3</u>	<u>411025</u>
5. <u>SILVERSTONE 4</u>	<u>411026</u>
6. <u>SILVERSTONE 5</u>	<u>411027</u>
7. <u>SILVERSTONE 6</u>	<u>411028</u>
8. <u>SILVERSTONE 7</u>	<u>411029</u>
9.	
10.	

The owner(s) (claimants) of the above mining claims and sites are:

PAUL KLABACHA

(Owner's Name - Please Print)

1 LIMESTONE COURT

(Owner's Mailing Address)

Paul Klabacha

(Owner's Signature)

LEMONT

(City)

IL

(State)

60439

(Zip Code)

(Owner's Name - Please Print)

(Owner's Mailing Address)

(Owner's Signature)

(City)

(State)

(Zip Code)

(Owner's Name - Please Print)

(Owner's Mailing Address)

(Owner's Signature)

(City)

(State)

(Zip Code)

(Owner's Name - Please Print)

(Owner's Mailing Address)

(Owner's Signature)

(City)

(State)

(Zip Code)

(Continued on page 2)

ENTERED  
SEP 10 2014

BY: RM

RECEIVED  
BLM AZ STATE OFFICE  
2014 AUG 18 P 2:44  
PHOENIX, ARIZONA

NWV  
2/12/2014

(Owner's Name - Please Print)	(Owner's Signature)		
(Owner's Mailing Address)	(City)	(State)	(Zip Code)
(Owner's Name - Please Print)	(Owner's Signature)		
(Owner's Mailing Address)	(City)	(State)	(Zip Code)
(Owner's Name - Please Print)	(Owner's Signature)		
(Owner's Mailing Address)	(City)	(State)	(Zip Code)
(Owner's Name - Please Print)	(Owner's Signature)		
(Owner's Mailing Address)	(City)	(State)	(Zip Code)

18 U.S.C. 1001 and 43 U.S.C. 1212 make it a crime for any person knowingly and willfully to make to any department or agency of the United States any false, fictitious or fraudulent statements or representations as to any matter within its jurisdiction.

#### INSTRUCTIONS

1. This certification is made under the provisions of 43 U.S.C. § 1744 and 30 U.S.C. §28-28k and the regulations thereunder (43 CFR Part 3830).
2. The claimant(s) must fill in the dates in paragraph 1 for the beginning and ending of the assessment year for which this waiver is sought.
3. The claimant(s) must fill in the date in paragraph 2 for the beginning of the assessment year for which this waiver is sought.
4. All claim and site names and BLM serial numbers must be listed for the mining claims, mill sites, and tunnel sites for which the waiver is sought.
5. All owners of the mining claims, mill sites, and tunnel sites and their addresses must be given.
6. This waiver form must be signed by all the claimants or their designated agent, in original form. If an agent is designated, a notarized designation of agent, signed by all of the claimants with proper address given, must be submitted with this waiver.
7. This form must be filed no later than September 1st for the upcoming assessment year in the BLM State Office where the mining claims or sites are recorded, or the waiver cannot be granted by the BLM. (Example: To obtain a waiver for the assessment year 2012, which begins on September 1, 2011, you must qualify for and file for a waiver no later than September 1, 2011, in the proper BLM State Office.)
8. For all mining claims which require assessment work, you must record an affidavit of labor on or before the December 30th immediately following the filing of this waiver. For all other mining claims or sites waived, you must record a notice of intent to hold on or before the December 30th immediately following the filing of this waiver.
9. Mill and tunnel sites may also be listed on this waiver and be waived from payment of the maintenance fee. A notice of intent to hold for these sites is required to be filed by the December 30th following the filing of this waiver.

RECEIVED  
 BLM STATE OFFICE  
 PHOENIX ARIZONA  
 2011 AUG 18 P 2:45

FOR OFFICIAL USE ONLY

UNITED STATES  
DEPARTMENT OF THE INTERIOR  
BUREAU OF LAND MANAGEMENT

AFFIDAVIT OF ANNUAL ASSESSMENT WORK

FORM APPROVED  
OMB NO.: 1004-0114  
Expires: October 31, 2016  
Ame 411023  
410881

WHEN RECORDED, MAIL DOCUMENT TO:

NAME: PAUL KLABACHA

ADDRESS: 1 LIMESTONE COURT

CITY, STATE, ZIP: LEMONT, IL,  
60439

FOR COUNTY RECORDER'S USE

No. of Claims 8

x \$10/claim

Total due BLM \$ 80

TO ALL WHOM IT MAY CONCERN:

1. The undersigned certifies that at least \$100 per claim was expended for development, labor and improvements, or equivalent value added, as the annual assessment work for the assessment year ending September 1, 2014 for the following contiguous unpatented mining claim(s), located in the County of YAVAPAI, in the State of ARIZONA.

BLM Serial No.	Name of Claim	Tp	Rg	Sec	Mer	County Recordation Book and Page No.	Date
410881	SILVERSTONE	11N	1W	2		B4882-P905	5-15-11
411023	SILVERSTONE 1	11N	1W	2		B4882-P906	5-15-11
411024	SILVERSTONE 2	11N	1W	2		B4882-P907	5-15-11
411025	SILVERSTONE 3	11N	1W	2		B4882-P908	5-15-11
411026	SILVERSTONE 4	11N	1W	2		B4882-P909	5-15-11
411027	SILVERSTONE 5	11N	1W	2		B4882-P910	5-15-11
411028	SILVERSTONE 6	11N	1W	2		B4882-P911	5-15-11
411029	SILVERSTONE 7	11N	1W	2		B4882-P912	5-15-11

RECEIVED  
BLM AZ STATE OFFICE  
2014 AUG 18 P 2:44  
PHOENIX, ARIZONA

(Continued on page 2)

ENTERED  
AUG 20 2014  
BY: Ram

RECEIPT # 3105510



2. Type of labor and improvements (specify what was done and give the total value for that labor and improvement to show at least \$100 for each claim). If a geological, geochemical, or geophysical survey was performed, as per 30 U.S.C. 28-1, reference the title of the report of survey, give cost and date of the survey and report, and indicate it was filed with the County Recorder:

Description of Work Performed	Value of Work Performed	Date Work Was Performed
ROAD WORK MAINTENANCE	1500.00	MAY 15 2014
PANNING + DETECTING	1000.00	JUNE - AUGUST 2014

3. Name and mailing address of each person who performed the labor and improvements:

Name (please print)

PAUL KLABACHA

KAREN KLABACHA

PETER JOUANOVICH

ELIZABETH JOUANOVICH

Current Mailing Address (please print)

1 LIMESTONE COURT LEMONT, IL. 60439

1703 SHERWOOD PRESCOTT, AZ. 86305

12210 S. REXFORD ALSIP, IL. 60823

1 LIMESTONE COURT LEMONT, IL. 60439

4. Name and mailing address of each person who holds and claims the subject mining claim(s) for the valuable minerals contained therein. Be sure to indicate if there is a change of address:

Name (please print)

PAUL KLABACHA

ELIZABETH JOUANOVICH

Current Mailing Address (please print)

1 LIMESTONE COURT LEMONT IL 60439

1 LIMESTONE COURT LEMONT IL 60439

RECEIVED  
BLM AZ STATE OFFICE  
2014 AUG 18 P 2:44  
PHOENIX, ARIZONA

5. The undersigned testifies that on the date of MAY 15<sup>TH</sup>, 2011, all monuments required by law were erected upon the subject claim(s), and all notices required by law were posted on the subject claim(s) or copies thereof were in place, and at said date, each corner monument bore or contained

markings sufficient to appropriately designate the corner of the claim to which it pertains and the name of the claim(s).

I hereby certify under penalty of perjury under the laws of the State of ARIZONA that the foregoing statements are true and correct:

Paul Klebucha

(Signature of person responsible for above statement)

Date: 8-15-2014

Title 18 U.S.C. 1001 and 43 U.S.C. 1212 make it a crime for any person knowingly and willfully to make to any department or agency of the United States any false, fictitious or fraudulent statements or representations as to any matter within its jurisdiction.

### Notary Block

SUBSCRIBED AND SWORN TO before me, this 15<sup>th</sup> day of August 20 14

By: Mary E. Lesnieski  
(Signature of Affiant)

Title: Administrative Assistant

My Commission Expires: 1-30-16



### INSTRUCTIONS

1. This is an optional form that may be used to satisfy the requirements for the Bureau of Land Management (BLM) under the provisions of 43 U.S.C. §1744 and 30 U.S.C. §28-28d and the regulations thereunder (43 CFR part 3835). Since local and State laws may vary, you should contact your local and State agencies where the claims are located to ensure all applicable laws and requirements are satisfied.
2. The claimant(s) must fill in the date in paragraph 1 for the applicable assessment year and the county and state where the claims are located.
3. All claim names, BLM serial numbers, legal descriptions, and original county recording information must be listed for the claims pertaining to this assessment notice.
4. The claimant(s) must complete paragraph 2 listing all labor or improvements which was performed on or did benefit the subject mining claims. The value and date of the labor or improvements must also be listed. The total amount of labor or improvements can be listed, but the total expenditure must equal at least \$100 for each claim.
5. The names and current mailing addresses of the person(s) performing the labor shall be listed in paragraph 3.
6. The name and current mailing address of each owner (claimant) of the claims shall be listed in paragraph 4. The mailing address shall be the owner's address and not the address of an agent or anyone representing the claimant. Be sure to note if there has been a change of address.
7. Paragraph 5 shall be completed to show the date it was verified that all monuments required by law were properly erected, all notices were posted, and that corners were appropriately designated for all claims listed.
8. An exact legible reproduction or duplicate (other than microfilm or other electronic media) of this affidavit or another type of affidavit of assessment work that you file or will file in the county where each claim is located, must be filed with the BLM on or before December 30 of the calendar year in which the assessment year ends. For mill or tunnel sites, a separate notice of intent to hold must be filed with the BLM on or before December 30. Requirements for filing a notice of intent to hold can be found at 43 CFR 3835.33.
9. A processing fee of \$10 for each claim listed must be remitted to the BLM along with this or any other affidavit of assessment work.

CLAYBACK  
DEVELOPMENT, LLC

P.O. Box 21 • Lemont, IL 60419

1 LIMESTONE CT.

CERTIFIED MAIL™

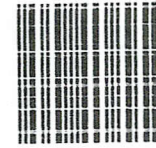
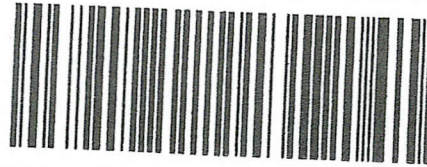

U.S. POSTAGE  
PAID  
LEMONT, IL  
60419  
AUG 15, 14  
AMOUNT

\$6.70  
00046490-03

RECEIVED  
BUREAU OF LAND MANAGEMENT  
13 2630 0001 1267 4818

2014 AUG 18 P 2:44

PHOENIX, ARIZONA

ARIZONA STATE OFFICE  
ONE NORTH CENTRAL AVE. SUITE 800  
PHOENIX, ARIZONA

85004-4427

RETURN RECEIPT  
REQUESTED

850043003

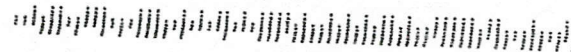



**United States Department of the Interior**  
**Bureau of Land Management**  
 LANDS/RECREATION & PLANNING  
 ONE N CENTRAL AVE  
 PHOENIX, AZ 85004 -2203  
 Phone: 602-417-9200

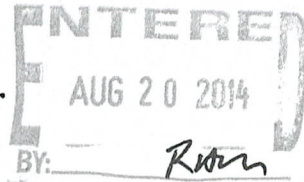

Receipt

No:

3105510

Transaction #: 3197161

Date of Transaction: 08/19/2014

CUSTOMER:

PAUL KLABACHA  
 1 LIMESTONE CT  
 LEMONT, IL 60439-2102 US

LINE #	QTY	DESCRIPTION	REMARKS	UNIT PRICE	TOTAL
1	1.00	LOCATABLE MINERALS / MINING CLAIMS-NOT NEW-UNADJUD, ONE AUTH NO. ONLY / MINING CLAIM MONEY RECEIVED CASES: AMC410881/\$80.00	MAINT FEE WAIVER (8) 2015 / POL (8) 2014	- n/a -	80.00
<b>TOTAL:</b>					<b>\$80.00</b>

## PAYMENT INFORMATION

1	AMOUNT:	80.00	POSTMARKED:	08/15/2014
	TYPE:	CHECK	RECEIVED:	08/18/2014
	CHECK NO:	3322		
	NAME:	CLAYBACK DEVELOPMENT 1 LIMESTONE CT LEMONT IL 60439-2102 US		

REMARKS

This receipt was generated by the automated BLM Collections and Billing System and is a paper representation of a portion of the official electronic record contained therein.

UNITED STATES  
DEPARTMENT OF THE INTERIOR  
BUREAU OF LAND MANAGEMENT

MAINTENANCE FEE WAIVER CERTIFICATION

410881

FORM APPROVED  
OMB NO. 1004-0114  
Expires: August 31, 2013

SEE INSTRUCTIONS ON PAGE 2

1. This small miner waiver is filed for the assessment year beginning on September 1, 2013 and ending on September 1, 2014.
2. The undersigned and all related parties owned ten or fewer mining claims, mill, or tunnel sites located and maintained on Federal lands in the United States of America on September 1, 2011.
3. The undersigned have performed the assessment work required by law for each mining claim listed prior to filing this waiver and understand that filing this form, an affidavit of assessment work must be recorded by the December 30th following the filing of this waiver.
4. The undersigned understand that if the assessment work obligation has not yet come due under 30 U.S.C. 28 (for those claims in their first assessment year only), a notice of intent to hold reciting this condition must be recorded by the December 30th following the filing of this waiver.
5. The undersigned understand that mill and tunnel sites may also be listed upon this waiver and be waived from payment of the maintenance fee, and that a notice of intent to hold for these sites is required to be recorded by the December 30th immediately following the filing of this waiver.
6. The undersigned understand and acknowledge that pursuant to 43 U.S.C. 1212 and 18 U.S.C. 1001, the filing or recording of a false, fictitious, or fraudulent document with the Bureau of Land Management may result in a fine of up to \$250,000, a prison term not to exceed five years, or both.
7. The mining claims, mill or tunnel sites for which this waiver from payment of the maintenance fees is requested are:

CLAIM OR SITE NAME	BLM RECORDATION SERIAL NUMBER
1. SILVERSTONE ✓	410881
2. SILVERSTONE 1	411023
3. SILVERSTONE 2	411024
4. SILVERSTONE 3	411025
5. SILVERSTONE 4	411026
6. SILVERSTONE 5	411027
7. SILVERSTONE 6	411028
8. SILVERSTONE 7	411029
9.	
10.	

The owner(s) (claimants) of the above mining claims and sites are:

PAUL KLABACHA  
(Owner's Name - Please Print)

*Paul Klabacha*  
(Owner's Signature)

1 LIMESTONE COURT  
(Street or P.O. Box)

LEMONT IL 60439  
(City) (State) (Zip Code)

(Owner's Name - Please Print)

(Owner's Signature)

(Street or P.O. Box)

(City) (State) (Zip Code)

(Owner's Name - Please Print)

(Owner's Signature)

(Street or P.O. Box)

(City) (State) (Zip Code)

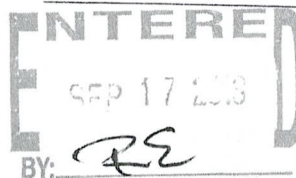



(Owner's Name - Please Print)	(Owner's Signature)		
(Street or P.O. Box)	(City)	(State)	(Zip Code)
(Owner's Name - Please Print)	(Owner's Signature)		
(Street or P.O. Box)	(City)	(State)	(Zip Code)
(Owner's Name - Please Print)	(Owner's Signature)		
(Street or P.O. Box)	(City)	(State)	(Zip Code)
(Owner's Name - Please Print)	(Owner's Signature)		
(Street or P.O. Box)	(City)	(State)	(Zip Code)

Title 18 U.S.C. Section 1001 and Title 43 U.S.C. Section 1212 makes it a crime for any person knowingly and willfully to make to any department or agency of the United States any false, fictitious or fraudulent statements or representations as to any matter within its jurisdiction.

#### INSTRUCTIONS

1. This certification is made under the provisions of §1744 of Title 43 and § 28-28k of Title 30 of the United States Code; and the regulations thereunder (43 CFR Part 3830).
2. The claimant(s) must fill in the dates in paragraph 1 for the beginning and ending of the assessment year for which this waiver is sought.
3. The claimant(s) must fill in the date in paragraph 2 for the beginning of the assessment year for which this waiver is sought.
4. All claim and site names and Bureau of Land Management (BLM) serial numbers must be listed for the mining claims, mill sites, and tunnel sites for which the waiver is sought.
5. All owners of the mining claims, mill sites, and tunnel sites and their addresses must be given.
6. This waiver form must be signed by all the claimants or their designated agent, in original form. If an agent is designated, a notarized designation of agent, signed by all of the claimants with proper address given, must be submitted with this waiver.
7. This form must be filed no later than September 1st for the upcoming assessment year in the BLM State Office where the mining claims or sites are recorded, or the waiver cannot be granted by the BLM. (Example: To obtain a waiver for the assessment year 2012, which begins on September 1, 2011 you must qualify for and file for a waiver no later than September 1, 2011, in the proper BLM State Office.)
8. For all mining claims which require assessment work, you must record an affidavit of labor on or before the December 30th immediately following the filing of this waiver. For all other mining claims or sites waived, you must record a notice of intent to hold on or before the December 30th immediately following the filing of this waiver.
9. Mill and tunnel sites may also be listed upon this waiver and be waived from payment of the maintenance fee. A notice of intent to hold for these sites is required to be filed by the December 30th following the filing of this waiver.

FOR OFFICIAL USE ONLY



When Recorded Return Document to:

PAUL KLABACHA  
1 LIMESTONE COURT  
LEMONT, IL.  
60439

☐ Check here if this is a change of address.

Telephone: 312 316-7224

E-mail address: OCKINC@ATT.NET

**AFFIDAVIT OF PERFORMANCE OF ANNUAL WORK**

1. State of Arizona, County of YAVAPAI ss:

2. I (Name) PAUL KLABACHA

3. Reside at (Address) 1 LIMESTONE COURT

City LEMONT County COOK

State IL Zip 60439 being duly sworn, depose and say that I am a citizen of the United States, more than eighteen years of age, and that all of the facts set forth in this affidavit, subject to the provisions and penalties of 18 U.S.C. 1001 pertaining to the filing of false, fictitious, or fraudulent statements with the United States, are true and correct according to the best of my knowledge, information and belief.

4. Owner's name and address (If not shown in Items 1-3 above).

5. That I am personally acquainted with the mining claim(s). The work and improvements were made by and at the expense of the owner(s) of said claim(s). Said contiguous group of claims, listed on this document, are situated in the

(optional) Mining District; YAVAPAI

County, Arizona.

Line No.	AMC NUMBER	CLAIM/SITE NAME	COUNTY RECORDER DATA (If available)	TWP	RNG	SEC
1	410881	SILVERSTONE	B 4882 P 905	11N	1W	2
2	411023	SILVERSTONE 1	B 4882 P 906	11N	1W	2
3	411024	SILVERSTONE 2	B 4882 P 907	11N	1W	2
4	411025	SILVERSTONE 3	B 4882 P 908	11N	1W	2
5	411026	SILVERSTONE 4	B 4882 P 909	11N	1W	2
6	411027	SILVERSTONE 5	B 4882 P 910	11N	1W	2

Form: MCF108  
Revised Jan. 2006  
Page 1 of 2  
ENTERED  
SEP 04 2013  
BY: HT



AFFIDAVIT OF PERFORMANCE OF ANNUAL WORK – page 2

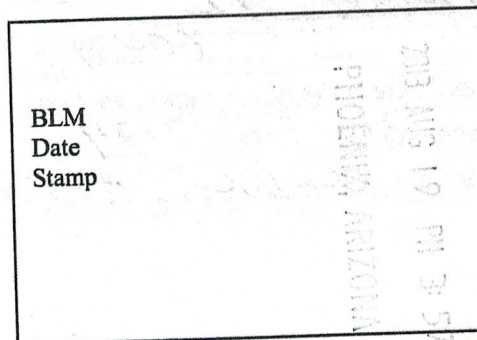

7	411028	SILVERSTONE 6	B4882 P911	11N	1W	2
8	411029	SILVERSTONE 7	B4882 P912	11N	1W	2
9						
10						

6. That between the dates starting at 12 o'clock noon on September 1, 20 12 and ending at 12 o'clock noon on September 1, 20 13 at least \$ 1,000 dollars worth of work and improvements were done and performed upon said claim(s) or upon one or more of a contiguous group of claims for the benefit of all, wholly or partly outside of a contiguous group of claims for the benefit of all, not including the location work.

7. That the following persons were employed to perform the work and improvements described herein: \_\_\_\_\_

PAUL KLABACHA KAREN KLABACHA KEN MUNDERFIELD

8. That the work and improvements performed were: ROAD WORK MAINTENANCE,  
PANNING AND DETECTING

9. Dated: 8-15-13 Signature: Paul Klabacha

SUBSCRIBED AND SWORN TO before me, a Notary Public, this 15<sup>TH</sup> day of AUGUST 20 13

By: Patricia A Shaffer

Notary Public Patricia A Shaffer

My Commission Expires 5-15-2016



Bureau of Land Management  
Arizona State Office  
[www.az.blm.gov](http://www.az.blm.gov)

No. of Claims: 8 x \$10 = 80  
Check No.: 3141 Init. mt  
Receipt No.: 2859865  
For BLM Use Only

Form: MCF108  
Revised Jan. 2006  
Page 2 of 2

CLAYBACK  
DEVELOPMENT, LLC

~~P.O. Box 21~~ • Lemont, IL 60439

1 LIMESTONE COURT

BLM

ONE N CENTRAL AVE

PHOENIX, AZ. 85004-2203

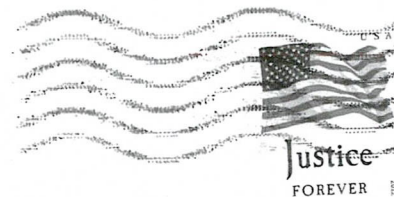

MINING CLAIMS RENEWAL 85004442700 ATTN: SUSIE CRUZE



**United States Department of the Interior**  
**Bureau of Land Management**  
 LANDS/RECREATION & PLANNING  
 ONE N CENTRAL AVE  
 PHOENIX, AZ 85004 -2203  
 Phone: 602-417-9200

Receipt

No: 2859865

<b>Transaction #:</b> 2945719	
<b>Date of Transaction:</b> 08/20/2013	
<b>CUSTOMER:</b>	
	PAUL KLABACHA 1 LIMESTONE CT LEMONT, IL 60439-2102 US

LINE #	QTY	DESCRIPTION	REMARKS	UNIT PRICE	TOTAL
1	1.00	LOCATABLE MINERALS / MINING CLAIMS- NOT NEW-UNADJUD.ONE AUTH NO. ONLY / MINING CLAIM MONEY RECEIVED CASES: AMC410881/\$80.00	POL 2013/8 WAV	- n/a -	80.00
<b>TOTAL:</b>					<b>\$80.00</b>

PAYMENT INFORMATION			
1	AMOUNT:	80.00	POSTMARKED: 08/15/2013
	TYPE:	CHECK	RECEIVED: 08/19/2013
	CHECK NO:	3141	
	NAME:	CLAYBACK DEVELOPMENT 1 LIMESTONE CT LEMONT IL 60439-2102 US	

REMARKS

This receipt was generated by the automated BLM Collections and Billing System and is a paper representation of a portion of the official electronic record contained therein.

UNITED STATES  
DEPARTMENT OF THE INTERIOR  
BUREAU OF LAND MANAGEMENT

MAINTENANCE FEE WAIVER CERTIFICATION

FORM APPROVED (336)  
OMB NO. 1004-0114  
Expires: August 31, 2013  
410881  
411023

SEE INSTRUCTIONS ON PAGE 2

1. This small miner waiver is filed for the assessment year beginning on September 1, 2012 and ending on September 1, 2013.
2. The undersigned and all related parties owned ten or fewer mining claims, mill, or tunnel sites located and maintained on Federal lands in the United States of America on September 1, 2011.
3. The undersigned have performed the assessment work required by law for each mining claim listed prior to filing this waiver and understand that filing this form, an affidavit of assessment work must be recorded by the December 30th following the filing of this waiver.
4. The undersigned understand that if the assessment work obligation has not yet come due under 30 U.S.C. 28 (for those claims in their first assessment year only), a notice of intent to hold reciting this condition must be recorded by the December 30th following the filing of this waiver.
5. The undersigned understand that mill and tunnel sites may also be listed upon this waiver and be waived from payment of the maintenance fee, and that a notice of intent to hold for these sites is required to be recorded by the December 30th immediately following the filing of this waiver.
6. The undersigned understand and acknowledge that pursuant to 43 U.S.C. 1212 and 18 U.S.C. 1001, the filing or recording of a false, fictitious, or fraudulent document with the Bureau of Land Management may result in a fine of up to \$250,000, a prison term not to exceed five years, or both.
7. The mining claims, mill or tunnel sites for which this waiver from payment of the maintenance fees is requested are:

CLAIM OR SITE NAME	BLM RECORDATION SERIAL NUMBER
1. SILVERSTONE	410881
2. SILVERSTONE 1	411023
3. SILVERSTONE 2	411024
4. SILVERSTONE 3	411025
5. SILVERSTONE 4	411026
6. SILVERSTONE 5	411027
7. SILVERSTONE 6	411028
8. SILVERSTONE 7	411029
9.	
10.	

The owner(s) (claimants) of the above mining claims and sites are:

PAUL KLABACHA  
(Owner's Name - Please Print)  
1 LIMESTONE COURT  
(Street or P.O. Box)  
LEMONT IL 60439  
(City) (State) (Zip Code)

*Paul Klabacha*  
(Owner's Signature)

(Owner's Name - Please Print)

(Owner's Signature)

(Street or P.O. Box)

(City)

(State)

(Zip Code)

(Owner's Name - Please Print)

(Owner's Signature)

(Street or P.O. Box)

(City)

(State)

(Zip Code)

(continued on page 2)

ENTERED IN COMPUTER

28 9.12.12

RECEIVED  
BLM AZ STATE OFFICE  
2012 AUG 29 A 10:16  
PHOENIX ARIZONA

(Owner's Name - Please Print)

(Owner's Signature)

(Street or P.O. Box)

(City)

(State)

(Zip Code)

(Owner's Name - Please Print)

(Owner's Signature)

(Street or P.O. Box)

(City)

(State)

(Zip Code)

(Owner's Name - Please Print)

(Owner's Signature)

(Street or P.O. Box)

(City)

(State)

(Zip Code)

(Owner's Name - Please Print)

(Owner's Signature)

(Street or P.O. Box)

(City)

(State)

(Zip Code)

Title 18 U.S.C. Section 1001 and Title 43 U.S.C. Section 1212 makes it a crime for any person knowingly and willfully to make to any department or agency of the United States any false, fictitious or fraudulent statements or representations as to any matter within its jurisdiction.

#### INSTRUCTIONS

1. This certification is made under the provisions of §1744 of Title 43 and § 28-28k of Title 30 of the United States Code; and the regulations thereunder (4 CFR Part 3830).
2. The claimant(s) must fill in the dates in paragraph 1 for the beginning and ending of the assessment year for which this waiver is sought.
3. The claimant(s) must fill in the date in paragraph 2 for the beginning of the assessment year for which this waiver is sought.
4. All claim and site names and Bureau of Land Management (BLM) serial numbers must be listed for the mining claims, mill sites, and tunnel sites for which the waiver is sought.
5. All owners of the mining claims, mill sites, and tunnel sites and their addresses must be given.
6. This waiver form must be signed by all the claimants or their designated agent, in original form. If an agent is designated, a notarized designation of agent, signed by all of the claimants with proper address given, must be submitted with this waiver.
7. This form must be filed no later than September 1st for the upcoming assessment year in the BLM State Office where the mining claims or sites are recorded, or the waiver cannot be granted by the BLM. (Example: To obtain a waiver for the assessment year 2012, which begins on September 1, 2011, you must qualify for and file for a waiver no later than September 1, 2011, in the proper BLM State Office.)
8. For all mining claims which require assessment work, you must record an affidavit of labor on or before the December 30th immediately following the filing of this waiver. For all other mining claims or sites waived, you must record a notice of intent to hold on or before the December 30th immediately following the filing of this waiver.
9. Mill and tunnel sites may also be listed upon this waiver and be waived from payment of the maintenance fee. A notice of intent to hold for these sites is required to be filed by the December 30th following the filing of this waiver.

RECEIVED  
BLM AZ STATE OFFICE  
2012 AUG 20 A 10:15  
PHOENIX ARIZONA  
FOR OFFICIAL USE ONLY



When Recorded Return Document to:

PAUL KLABACHA  
1 LIMESTONE COURT  
LEMONT, IL.  
60439

☐ Check here if this is a change of address.

Telephone: 312 316-7224

E-mail address: OCKINC@ATT.NET

**AFFIDAVIT OF PERFORMANCE OF ANNUAL WORK**

1. State of Arizona, County of YAVAPAI ss:

2. I (Name) PAUL KLABACHA

3. Reside at (Address) 1 LIMESTONE COURT

City LEMONT County COOK

State IL Zip 60439 being duly sworn, depose and say that I am a citizen of the United States, more than eighteen years of age, and that all of the facts set forth in this affidavit, subject to the provisions and penalties of 18 U.S.C. 1001 pertaining to the filing of false, fictitious, or fraudulent statements with the United States, are true and correct according to the best of my knowledge, information and belief.

4. Owner's name and address (If not shown in Items 1-3 above), \_\_\_\_\_

5. That I am personally acquainted with the mining claim(s). The work and improvements were made by and at the expense of the owner(s) of said claim(s). Said contiguous group of claims, listed on this document, are situated in the

(optional) Mining District: YAVAPAI County, Arizona.

Line No.	AMC NUMBER	CLAIM/SITE NAME	COUNTY RECORDER DATA (If available)	TWP	RNG	SEC
1	410881	SILVERSTONE	B 4882 P 905	11N	1W	2
2	411023	SILVERSTONE 1	B 4882 P 906	11N	1W	2
3	411024	SILVERSTONE 2	B 4882 P 907	11N	1W	2
4	411025	SILVERSTONE 3	B 4882 P 908	11N	1W	2
5	411026	SILVERSTONE 4	B 4882 P 909	11N	1W	2
6	411027	SILVERSTONE 5	B 4882 P 910	11N	1W	2

AFFIDAVIT OF PERFORMANCE OF ANNUAL WORK - page 2

RECEIVED  
BLM AZ STATE OFFICE  
2012 AUG 20 A 10:15  
PHOENIX, ARIZONA

BLM  
Date  
Stamp

7	411028	SILVERSTONE 6	B 4882 P 9/11	11N	1W	2
8	411029	SILVERSTONE 7	B 4882 P 9/12	11N	1W	2
9						
10						

6. That between the dates starting at 12 o'clock noon on September 1, 20 11 and ending at 12 o'clock noon on September 1, 20 12 at least \$ 1000.00 dollars worth of work and improvements were done and performed upon said claim(s) or upon one or more of a contiguous group of claims for the benefit of all, wholly or partly outside of a contiguous group of claims for the benefit of all, not including the location work.

7. That the following persons were employed to perform the work and improvements described herein: \_\_\_\_\_

PAUL KLABACHA KAREN KLABACHA ED DOMBROWSKI

8. That the work and improvements performed were: ROAD WORK, EXCAVATING,  
GEOPHYSICAL SURVEYING, PANNING, DETECTING,  
ECT.

9. Dated: 8-15-2012 Signature: Paul Klabacha

SUBSCRIBED AND SWORN TO before me, a Notary Public, this 15th day of August 20 12

By: Claudia C Rocio

Notary Public Claudia C Rocio

My Commission Expires 04/27/2014

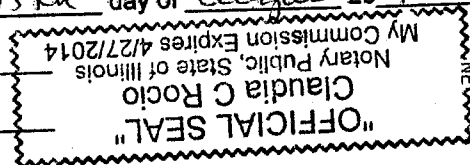

Bureau of Land Management  
Arizona State Office  
[www.az.blm.gov](http://www.az.blm.gov)

No. of Claims: 8 x \$10 = 80.00  
Check No.: 2959 Init. AA  
Receipt No.: 2635701  
For BLM Use Only

Form: MCF108  
Revised Jan. 2006  
Page 2 of 2



# United States Department of the Interior

## BUREAU OF LAND MANAGEMENT

Arizona State Office

One North Central Avenue, Suite 800

Phoenix, Arizona 85004-4427

[www.blm.gov/az/](http://www.blm.gov/az/)



May 2, 2012

In Reply Refer To:  
3800 (9310) TS  
AMC411023

COPY

CERTIFIED MAIL - RETURN RECEIPT REQUESTED No. 7011 2970 0001 8020 6192

### NOTICE

PAUL KLABACHA  
1 LIMESTONE CT  
LEMONT, IL 60439-2102

AMC411025 - AMC411029  
SILVERSTONE 3 - 7

RECEIVED  
BLM AZ STATE OFFICE  
2012 AUG 20 A 10:16  
PHOENIX, ARIZONA

### Mining Claim Location Notice(s) – Amendment(s) Required

Pursuant to Title 43 Code of Federal Regulations (CFR) 3832.1, this office received your notices of location for recording mining claims. In accordance with 43 CFR 3832.12, the claims listed above cannot be accepted as filed and must be amended as noted below.

Must file an amendment for AMC411025 – AMC411029 (Silverstone 4 – 7). AMC411025, AMC411026, AMC411028 & AMC411029 must reduce the size of the claims down to 1320' X 600'. You have lode dimensions (600' X 1500'). You can't increase the 600' to 660' because you would be taking in new ground. A typical 20 acre placer claim is 660' X 1320', all placer claims should be described by legal land description unless encumbered by private land or other encumbrance i.e. active unpatented mining claims. AMC411027 must reduce down to 1200' X 660'. In this case the claim is encumbered by a patented mining claim and is therefore ok to have the 1200'. All of the claims listed must have the dimensions in feet on the maps.

You must file an amendment for each claim listed above to correct the defects identified. There is a \$10 BLM processing fee for each amendment. We must receive the amendments within 30 days of your receipt of this notice. If the amendments are not received within the 30-day timeframe the mining claims will be declared null and void.



875-12

# CLAYBACK DEVELOPMENT, LLC

HELLO SUSIE,

FIRST TIME FILLING OUT THESE FORMS,  
HOPE I HAVE THEM CORRECT. AMENDED  
MY 8 SILVERSTONE CLAIMS IN MAY BY  
ORDER OF BLM AND HAD THEM RE-RECORDED.  
IF ANY CORRECTIONS NEED TO BE MADE  
PLEASE CONTACT ME DIRECTLY.

SINCERELY,

Paul Klabauch

312 316-7224

OCK INC @ ATT.NET

DO I NEED TO RECORD THIS?

RECEIVED  
BLM AZ STATE OFFICE  
2012 AUG 20 A 10:15  
PHOENIX, ARIZONA

CLAYBACK  
DEVELOPMENT, LLC

P.O. Box 21 • Lemont, IL 60439

RETURN RECEIPT  
REQUESTED

CERTIFIED MAIL™

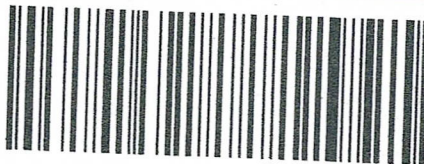

7011 2970 0003 0303 0086



UNITED STATES  
POSTAL SERVICE

1000



85004

U.S. POSTAGE  
PAID  
LEMONT, IL  
60439  
AUG 16, '12  
AMOUNT

\$5.95

00075387-03

BUREAU OF LAND MGMT.

ARIZONA STATE OFFICE

ONE NORTH CENTRAL AVE

SUITE 800

PHOENIX, ARIZONA 85004-4427

ATTN: SUSIE CRUZ

PHOENIX, ARIZONA

2012 AUG 20 A 10:00

RECEIVED  
STATE OFFICE

United States Department of the Interior  
Bureau of Land Management  
LANDS/RECREATION & PLANNING  
ONE N CENTRAL AVE  
PHOENIX, AZ 85004 -2203  
Phone: 602-417-9200

Receipt

No: 2635701

Transaction #: 2716277

Date of Transaction: 08/21/2012

## CUSTOMER:

PAUL KLABACHA  
1 LIMESTONE CT  
LEMONT,IL 60439-2102 US

LINE #	QTY	DESCRIPTION	REMARKS	UNIT PRICE	TOTAL
1	1.00	LOCATABLE MINERALS / MINING CLAIMS- NOT NEW-UNADJUD,ONE AUTH NO. ONLY / MINING CLAIM MONEY RECEIVED CASES: AMC410881/\$80.00	MAINT FEE WAIVER (8) 2013 / POL (8) 2012	- n/a -	80.00
TOTAL:					\$80.00

## PAYMENT INFORMATION

1	AMOUNT:	80.00	POSTMARKED:	N/A
	TYPE:	CHECK	RECEIVED:	08/20/2012
	CHECK NO:	2959		
	NAME:	CLAYBACK DEVELOPMENT 1 LIMESTONE CT LEMONT IL 60439-2102 US		

## REMARKS

This receipt was generated by the automated BLM Collections and Billing System and is a paper representation of a portion of the official electronic record contained therein.



**NOTICE!!**

**These documents have been scanned!**

**Do not place un-scanned documents beneath this notice!**

**Do not remove this notice from this file!**

GPO Jacket No. 560-102  
Print Order 61540  
Rise Business Services, LLC  
Job=AZ15 5/16/2019



Box Number= AZ15055



Claim Begin-End: AMC411023-AMC411029

6 Location Notices-Amendments and Supporting Documents



AZ15055-5

AMC410569-AMC411560

# MINING CLAIM STATUS REPORT

DATA ENTERED SEP 26 2011

MTP Checked by SC

GEO Checked by SC

LEAD SERIAL NUMBER AMC 411023

thru AMC 411029

## # OF CLAIMS & TYPE

# 7 LODE  
# 7 PLACER  
#        ASSOCIATION PLACER  
#        MILL SITE  
#        TUNNEL SITE

## CHARGES

Location Fee @ \$34 = \$ 238  
Processing Fee @ \$15 = \$ 105  
Maintenance Fee @ \$140 = \$ 980  
Overage (+) \$         
Shortage (-) \$         
Other Fees \$         
TOTAL \$ 1323

## ARE THERE ENOUGH LOCATORS?

Yes ☒ No ☐

## DOCUMENTS RECEIVED VIA -

Over-the-Counter ☒ Mail ☐

## TIMELY FILED?

Yes ☒ No ☐

## LEGAL DESCRIPTION -

T 11N R 01W SEC 002  
T        R        SEC         
T        R        SEC         
T        R        SEC       

BLM ☒ FOREST SERVICE ( ) PRESOTT

WILDERNESS AREA: No ☐ Yes ☐ SUBJ TO PL 359: Yes ☐ No ☐

SPLIT ESTATE - N/A ☐ SX ☐ PX ☐ SRHA ☐ OTHER ☐

Proper Notice Filed if Located on SHRA Lands? N/A ☐ Yes ☐ No ☐

RECONVEYED MINERALS ON BLM LANDS REQUIRE OPENING ORDERS FROM 1944 TO 1993 -  
Open to Entry on:        N/A ☐

COMMENTS/STATUS - VOID ☐ PARTIALLY VOID ☐ PVT MINERALS ☐ WITHDRAWN LANDS ☐

OTHER ( ) AMC 411027 Silverstone #5 claim is to width (only 660') amend  
also has 20.66 ac. (to much). AMC 411025-placer width should be 1320'x600' in this case?  
411026 - should rectangle unless encumbered  
Amend 411025,  
See attached notes (over) on the map.  
Claimant acknowledges that portions of the following claims(s) site(s) may be void or voidable.

Printed Name of Claimant       

Signature of Claimant       

## FINAL ADJUDICATION

DATE 4/19/2012 INITIALS TS



AMC411022

Must Amend AMC 411025 - 411029  
AMC 411025, 411026, 411028, & 411029  
must Amend the size of the claim  
down to 600' x 1320'. The legal  
description for a 20a placer is 660' x 1320'  
however in this case ~~the~~ 600' can't be  
increased to 660'

AMC 411027 must reduce down from  
1200' x 750' to ~~660~~ 1200' x 660'  
All placer claims should be described  
by L&O - either by rectangle or sq unless  
encumbered. i.e. AMC 411027. ~~You need~~  
The dominions in feet need to be on the  
map so the blm can determine the acreage



**United States Department of the Interior**  
**Bureau of Land Management**  
LANDS/RECREATION & PLANNING  
ONE N CENTRAL AVE  
PHOENIX, AZ 85004 -2203  
Phone: 602-417-9200

Receipt

No: 2575100

**Transaction #:** 2654579**Date of Transaction:** 05/24/2012

CUSTOMER:

PAUL KLABACHA  
1 LIMESTONE CT  
LEMONT,IL 60439-2102 US

LINE #	QTY	DESCRIPTION	REMARKS	UNIT PRICE	TOTAL
1	1.00	LOCATABLE MINERALS / MINING CLAIMS-NOT NEW-UNADJUD,ONE AUTH NO. ONLY / MINING CLAIM MONEY RECEIVED <b>CASES:</b> AMC410881/\$80.00	AMENDMENTS (8)	- n/a -	80.00
<b>TOTAL:</b>					<b>\$80.00</b>

PAYMENT INFORMATION					
1	AMOUNT:	80.00		POSTMARKED:	05/19/2012
	TYPE:	CHECK		RECEIVED:	05/24/2012
	CHECK NO:	8146			
	NAME:	OCK ELECTRIC INC 1 LIMESTONE CT LEMONT IL 60439-2102 US			

REMARKS

This receipt was generated by the automated BLM Collections and Billing System and is a paper representation of a portion of the official electronic record contained therein.

5-17-12

# CLAYBACK DEVELOPMENT, LLC

MR SMITH, 3800 (9310)TS AMC411023

THANK YOU FOR ASSISTANCE AMENDING  
THE SILVERSTONE PLACER CLAIMS, AS  
I OWN THE PATENTED FRANKLIN,  
UNION, AND KENDALL CLAIMS ADJOINING  
THE PLACER CLAIMS.

I PLAN TO RECORD ORIGINALS  
ON MAY 29-30. IF ANY ADJUST-  
MENTS ARE NECESSARY - PLEASE ADVISE.

THANK YOU,

*Paul Klabucka*

312 316-7224

RECEIVED  
BLM AZ STATE OFFICE  
2012 MAY 21 PM 2:59  
PHOENIX, ARIZONA

312-316-7224

CLAYBACK  
DEVELOPMENT, LLC

P.O. Box 21 • Lemont, IL 60439  
1 LIMESTONE CT.

S SUBURBAN IL 604

19 MAY 2012 PM 7 L

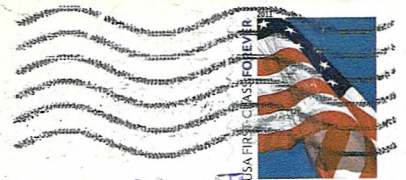

PHILADELPHIA, PENNSYLVANIA

2012 MAY 22 PM 2:06

RECEIVED  
BLM AZ STATE OFFICE

DEPT. OF THE INTERIOR  
BUREAU OF LAND MGMT.  
ONE NORTH CENTRAL AVE  
SUITE 800

PHOENIX, AZ. 85004-4427

ATTN: TONY SANTI

Paul Klabe ha  
sent <sup>that</sup> Amend without  
money. He sent check  
next day. <sup>in</sup>  
Will paperwork + 11  
check arrives.  
Thanks / any



AMC 411023

PAUL KLABACHA "SILVERSTONE 1" AMC 411023 AMENDMENT

LOCATION NOTICE FOR PLACER MINING CLAIM

NOTICE IS HEREBY GIVEN that the SILVERSTONE 1

\_\_\_\_\_ placer mining claim has been located by

PAUL KLABACHA whose current mailing

address is 1 LIMESTONE CT.

LEMON, IL. 60439

BLM  
Date  
Stamp

PHOENIX, ARIZONA

MAY 21 PM 3:00

RECEIVED  
BLM AZ STATE OFFICE

The general course of this claim is NORTH AND SOUTH and it is situated in

YAVAPAI County, Arizona.

This claim is 1400 feet in length and 600 feet in width. This claim runs from the location monument on which this location notice is posted approximately 1000 feet in a NORTH direction to the NORTH end line and 400 feet in a SOUTH direction to the SOUTH end line.

This claim is marked by four monuments, one at each corner of the claim.

The location monument on which this notice is posted is situated within Section 2, Township 11 N, Range 1 W, Gila Salt River Base and Meridian, Arizona. This claim encompasses

portions of the following legal subdivision(s) if located by legal subdivision or the following quarter section (s),

section (s), Township (s) and Range (s) NW 4

SEC 2 - T11N R1W, Gila Salt River Base and Meridian, Arizona.

The locality of this claim with reference to some natural object or permanent monument and additional information (if any) concerning its locality are as follows: 2" P.V.C.

DATED AND POSTED on the ground this 19 day of SEPT, 20 11

LOCATOR (s) Paul Klabacha

PAUL KLABACHA

Form MCF102  
Revised July 2005

AMC 411023

# MINING CLAIM MAP

Lode ( ) Placer (X)

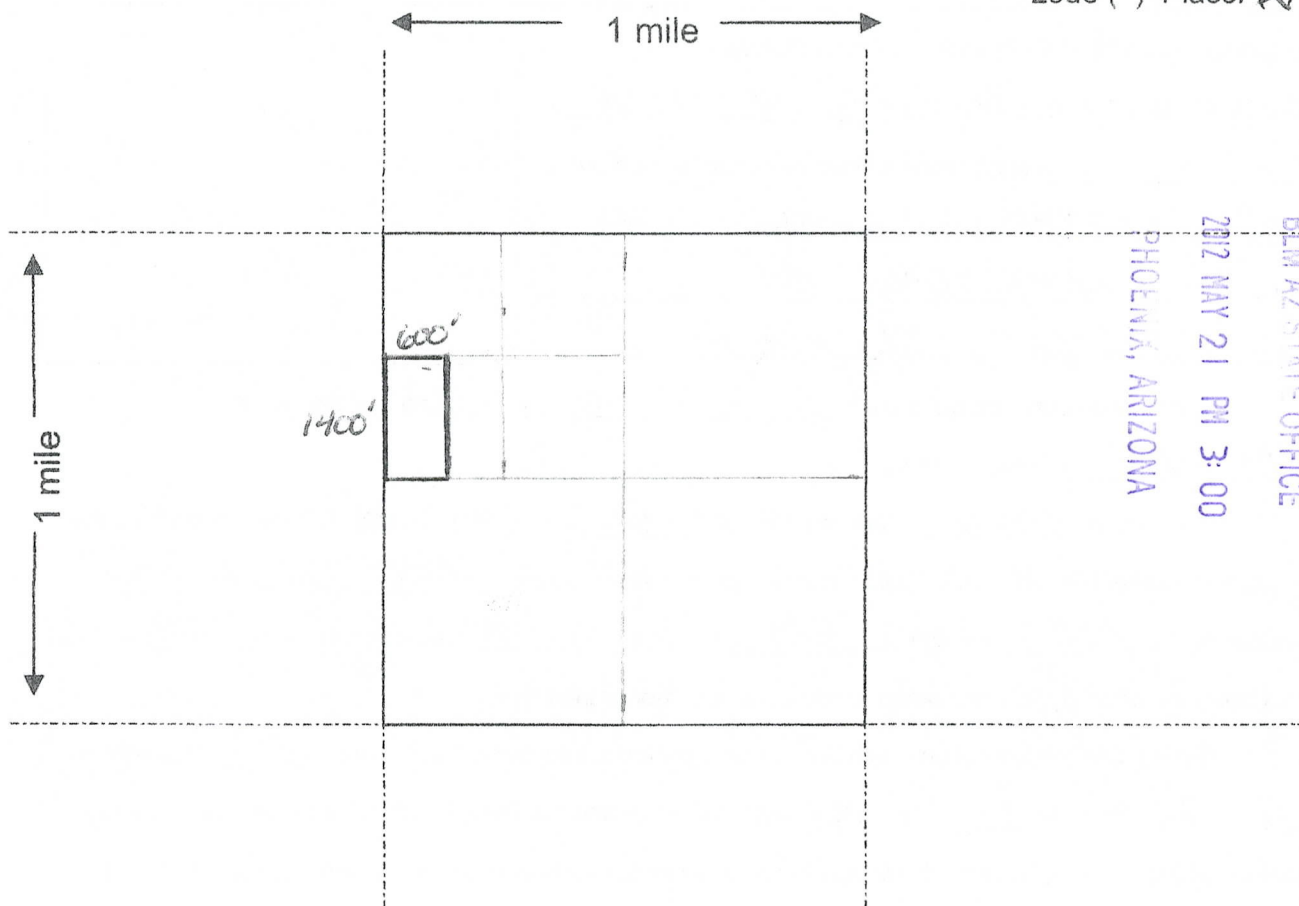

RECEIVED  
BLM AZ STATE OFFICE  
2012 MAY 21 PM 3:00  
PHOENIX, ARIZONA

Scale : 1" = 2000 feet



1. The above map depicts the SILVERSTONE 1 mining claim, which is located in Section (s) 2, Township 11 N, Range 1 W, Gila and Salt River Base and Meridian, \_\_\_\_\_ County, Arizona.

2. The type of corner and location monuments used are as follows: 2" P.V.C

3. The bearings and distances in degrees and feet between claim corners are as depicted on the map.

Form MCF100a  
Revised July 2005

This form is available from the Arizona Department of Mines & Mineral Resources and may be reproduced.

**LOCATION NOTICE FOR PLACER MINING CLAIM**

NOTICE IS HEREBY GIVEN that the SILVERSTONE 1

\_\_\_\_\_ placer mining claim has been located by

PAUL KLABACHA whose current mailing

address is 1 LIMBSTONE CT.

LEMONT, IL. 60439

BLM  
Date  
Stamp

PHOENIX, AZ

2011 SEP 22 P 2:56

RECEIVED  
BLM, AZ STATE OFFICE

The general course of this claim is NORTH AND SOUTH and it is situated in

YAVAPAI County, Arizona.

This claim is 1500 feet in length and 600 feet in width. This claim runs from the location monument on which this location notice is posted approximately 1000 feet in a NORTH direction to the NORTH end line and 500 feet in a SOUTH direction to the SOUTH end line.

This claim is marked by four monuments, one at each corner of the claim.

The location monument on which this notice is posted is situated within Section 2, Township 11 N, Range 1 W, Gila Salt River Base and Meridian, Arizona. This claim encompasses portions of the following legal subdivision(s) if located by legal subdivision or the following quarter section (s), section (s), Township (s) and Range (s) NW 4  
SC 2 T11N R61W, Gila Salt River Base and Meridian, Arizona.

The locality of this claim with reference to some natural object or permanent monument and additional information (if any) concerning its locality are as follows: 2" PVC

DATED AND POSTED on the ground this 19 day of SEPT, 20 11.

LOCATOR (s) NW Paul Klabacha

AMC411023



# MINING CLAIM MAP

Lode ( ) Placer (X)

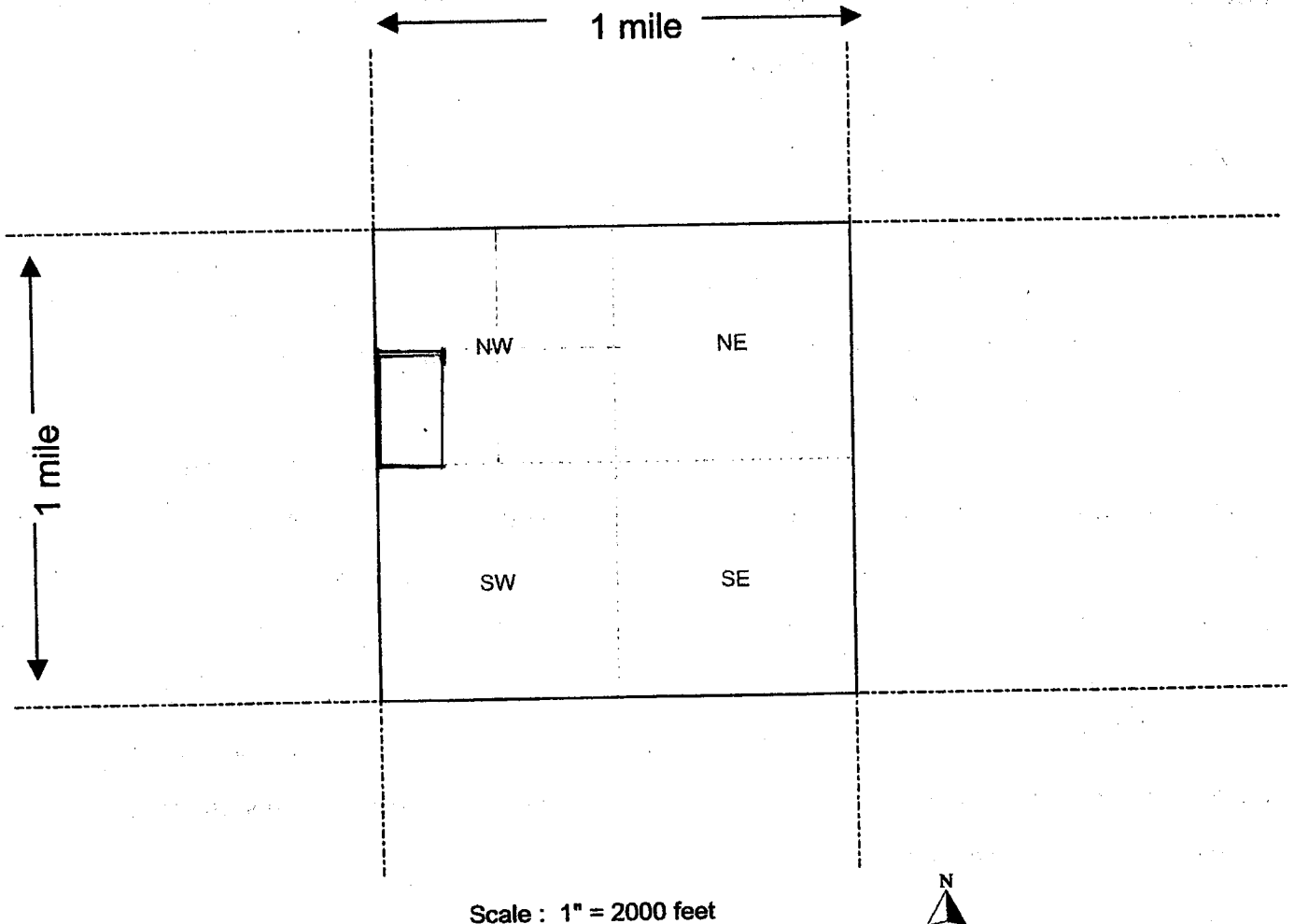

1. The above map depicts the SILVERSTONE 1 mining claim, which is located in Section (s) 2, Township 11 N, Range 1 W, Gila and Salt River Base and Meridian, YAVAPAI County, Arizona.

2. The type of corner and location monuments used are as follows: 2" PVC

3. The bearings and distances in degrees and feet between claim corners are as depicted on the map.

AMC 411023

PAUL KLABACHA 'SILVERSTONE 2' AMC 411024 AMENDMENT

LOCATION NOTICE FOR PLACER MINING CLAIM

NOTICE IS HEREBY GIVEN that the SILVERSTONE 2

\_\_\_\_\_ placer mining claim has been located by

PAUL KLABACHA whose current mailing

address is 1 LIMESTONE CT.

LEMON, IL. 60439

BLM Date Stamp	2012 MAY 21 PM 3:00 PHOENIX, ARIZONA
----------------------	---

RECEIVED  
BLM AZ STATE OFFICE

The general course of this claim is NORTH AND SOUTH and it is situated in

YAVAPAI County, Arizona.

This claim is 1400 feet in length and 600 feet in width. This claim runs from the location monument on which this location notice is posted approximately 300 feet in a NORTH direction to the NORTH end line and 1100 feet in a SOUTH direction to the SOUTH end line.

This claim is marked by four monuments, one at each corner of the claim.

The location monument on which this notice is posted is situated within Section 2, Township 11 N, Range 1 W, Gila Salt River Base and Meridian, Arizona. This claim encompasses portions of the following legal subdivision(s) if located by legal subdivision or the following quarter section (s), section (s), Township (s) and Range (s) NW 4  
SC 2 - TWIN - R G 1 W, Gila Salt River Base and Meridian, Arizona.

The locality of this claim with reference to some natural object or permanent monument and additional information (if any) concerning its locality are as follows: 2" P.V.C.

DATED AND POSTED on the ground this 19 day of SEPT., 20 11

LOCATOR (s)

Paul Klabacha  
PAUL KLABACHA

Form MCF102  
Revised July 2005

AMC 411024

# MINING CLAIM MAP

Lode ( ) Placer (X)

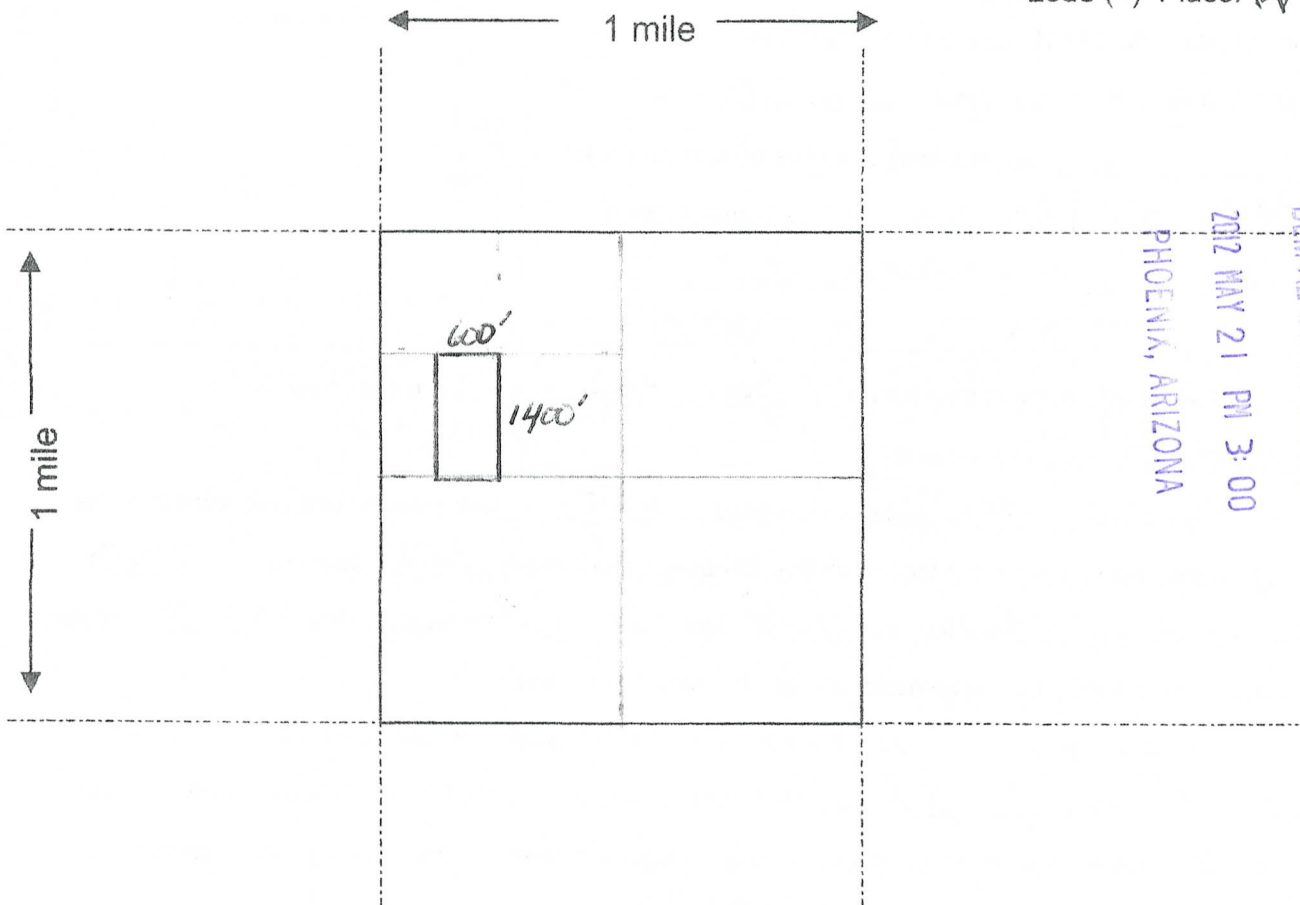

RECEIVED  
BLM AZ STATE OFFICE  
2012 MAY 21 PM 3:00  
PHOENIX, ARIZONA

Scale : 1" = 2000 feet



1. The above map depicts the SILVERSTONE 2 mining claim, which is located in Section (s) 2, Township 11 N, Range 1 W, Gila and Salt River Base and Meridian, YAVAPAI County, Arizona.

2. The type of corner and location monuments used are as follows: 2" P.V.C.

3. The bearings and distances in degrees and feet between claim corners are as depicted on the map.

Form MCF100a  
Revised July 2005

This form is available from the Arizona Department of Mines & Mineral Resources and may be reproduced.



**LOCATION NOTICE FOR PLACER MINING CLAIM**

NOTICE IS HEREBY GIVEN that the SILVERSTONE 2

\_\_\_\_\_ placer mining claim has been located by

PAUL KLABACHA whose current mailing

address is 1 LIMESTONE CT.

LEMONT, IL. 60439

BLM  
Date  
Stamp

PHOENIX, AZ

2011 SEP 22 P 2:56

RECEIVED  
BLM, AZ STATE OFFICE

The general course of this claim is NORTH AND SOUTH and it is situated in

YAVAPAI County, Arizona.

This claim is 1500 feet in length and 600 feet in width. This claim runs from the

location monument on which this location notice is posted approximately 300 feet in a NORTH  
direction to the NORTH end line and 1200 feet in a SOUTH direction to the SOUTH end line.

This claim is marked by four monuments, one at each corner of the claim.

The location monument on which this notice is posted is situated within Section 2, Township

11 N, Range 1 W, Gila Salt River Base and Meridian, Arizona. This claim encompasses  
portions of the following legal subdivision(s) if located by legal subdivision or the following quarter section (s),

section (s), Township (s) and Range (s) NW 4

SC 2 TWIN RAIL W, Gila Salt River Base and Meridian, Arizona.

The locality of this claim with reference to some natural object or permanent monument and additional  
information (if any) concerning its locality are as follows: 2" PVC

DATED AND POSTED on the ground this 19 day of SEPT, 20 11.

LOCATOR (s) Paul Klabacha

AMC411024

# MINING CLAIM MAP

Lode ( ) Placer (X)

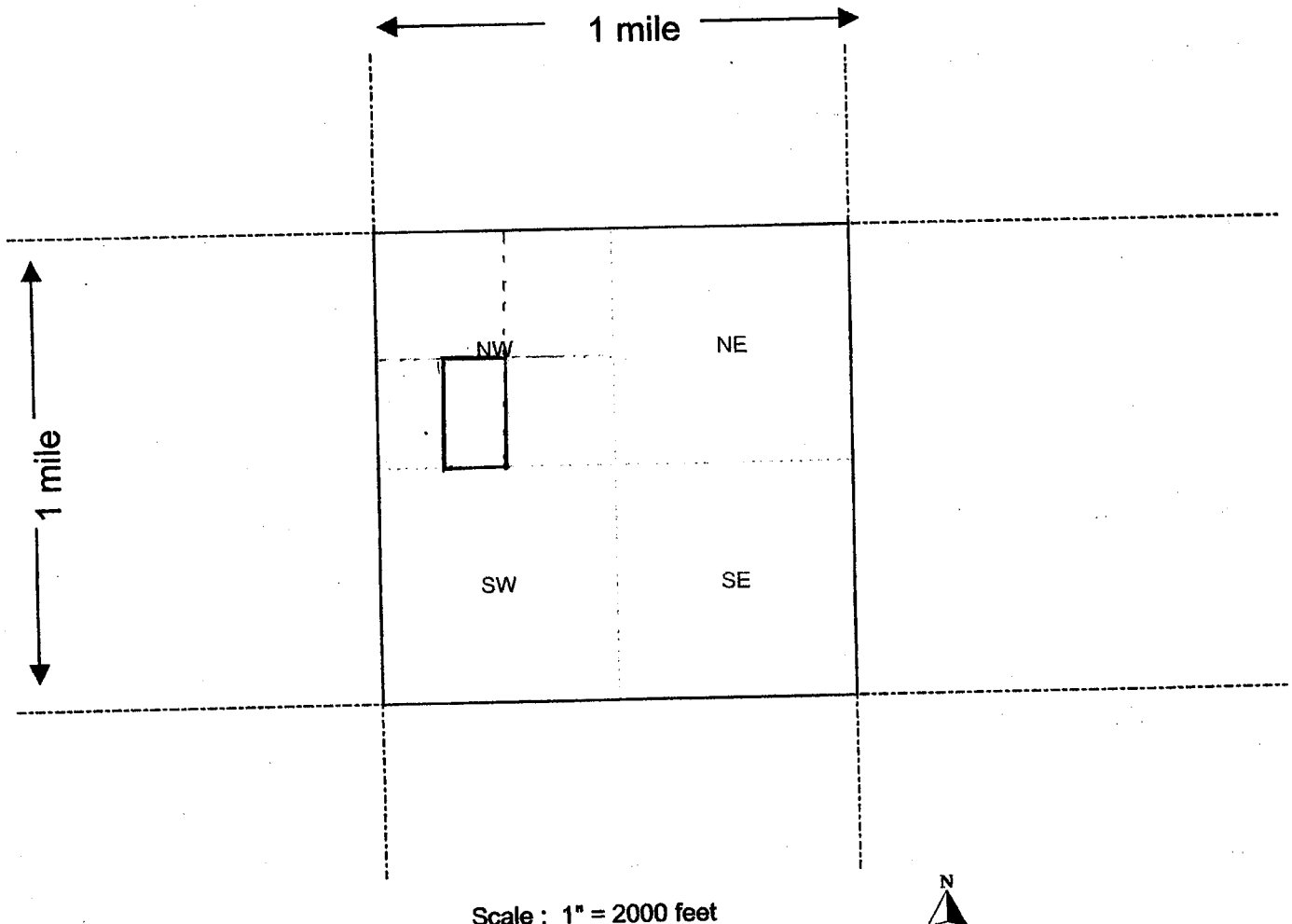

Scale : 1" = 2000 feet



1. The above map depicts the SILVERSTONE 2 mining claim, which is located in Section (s) 2, Township 11 N, Range 1 W, Gila and Salt River Base and Meridian, YAVAPAI County, Arizona.
2. The type of corner and location monuments used are as follows: 2" PVC
3. The bearings and distances in degrees and feet between claim corners are as depicted on the map.

PAUL KLABACHA 'SILVERSTONE 3' AMC 411025 AMENDMENT

LOCATION NOTICE FOR PLACER MINING CLAIM

NOTICE IS HEREBY GIVEN that the SILVERSTONE 3

\_\_\_\_\_ placer mining claim has been located by

PAUL KLABACHA whose current mailing

address is 1 LIMESTONE CT.

LEMONT, IL. 60439

BLM Date Stamp	2012 MAY 21 PM 3:00 PHOENIX, ARIZONA
----------------------	---

RECEIVED  
BLM AZ STATE OFFICE

The general course of this claim is EAST AND WEST and it is situated in

YAVAPAI County, Arizona.

This claim is 1400 feet in length and 600 feet in width. This claim runs from the location monument on which this location notice is posted approximately 750 feet in a WEST direction to the WEST end line and 650 feet in a EAST direction to the EAST end line.

This claim is marked by four monuments, one at each corner of the claim.

The location monument on which this notice is posted is situated within Section 2, Township 11 N, Range 1 W, Gila Salt River Base and Meridian, Arizona. This claim encompasses

portions of the following legal subdivision(s) if located by legal subdivision or the following quarter section (s),

section (s), Township (s) and Range (s) NW 4

SC 2 - TWIN - RG 1 W, Gila Salt River Base and Meridian, Arizona.

The locality of this claim with reference to some natural object or permanent monument and additional information (if any) concerning its locality are as follows: 2" P.V.C.

DATED AND POSTED on the ground this 19 day of SEPT, 20 11

LOCATOR (s) Paul Klabach

PAUL KLABACHA

Form MCF102  
Revised July 2005

This form is available from the Arizona Department of Mines & Mineral Resources and may be reproduced.

AMC 411025



# MINING CLAIM MAP

Lode ( ) Placer ☒

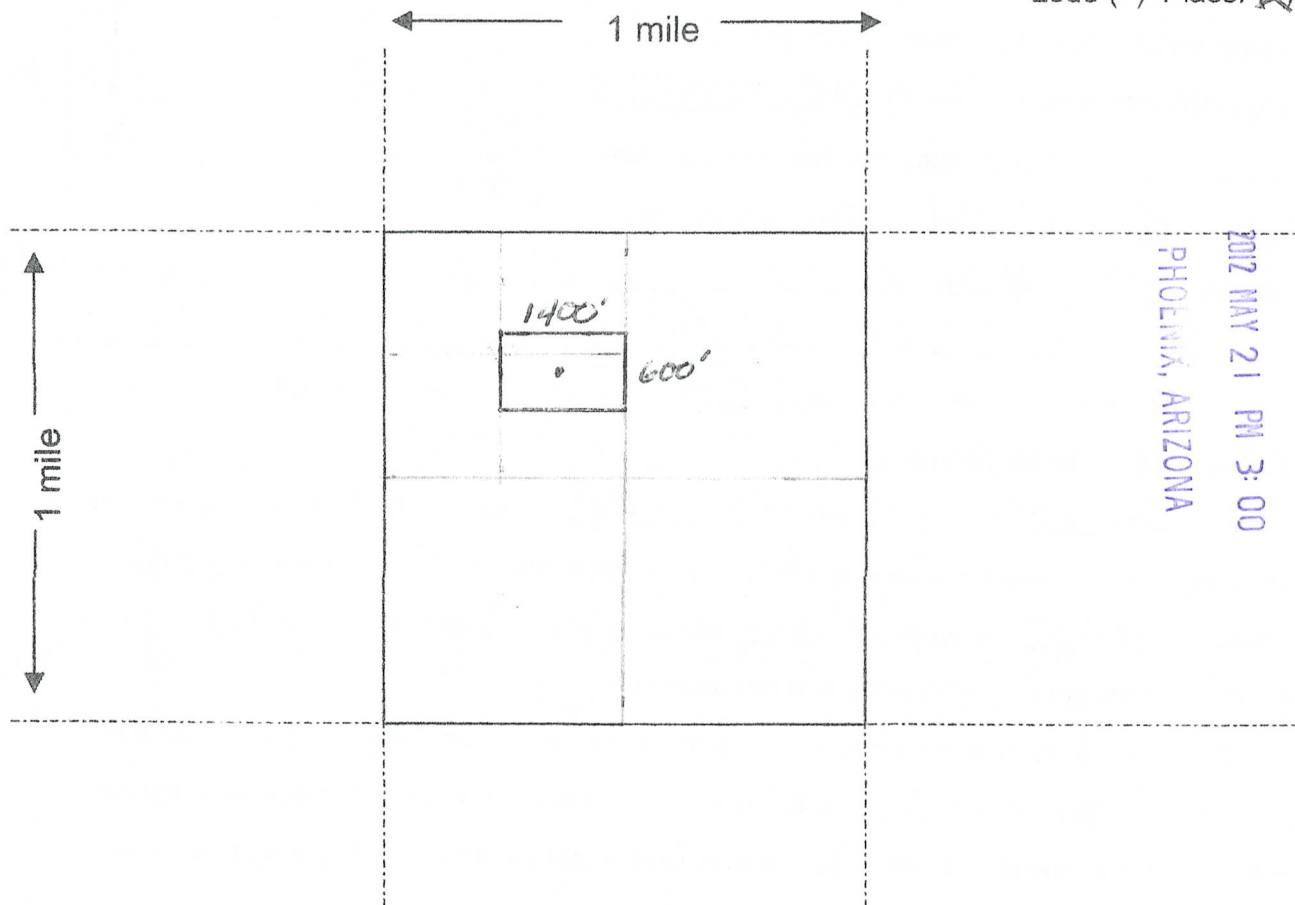

RECEIVED  
BLM AZ STATE OFFICE  
2012 MAY 21 PM 3:00  
PHOENIX, ARIZONA

Scale : 1" = 2000 feet



1. The above map depicts the SILVERSTONE 3 mining claim, which is located in Section (s) 2, Township 11 N, Range 1 W, Gila and Salt River Base and Meridian, YAVAPAI County, Arizona.

2. The type of corner and location monuments used are as follows: 2" P.V.C.

3. The bearings and distances in degrees and feet between claim corners are as depicted on the map.

Form MCF100a  
Revised July 2005

This form is available from the Arizona Department of Mines & Mineral Resources and may be reproduced.

**LOCATION NOTICE FOR PLACER MINING CLAIM**

NOTICE IS HEREBY GIVEN that the SILVERSTONE 3  
\_\_\_\_\_ placer mining claim has been located by  
PAUL KLABACHA whose current mailing  
address is 1 LIMESTONE CT,  
LEMONT, IL, 60439

BLM  
Date  
Stamp

PHOENIX, AZ

2011 SEP 22 P 2:55

RECEIVED  
BLM, AZ STATE OFFICE

The general course of this claim is EAST AND WEST and it is situated in  
YAVAPAI County, Arizona.

This claim is 600 feet in length and 1500 feet in width. This claim runs from the  
location monument on which this location notice is posted approximately 750 feet in a WEST  
direction to the WEST end line and 750 feet in a EAST direction to the EAST end line.  
This claim is marked by four monuments, one at each corner of the claim.

The location monument on which this notice is posted is situated within Section 2, Township  
11 N, Range 1 W, Gila Salt River Base and Meridian, Arizona. This claim encompasses  
portions of the following legal subdivision(s) if located by legal subdivision or the following quarter section (s),  
section (s), Township (s) and Range (s) NW 4  
SC 2 TWIN RG1W, Gila Salt River Base and Meridian, Arizona.

The locality of this claim with reference to some natural object or permanent monument and additional  
information (if any) concerning its locality are as follows: 2" PVC

DATED AND POSTED on the ground this 19 day of SEPT, 2011.

LOCATOR (s) Paul Klabacha

AMC411025

# MINING CLAIM MAP

Lode ( ) Placer (X)

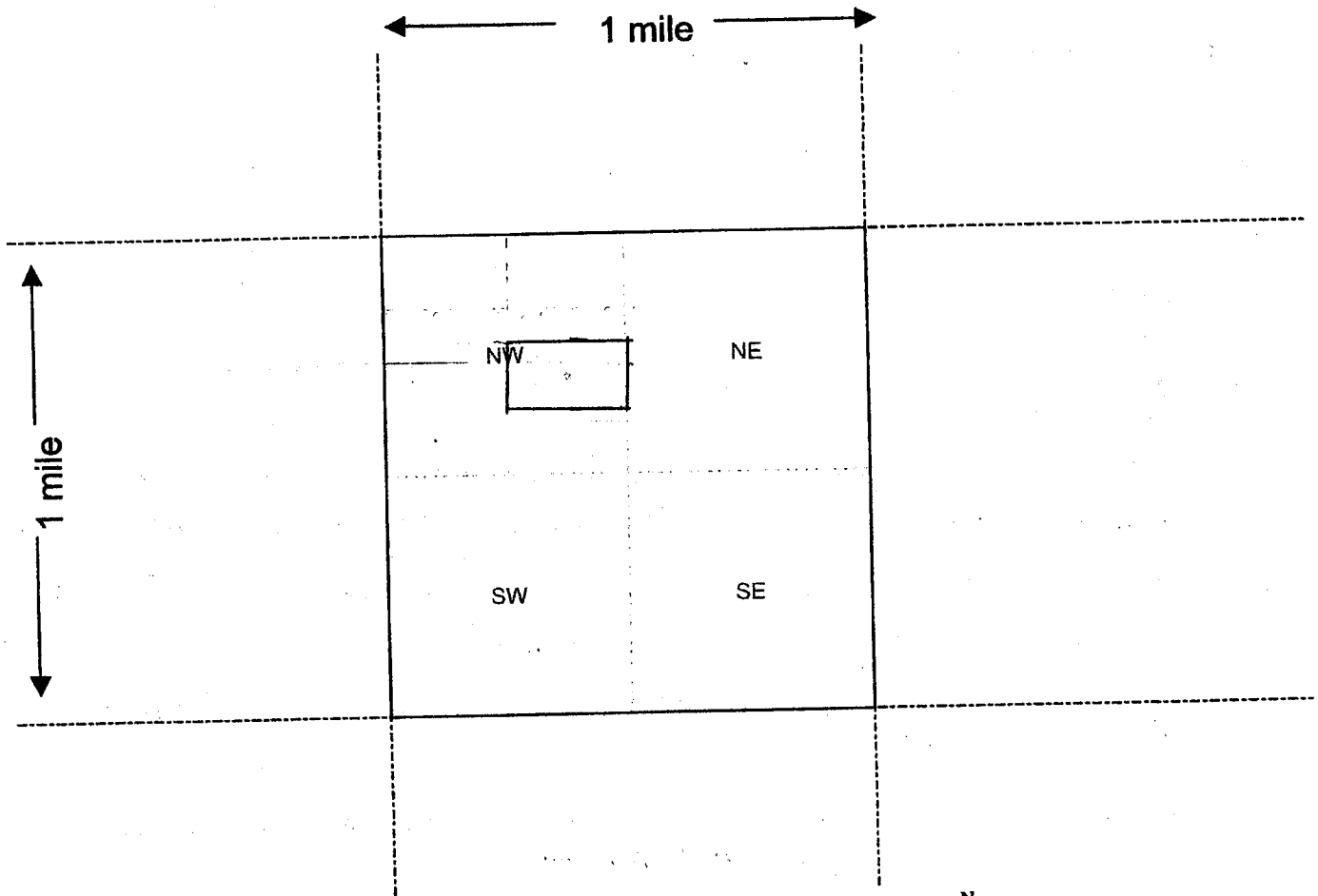

Scale : 1" = 2000 feet

1. The above map depicts the SILVERSTONE 3 mining claim, which is located in Section (s) 2, Township 11 N, Range 1 W, Gila and Salt River Base and Meridian, YAVAPAI County, Arizona.

2. The type of corner and location monuments used are as follows: 2" PVC

3. The bearings and distances in degrees and feet between claim corners are as depicted on the map.



PAUL KLABACHA 'SILVERSTONE 4' AMC 411026 AMENDMENT

LOCATION NOTICE FOR PLACER MINING CLAIM

NOTICE IS HEREBY GIVEN that the SILVERSTONE 4

\_\_\_\_\_ placer mining claim has been located by

PAUL KLABACHA whose current mailing

address is 1 LIMESTONE CT.

LEMONT, IL. 60439

BLM  
Date  
Stamp

PHOENIX, ARIZONA

2012 MAY 21 PM 3:00

RECEIVED  
BLM AZ STATE OFFICE

The general course of this claim is EAST AND WEST and it is situated in

YAVAPAI County, Arizona.

This claim is 1400 feet in length and 600 feet in width. This claim runs from the location monument on which this location notice is posted approximately 1300 feet in a WEST direction to the WEST end line and 100 feet in a EAST direction to the EAST end line.

This claim is marked by four monuments, one at each corner of the claim.

The location monument on which this notice is posted is situated within Section 2, Township 11 N, Range 1 W, Gila Salt River Base and Meridian, Arizona. This claim encompasses portions of the following legal subdivision(s) if located by legal subdivision or the following quarter section (s), section (s), Township (s) and Range (s) NW 4, NE 4  
SC 2 - T11N - R6W, Gila Salt River Base and Meridian, Arizona.

The locality of this claim with reference to some natural object or permanent monument and additional information (if any) concerning its locality are as follows: 2" P.W.C.

DATED AND POSTED on the ground this 19 day of SEPT, 20 11

LOCATOR (s)

Paul Klabacha  
PAUL KLABACHA

Form MCF102  
Revised July 2005

This form is available from the Arizona Department of Mines & Mineral Resources and may be reproduced.

AMC 411026

# MINING CLAIM MAP

Lode ( ) Placer (X)

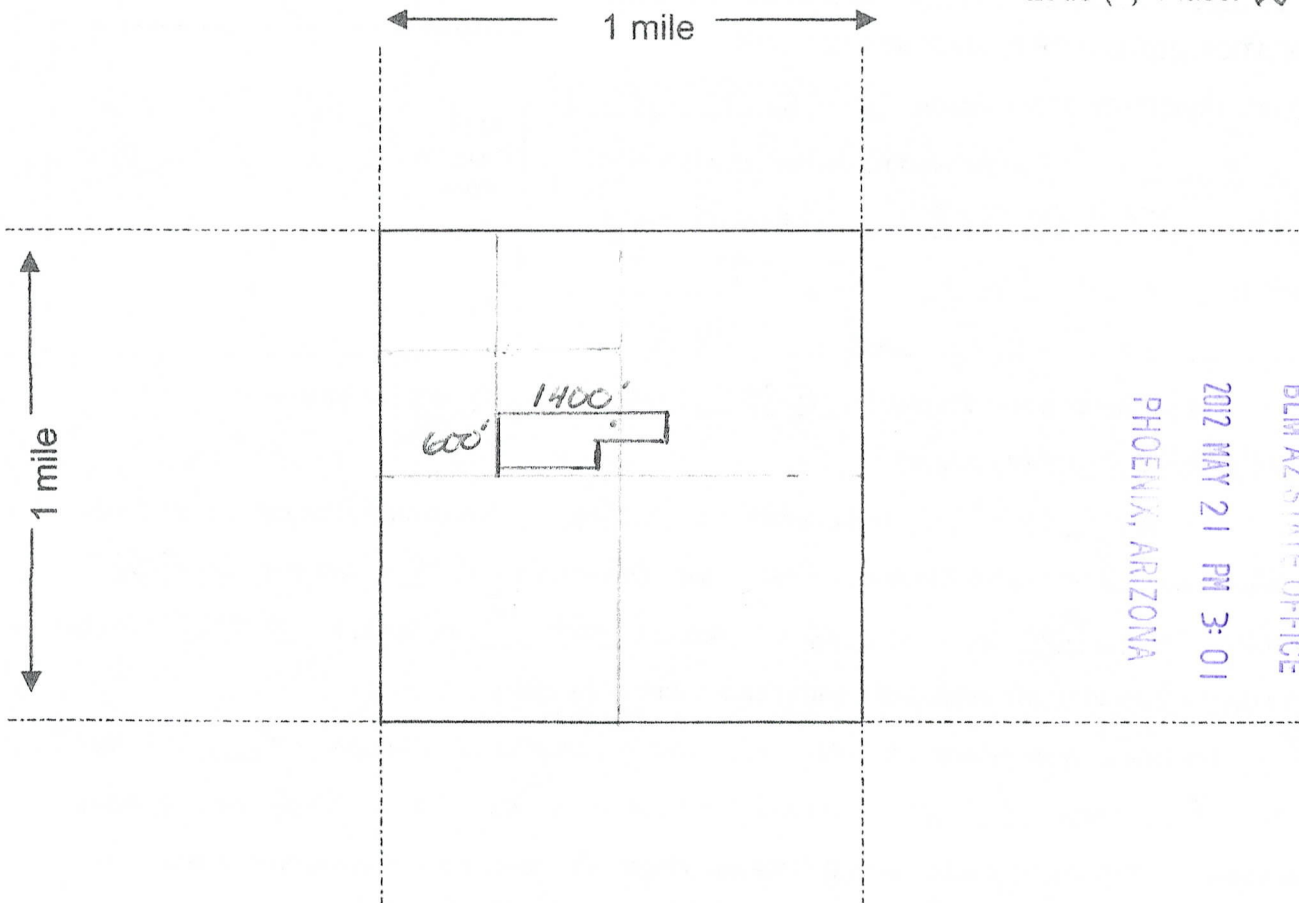

RECEIVED  
BLM AZ STATE OFFICE  
2012 MAY 21 PM 3:01  
PHOENIX, ARIZONA

Scale : 1" = 2000 feet



1. The above map depicts the SILVERSTONE 4 mining claim, which is located in Section (s) 2, Township 11 N, Range 1 W, Gila and Salt River Base and Meridian, YAVAPAI County, Arizona.

2. The type of corner and location monuments used are as follows: 2" P.V.C.

3. The bearings and distances in degrees and feet between claim corners are as depicted on the map.

Form MCF100a  
Revised July 2005

This form is available from the Arizona Department of Mines & Mineral Resources and may be reproduced.

**LOCATION NOTICE FOR PLACER MINING CLAIM**

NOTICE IS HEREBY GIVEN that the SILVERSTONE 4  
\_\_\_\_\_ placer mining claim has been located by  
PAUL KLABACHA whose current mailing  
address is 1 LIMESTONE CT  
LEMONT, IL 60439

BLM  
Date  
Stamp

PHOENIX, AZ

2011 SEP 22 P 2:55

RECEIVED  
B.L.M. AZ STATE OFFICE

The general course of this claim is EAST AND WEST and it is situated in  
YAVAPAI County, Arizona.

This claim is 500 feet in length and 1500 feet in width. This claim runs from the  
location monument on which this location notice is posted approximately 1300 feet in a WEST  
direction to the WEST end line and 200 feet in a EAST direction to the EAST end line.  
This claim is marked by four monuments, one at each corner of the claim.

The location monument on which this notice is posted is situated within Section 2, Township  
11 N, Range 1 W, Gila Salt River Base and Meridian, Arizona. This claim encompasses  
portions of the following legal subdivision(s) if located by legal subdivision or the following quarter section (s),  
section (s), Township (s) and Range (s) NW 4, NE 4  
SC 2-TW 11 N-R 1 W, Gila Salt River Base and Meridian, Arizona.

The locality of this claim with reference to some natural object or permanent monument and additional  
information (if any) concerning its locality are as follows: 2" PVC

DATED AND POSTED on the ground this 19 day of SEPT, 2011.

LOCATOR (s) Paul Klabacha

AMC411026



# MINING CLAIM MAP

Lode ( ) Placer (X)

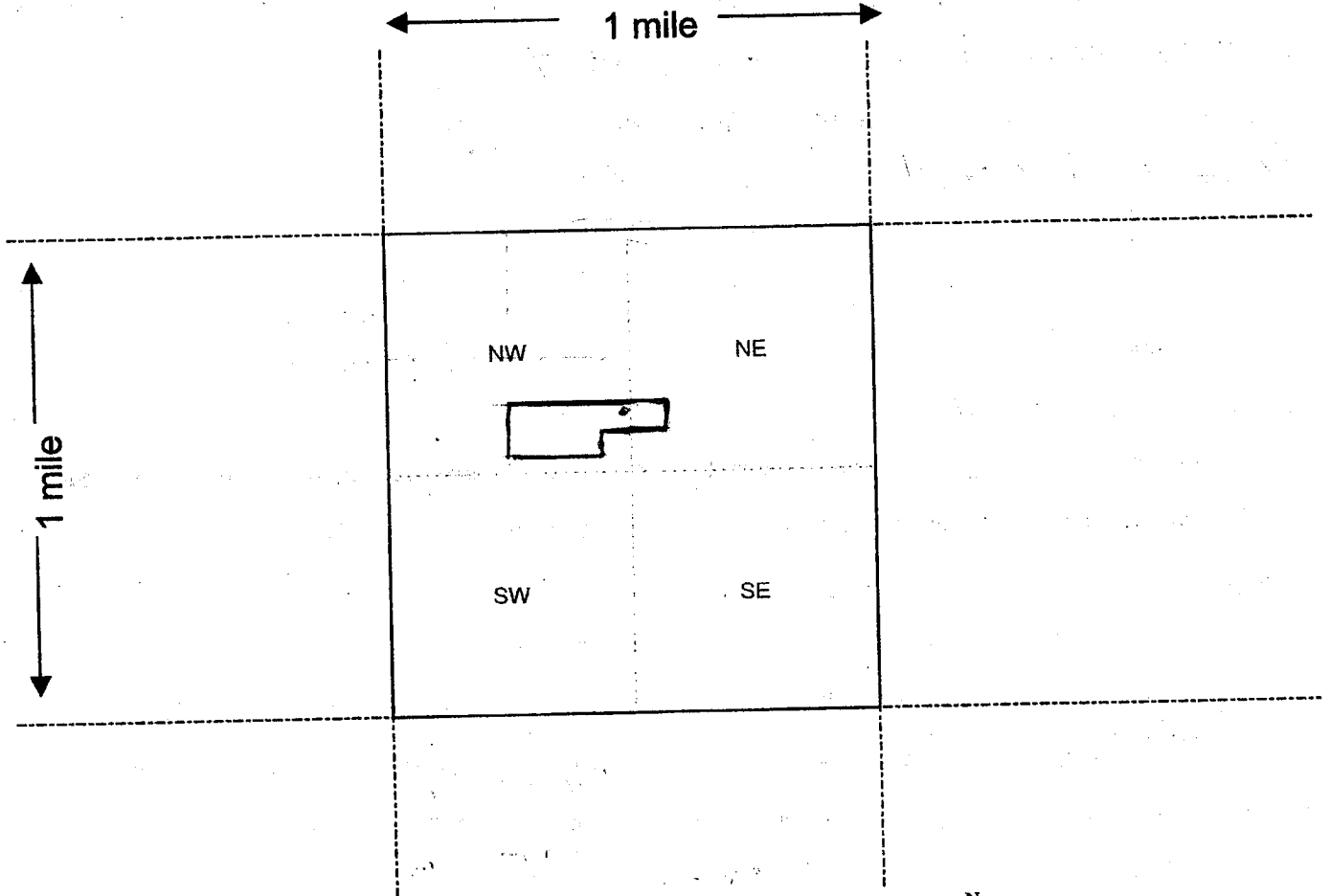

Scale : 1" = 2000 feet



1. The above map depicts the SILVERSTONE 4 mining claim, which is located in Section (s) 2, Township 11 N, Range 1 W, Gila and Salt River Base and Meridian, YAVAPAI County, Arizona.

2. The type of corner and location monuments used are as follows: 2" PVC

3. The bearings and distances in degrees and feet between claim corners are as depicted on the map.

PAUL KLABACHA 'SILVERSTONE 5' AMC 411027 AMENDMENT

LOCATION NOTICE FOR PLACER MINING CLAIM

NOTICE IS HEREBY GIVEN that the SILVERSTONE 5

\_\_\_\_\_ placer mining claim has been located by

PAUL KLABACHA whose current mailing

address is 1 LIMESTONE CT.

LEMONT IL. 60439

BLM  
Date  
Stamp

PHOENIX, ARIZONA

2012 MAY 21 PM 3:01

RECEIVED  
BLM AZ STATE OFFICE

The general course of this claim is EAST AND WEST and it is situated in  
YAVAPAI County, Arizona.

This claim is 1200 feet in length and 660 feet in width. This claim runs from the  
location monument on which this location notice is posted approximately 500 feet in a WEST  
direction to the WEST end line and 700 feet in a EAST direction to the EAST end line.  
This claim is marked by four monuments, one at each corner of the claim.

The location monument on which this notice is posted is situated within Section 2, Township  
11 N, Range 1 W, Gila Salt River Base and Meridian, Arizona. This claim encompasses  
portions of the following legal subdivision(s) if located by legal subdivision or the following quarter section (s),  
section (s), Township (s) and Range (s) NE 4 SE 4  
SEC 2 - T11N - R61W, Gila Salt River Base and Meridian, Arizona.

The locality of this claim with reference to some natural object or permanent monument and additional  
information (if any) concerning its locality are as follows: 2" P.V.C.

DATED AND POSTED on the ground this 19 day of SEPT, 20 11

LOCATOR (s) Paul Klabacha  
PAUL KLABACHA

Form MCF102  
Revised July 2005

This form is available from the Arizona Department of Mines & Mineral Resources and may be reproduced.

Amc 411027

# MINING CLAIM MAP

Lode ( ) Placer ☒

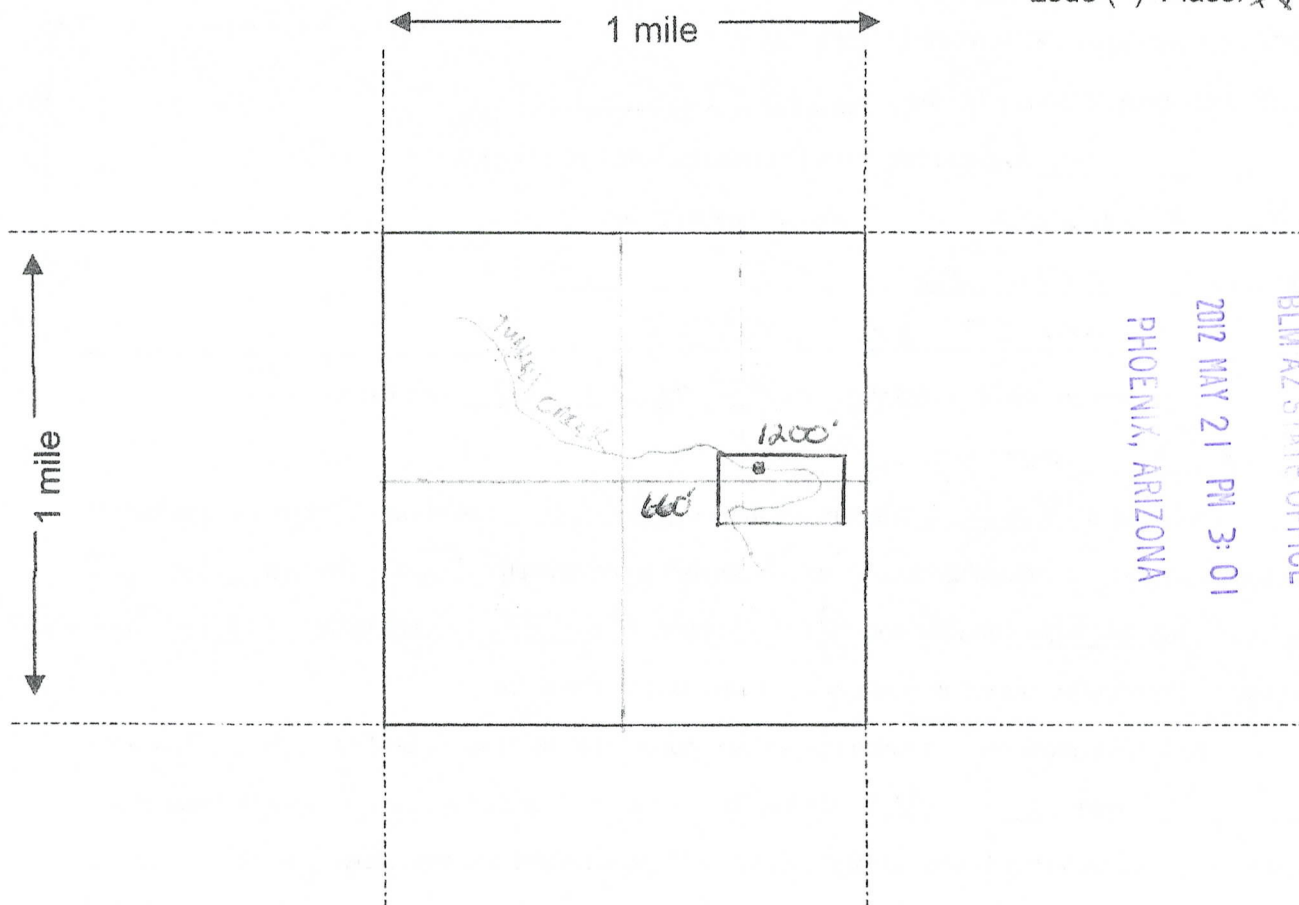

RECEIVED  
BLM AZ STATE OFFICE  
2012 MAY 21 PM 3:01  
PHOENIX, ARIZONA

Scale : 1" = 2000 feet



1. The above map depicts the SILVERSTONE 5 mining claim, which is located in Section (s) 2, Township 11 N, Range 1 W, Gila and Salt River Base and Meridian, YAVAPAI County, Arizona.

2. The type of corner and location monuments used are as follows: 2" P.V.C.

3. The bearings and distances in degrees and feet between claim corners are as depicted on the map.

Form MCF100a  
Revised July 2005

This form is available from the Arizona Department of Mines & Mineral Resources and may be reproduced.



LOCATION NOTICE FOR PLACER MINING CLAIM

NOTICE IS HEREBY GIVEN that the SILVERSTONE 5

\_\_\_\_\_ placer mining claim has been located by

PAUL KLABACHA whose current mailing

address is 1 LIMESTONE CT.

LEMONT, IL. 60439

BLM  
Date  
Stamp

PHOENIX, AZ

2011 SEP 22 P 2:55

RECEIVED  
BLM, AZ STATE OFFICE

The general course of this claim is EAST AND WEST and it is situated in  
YAVAPAI County, Arizona.

This claim is 1200 feet in length and 750 feet in width. This claim runs from the  
location monument on which this location notice is posted approximately 500 feet in a WEST  
direction to the WEST end line and 300 feet in a EAST direction to the EAST end line.  
This claim is marked by four monuments, one at each corner of the claim.

The location monument on which this notice is posted is situated within Section 2, Township  
11 N, Range 1 W, Gila Salt River Base and Meridian, Arizona. This claim encompasses  
portions of the following legal subdivision(s) if located by legal subdivision or the following quarter section (s),  
section (s), Township (s) and Range (s) NE 4 SE 4  
S2 2 TWIN RG1W, Gila Salt River Base and Meridian, Arizona.

The locality of this claim with reference to some natural object or permanent monument and additional  
information (if any) concerning its locality are as follows: 2" PVC

DATED AND POSTED on the ground this 19 day of SEPT, 20 11.

LOCATOR (s) Paul Klabacha

AMC411021

# MINING CLAIM MAP

Lode ( ) Placer (X)

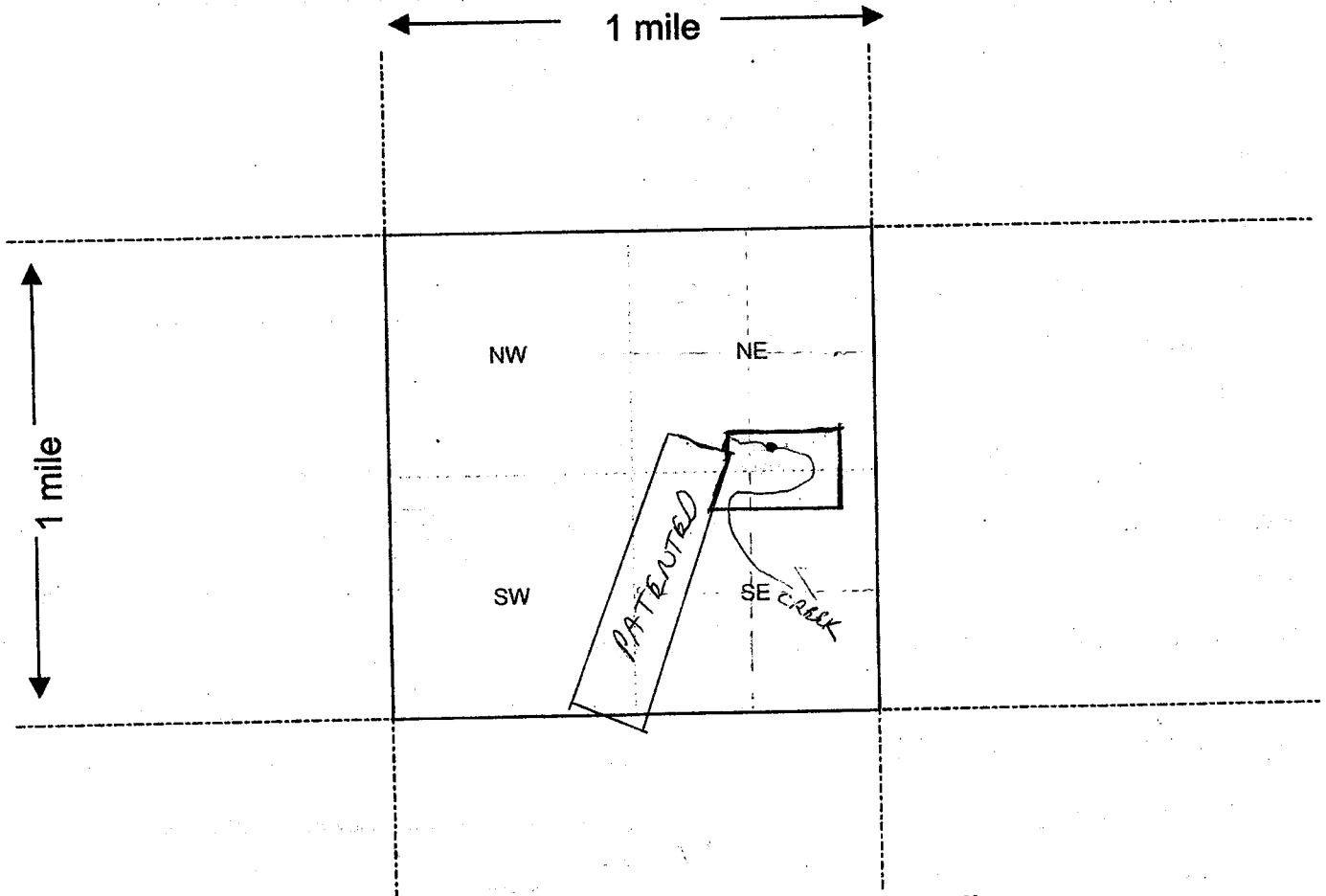

Scale : 1" = 2000 feet



1. The above map depicts the SILVERSTONE mining claim, which is located in Section (s) 2, Township 11 N, Range 1 W, Gila and Salt River Base and Meridian, YAVAPAI County, Arizona.

2. The type of corner and location monuments used are as follows: 2" PVC

3. The bearings and distances in degrees and feet between claim corners are as depicted on the map.

PAUL KLABACHA SILVERSTONE 6' AMC 411028 AMENDMENT

LOCATION NOTICE FOR PLACER MINING CLAIM

NOTICE IS HEREBY GIVEN that the SILVERSTONE 6

\_\_\_\_\_ placer mining claim has been located by

PAUL KLABACHA whose current mailing

address is 1 LIMESTONE CT.

LEMONT, IL. 60439

BLM  
Date  
Stamp

PHOENIX, ARIZONA

2012 MAY 21 PM 3:01

RECEIVED  
BLM AZ OFFICE

The general course of this claim is NORTH AND SOUTH and it is situated in

YAVAPAI County, Arizona.

This claim is 1400 feet in length and 600 feet in width. This claim runs from the location monument on which this location notice is posted approximately 200 feet in a NORTH direction to the NORTH end line and 1200 feet in a SOUTH direction to the SOUTH end line. This claim is marked by four monuments, one at each corner of the claim.

The location monument on which this notice is posted is situated within Section 2, Township 11 N, Range 1 W, Gila Salt River Base and Meridian, Arizona. This claim encompasses portions of the following legal subdivision(s) if located by legal subdivision or the following quarter section (s), section (s), Township (s) and Range (s) SE 4

SC2-TW11N-R01W, Gila Salt River Base and Meridian, Arizona.

The locality of this claim with reference to some natural object or permanent monument and additional information (if any) concerning its locality are as follows: 2" P.V.C.

DATED AND POSTED on the ground this 19 day of SEPT, 2011.

LOCATOR (s)

Paul Klabacha  
PAUL KLABACHA

Form MCF102  
Revised July 2005

This form is available from the Arizona Department of Mines & Mineral Resources and may be reproduced.

AMC 411028



# MINING CLAIM MAP

Lode ( ) Placer ( )

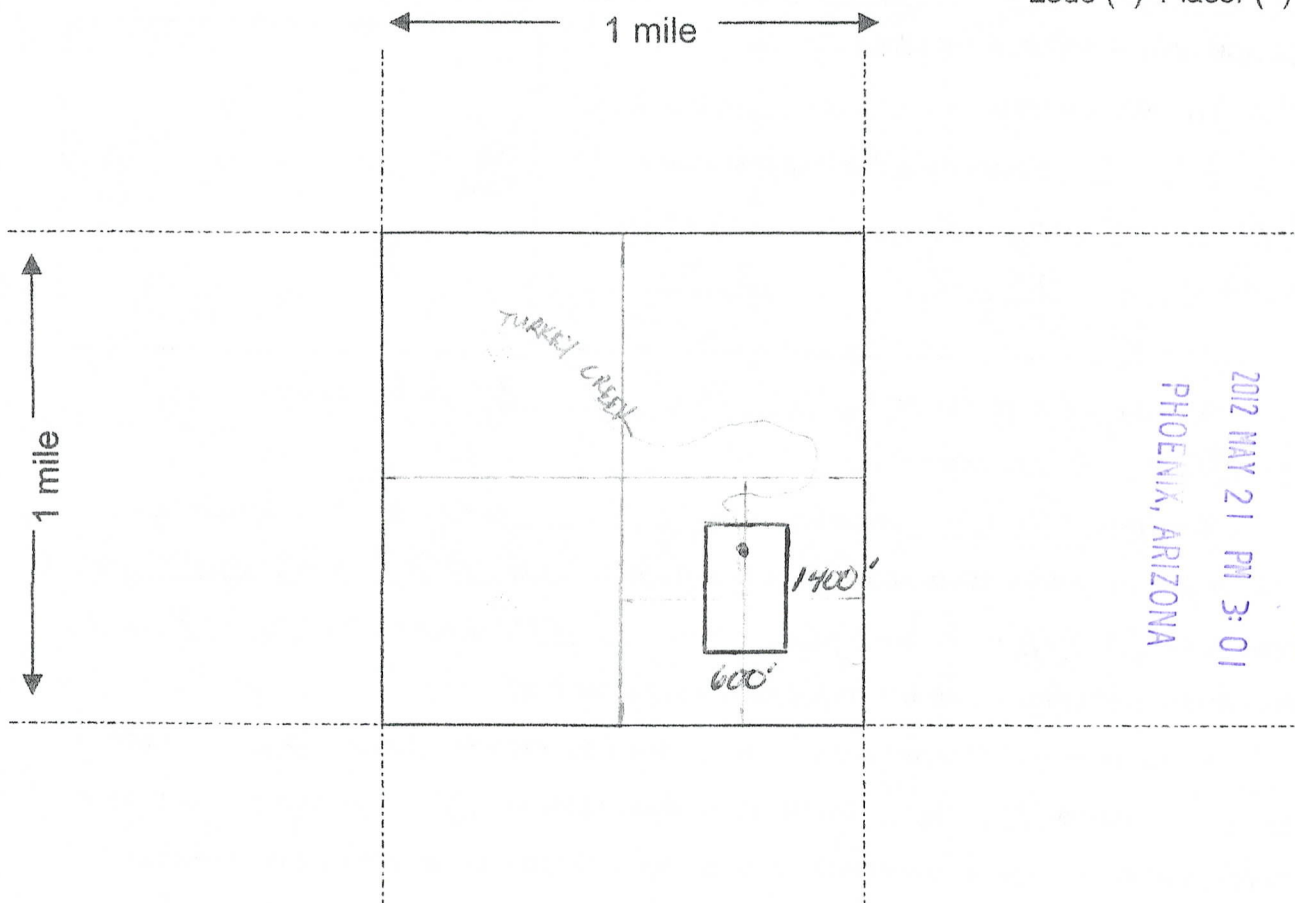

RECEIVED  
BLM AZ STATE OFFICE  
2012 MAY 21 PM 3:01  
PHOENIX, ARIZONA

Scale : 1" = 2000 feet



1. The above map depicts the SILVERSTONE 6 mining claim, which is located in Section (s) 2, Township 11 N, Range 1 W, Gila and Salt River Base and Meridian, YAVAPAI County, Arizona.

2. The type of corner and location monuments used are as follows: 2" P.V.C.

3. The bearings and distances in degrees and feet between claim corners are as depicted on the map.

Form MCF100a  
Revised July 2005

This form is available from the Arizona Department of Mines & Mineral Resources and may be reproduced.

**LOCATION NOTICE FOR PLACER MINING CLAIM**

NOTICE IS HEREBY GIVEN that the SILVERSTONE 6

\_\_\_\_\_ placer mining claim has been located by

PAUL KLABACHA whose current mailing

address is 1 LIMESTONE CT.

LEMONT, IL. 60439

BLM  
Date  
Stamp

PHOENIX, AZ

2011 SEP 22 P 2:55

RECEIVED  
BLM, AZ STATE OFFICE

The general course of this claim is NORTH AND SOUTH and it is situated in  
YAVAPAI County, Arizona.

This claim is 1500 feet in length and 600 feet in width. This claim runs from the  
location monument on which this location notice is posted approximately 200 feet in a NORTH  
direction to the NORTH end line and 1300 feet in a SOUTH direction to the SOUTH end line.  
This claim is marked by four monuments, one at each corner of the claim.

The location monument on which this notice is posted is situated within Section 2, Township  
11 N, Range 1 W, Gila Salt River Base and Meridian, Arizona. This claim encompasses  
portions of the following legal subdivision(s) if located by legal subdivision or the following quarter section (s),  
section (s), Township (s) and Range (s) SE 4  
SC2 TW 11N RG 1W, Gila Salt River Base and Meridian, Arizona.

The locality of this claim with reference to some natural object or permanent monument and additional  
information (if any) concerning its locality are as follows: 2" PVC

DATED AND POSTED on the ground this 19 day of SEPT, 20 11.

LOCATOR (s) Paul Klabacha

AMC411028

# MINING CLAIM MAP

Lode ( ) Placer ☒

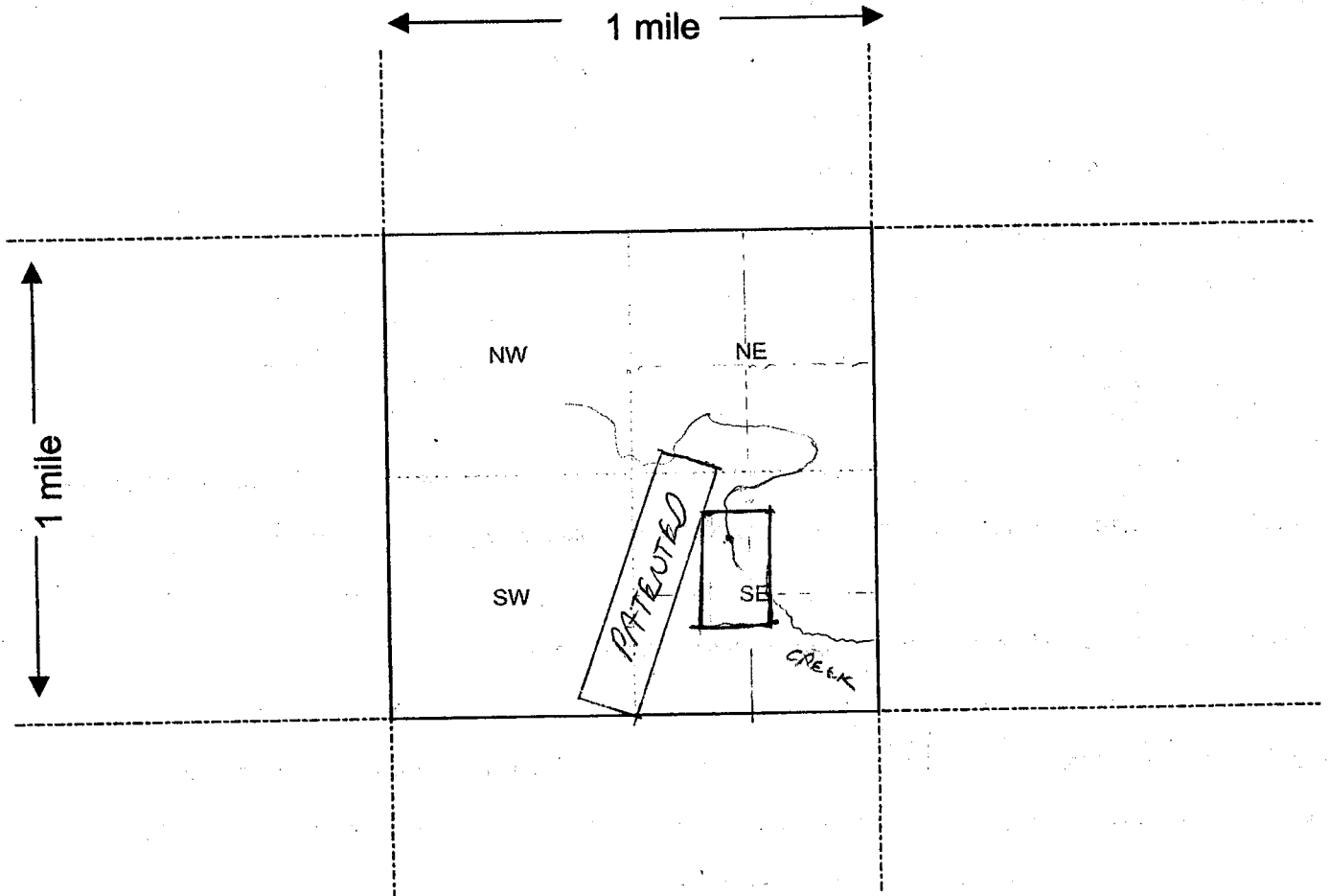

Scale : 1" = 2000 feet



- The above map depicts the SILVERSTONE 6 mining claim, which is located in Section (s) 2, Township 11 N, Range 1 W, Gila and Salt River Base and Meridian, YAVAPAI County, Arizona.
- The type of corner and location monuments used are as follows: 2" PVC
- The bearings and distances in degrees and feet between claim corners are as depicted on the map.



**LOCATION NOTICE FOR PLACER MINING CLAIM**

NOTICE IS HEREBY GIVEN that the SILVERSTONE 7  
\_\_\_\_\_ placer mining claim has been located by  
PAUL KLABACHA whose current mailing  
address is 1 LIMESTONE CT,  
LEMONT, IL. 60439

BLM  
Date  
Stamp

PHOENIX, AZ

2011 SEP 22 P 2:55

RECEIVED  
BLM, AZ STATE OFFICE

The general course of this claim is EAST AND WEST and it is situated in  
YAVAPAI County, Arizona.

This claim is 1500 feet in length and 1500 feet in width. This claim runs from the  
location monument on which this location notice is posted approximately 750 feet in a WEST  
direction to the WEST end line and 750 feet in a EAST direction to the EAST end line.  
This claim is marked by four monuments, one at each corner of the claim.

The location monument on which this notice is posted is situated within Section 2, Township  
11 N, Range 1 W, Gila Salt River Base and Meridian, Arizona. This claim encompasses  
portions of the following legal subdivision(s) if located by legal subdivision or the following quarter section (s),  
section (s), Township (s) and Range (s) SE 4  
SC 2 TWIN RG 1 W, Gila Salt River Base and Meridian, Arizona.

The locality of this claim with reference to some natural object or permanent monument and additional  
information (if any) concerning its locality are as follows: 2" PVC

DATED AND POSTED on the ground this 19 day of SEPT, 20 11.

LOCATOR (s) Paul Klabacha

AMC411029

# MINING CLAIM MAP

Lode ( ) Placer ☒

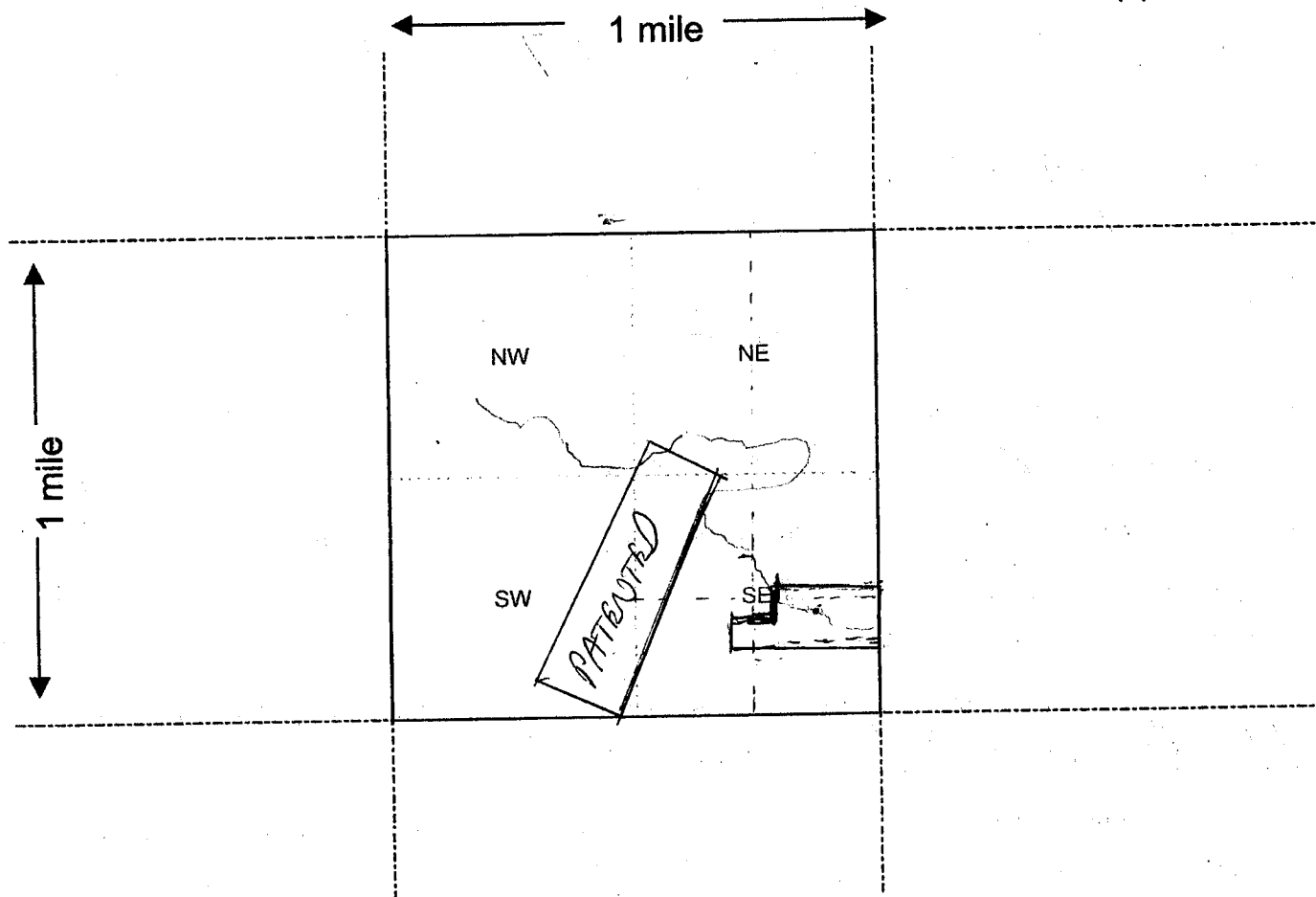

Scale : 1" = 2000 feet



1. The above map depicts the SILVERSTONE 7 mining claim, which is located in Section (s) 2, Township 11 N, Range 1 W, Gila and Salt River Base and Meridian, YAVAPAI County, Arizona.

2. The type of corner and location monuments used are as follows: 2" PVC

3. The bearings and distances in degrees and feet between claim corners are as depicted on the map.

PAUL KLABACHA 'SILVERSTONE 7' AMC 411029 AMENDMENT

LOCATION NOTICE FOR PLACER MINING CLAIM

NOTICE IS HEREBY GIVEN that the SILVERSTONE 7

\_\_\_\_\_ placer mining claim has been located by

PAUL KLABACHA whose current mailing

address is 1 LIMESTONE CT.

LEMONT, IL. 60439

BLM  
Date  
Stamp

RECEIVED  
BLM AZ STATE OFFICE  
2012 MAY 21 PM 3:01  
PHOENIX, ARIZONA

The general course of this claim is EAST AND WEST and it is situated in

YAVAPAI County, Arizona.

This claim is 1400 feet in length and 600 feet in width. This claim runs from the location monument on which this location notice is posted approximately 700 feet in a WEST direction to the WEST end line and 700 feet in a EAST direction to the EAST end line. This claim is marked by four monuments, one at each corner of the claim.

The location monument on which this notice is posted is situated within Section 2, Township 11 N, Range 1 W, Gila Salt River Base and Meridian, Arizona. This claim encompasses portions of the following legal subdivision(s) if located by legal subdivision or the following quarter section (s), section (s), Township (s) and Range (s) SE 4  
SC 2 - TWIN-RG 1 W, Gila Salt River Base and Meridian, Arizona.

The locality of this claim with reference to some natural object or permanent monument and additional information (if any) concerning its locality are as follows: 2" P.V.C.

DATED AND POSTED on the ground this 19 day of SEPT, 20 11

LOCATOR (s)

Paul Klabacha

PAUL KLABACHA

Form MCF102  
Revised July 2005

This form is available from the Arizona Department of Mines & Mineral Resources and may be reproduced.

AMC 411029



# MINING CLAIM MAP

Lode ( ) Placer ( )

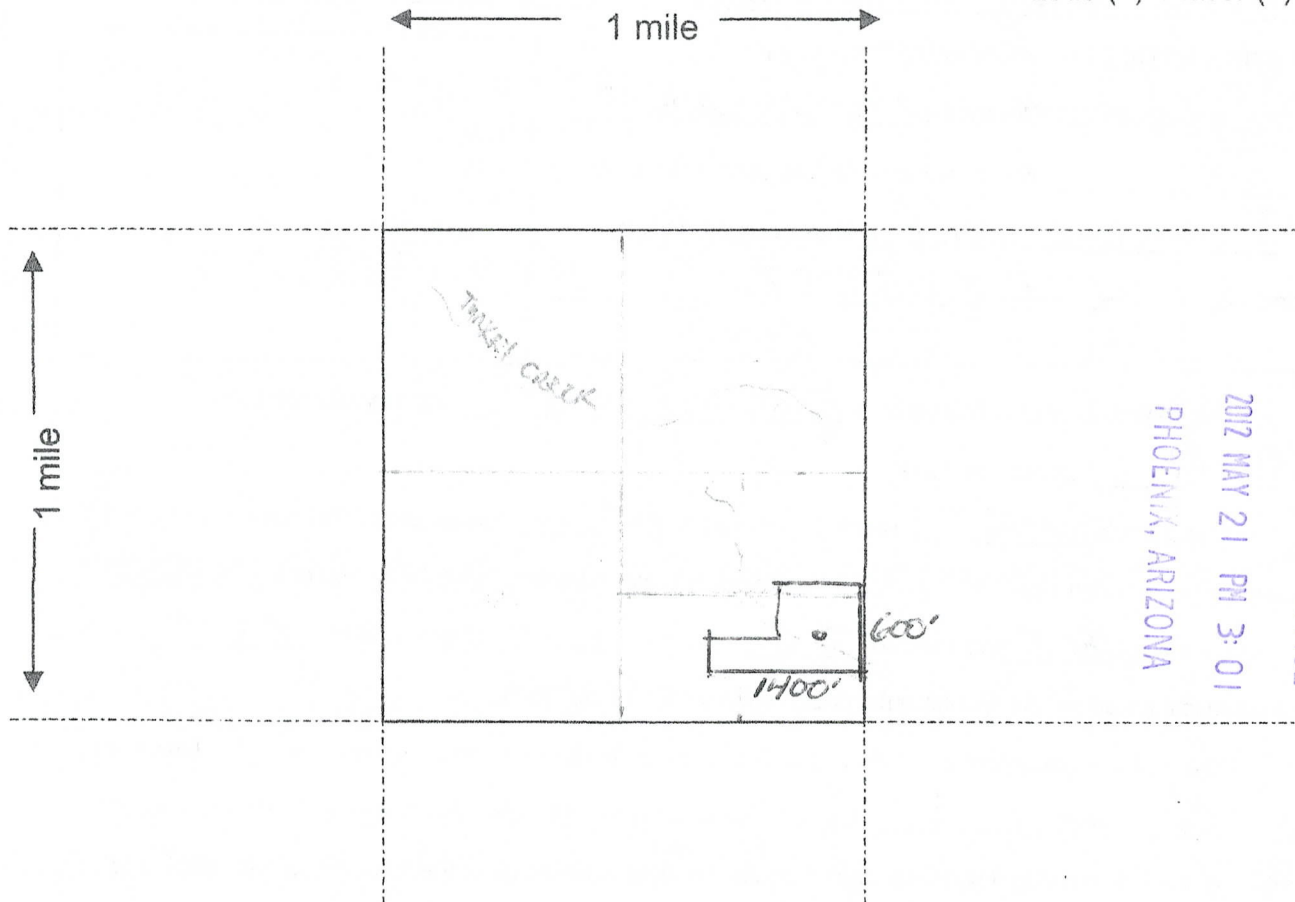

RECEIVED  
BLM AZ STATE OFFICE  
2012 MAY 21 PM 3:01  
PHOENIX, ARIZONA

Scale : 1" = 2000 feet



1. The above map depicts the SILVERSTONE 7 mining claim, which is located in Section (s) 2, Township 11 N, Range 1 W, Gila and Salt River Base and Meridian, YAVAPAI County, Arizona.

2. The type of corner and location monuments used are as follows: 2" P.V.C.

3. The bearings and distances in degrees and feet between claim corners are as depicted on the map.

Form MCF100a  
Revised July 2005

This form is available from the Arizona Department of Mines & Mineral Resources and may be reproduced.

RUN TIME: 02:48 PM

DEPARTMENT OF INTERIOR  
BUREAU OF LAND MANAGEMENT

RUN DATE: 09/22/2011  
Page 1 of 1

Input Parameters for Geographic Report with Land

System Id = CR

Admin State = AZ

Geo State =

Casetype Begins With

Case Disp Txt = AUTHORIZED, CANCELLED, EXPIRED, PENDING, REJECTED, RELINQUISHED, VOID, WITHDRAWN

Mer Twp Rng = 14 0110N 0010W

Section = 002, 999

Mtrs =

Commodity =

Commodity Txt =

Pending Org =

Pend Org Decode =

Total Rows Returned: 0

NO WARRANTY IS MADE BY BLM FOR USE OF THE DATA  
FOR PURPOSES NOT INTENDED BY BLM

PROTRACTION DIAGRAM NO 16 OFFICIALLY FILED 12/07/1959

YAVAPAI COUNTY  
HASSAYAMPA FIELD OFFICE

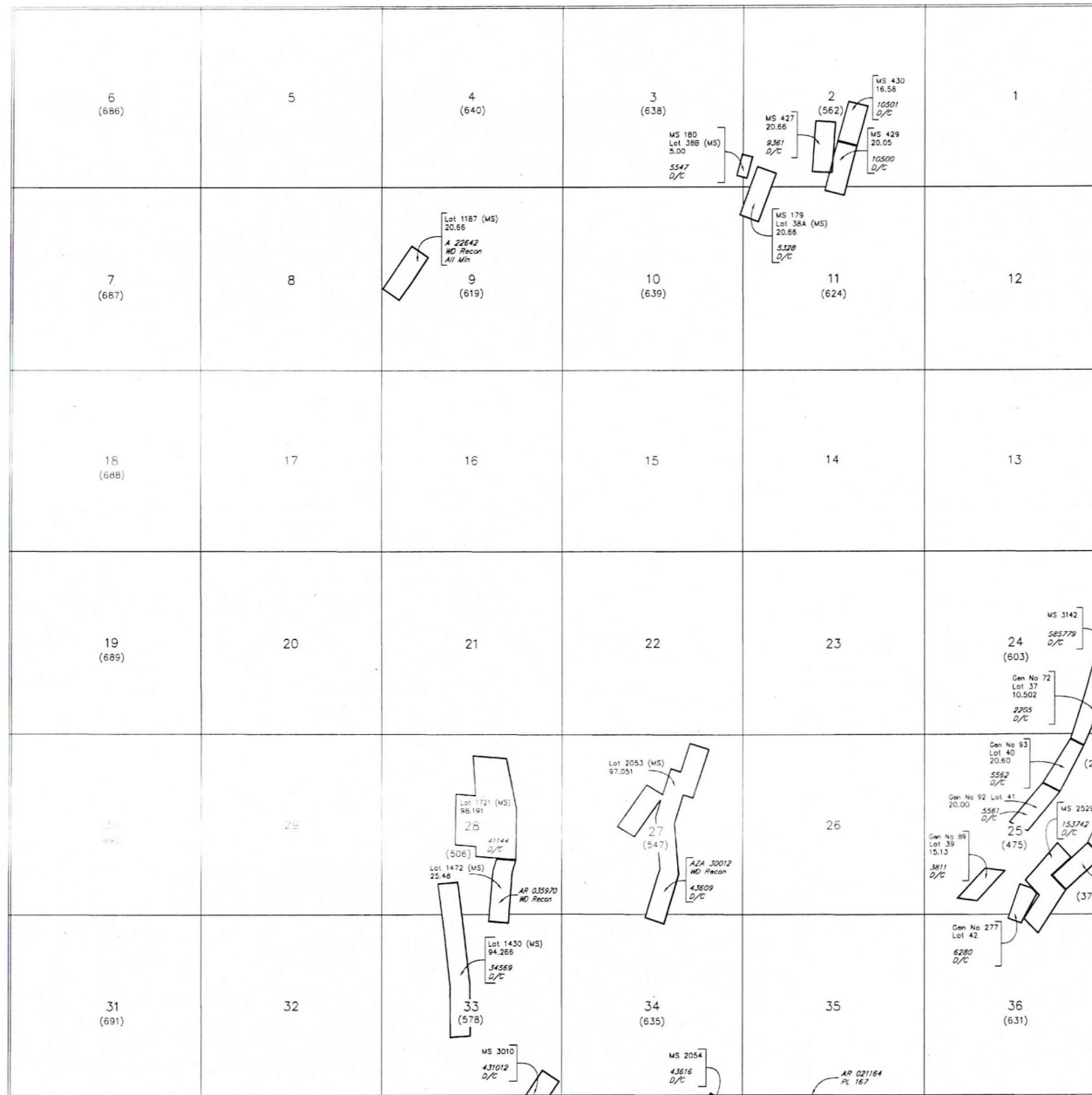
STATUS OF PUBLIC DOMAIN  
LAND AND MINERAL TITLES[illegible]

FOR ORDERS AFFECTING DISPOSAL OR USE OF  
UNIDENTIFIED LANDS WITHDRAWN FOR CLASSIFICATION,  
MINERALS, WATER AND/OR OTHER PUBLIC PURPOSES,  
REFER TO INDEX OF MISCELLANEOUS DOCUMENTS.

MDS 214 NE
215 NW
216 SW
217 SE

All Tp included in Wdl Prescott NF Proc 6 10/21/1899

NOTE - Mineral surveys MS 180, MS 427, MS 429, MS 430, MS 179, Lot 1721 (MS), Lot 1472 (MS) and Lot 1430 (MS) have been remapped using updated survey ties. The acreages in affected protracted sections have been estimated to reflect mineral survey relocations.

SCALE in chains

**WARNING STATEMENT**  
This plot is the Bureau's Record of Title, and should be used only as a graphic display of the township survey data. Records hereon do not reflect title changes which may have been effected by lateral movements of rivers or other bodies of water. Refer to the cadastral surveys for official survey information.

CURRENT TO	JK	GSR Mer
12-11-2008	ACAD	T 11 N
		R 1 W